

# Little Wave XP Offset Backrest

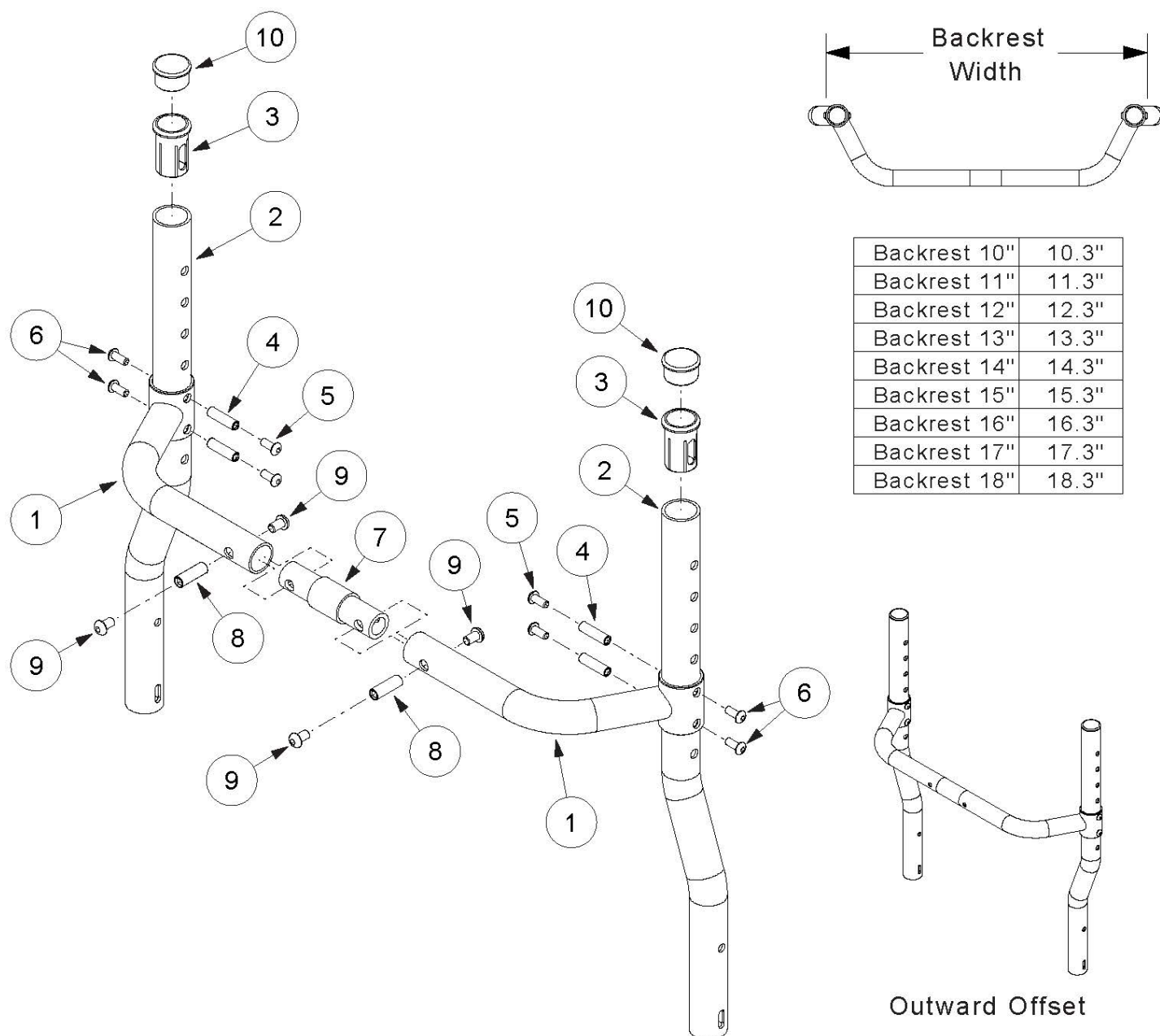

Item Number	Part Number	Description	Quantity
7b, 8, 9	502318	Backrest Connector Assembly 1" w/ Hardware, Rigid	1
7c, 8, 9	502319	Backrest Connector Assembly 2" w/ Hardware, Rigid	1
7d, 8, 9	502320	Backrest Connector Assembly 3" w/ Hardware, Rigid	1
1a, 7a, 8, 9	109150	Adjustable Height Rigidizer Bar 10", 0" Connector and Hardware <i>Used with 12" seat width and Inward Offset</i>	1
1b, 7a, 8, 9	109154	Adjustable Height Rigidizer Bar 11", 0" Connector and Hardware	1

Item Number	Part Number	Description	Quantity
		<i>Used with 13" seat width and Inward Offset</i>	
1c, 7a, 8, 9	109158	Adjustable Height Rigidizer Bar 12", 0" Connector and Hardware <i>Used with 14" seat width and Inward Offset or 10" seat width and Outward Offset</i>	1
1d, 7a, 8, 9	109162	Adjustable Height Rigidizer Bar 13", 0" Connector and Hardware <i>Used with 15" seat width and Inward Offset or 11" seat width and Outward Offset</i>	1
1e, 7a, 8, 9	109166	Adjustable Height Rigidizer Bar 14", 0" Connector and Hardware <i>Used with 16" seat width and Inward Offset or 12" seat width and Outward Offset</i>	1
1f, 7a, 8, 9	109170	Adjustable Height Rigidizer Bar 15", 0" Connector and Hardware <i>Used with 17" seat width and Inward Offset or 13" seat width and Outward Offset</i>	1
1g, 7a, 8, 9	109174	Adjustable Height Rigidizer Bar 16", 0" Connector and Hardware <i>Used with 18" seat width and Inward Offset or 14" seat width and Outward Offset</i>	1
1h, 7a, 8, 9	109422	Adjustable Height Rigidizer Bar 17", 0" Connector and Hardware <i>Used with 19" seat width and Inward Offset or 15" seat width and Outward Offset</i>	1
1i, 7a, 8, 9	109426	Adjustable Height Rigidizer Bar 18", 0" Connector and Hardware <i>Used with 16" seat width and Outward Offset</i>	1
1i, 7b, 8, 9	109427	Adjustable Height Rigidizer Bar 18", 1" Connector and Hardware <i>Used with 17" seat width and Outward Offset</i>	1
1i, 7c, 8, 9	109428	Adjustable Height Rigidizer Bar 18", 2" Connector and Hardware <i>Used with 18" seat width and Outward Offset</i>	1
1i, 7d, 8, 9	109429	Adjustable Height Rigidizer Bar 18", 3" Connector and Hardware <i>Used with 19" seat width and Outward Offset</i>	1
2a	109120	1" Offset Backtube, 10" <i>Used with 11" back height with omit push handles</i>	2
2b	109119	1" Offset Backtube, 11" <i>Used with 12" back height with omit push handles and 15" back height with fold down push handles</i>	2
2c	109118	1" Offset Backtube, 12" <i>Used with 13" back height with omit push handles, 16" back height with fold down push handles and 15" back height with standard or low profile push handles</i>	2
2d	109117	1" Offset Backtube, 13" <i>Used with 14" back height with omit push handles, 17" back height with fold down push handle and 16" back height with standard or low profile push handles</i>	2
2e	109116	1" Offset Backtube, 14" <i>Used with 15" back height with omit push handles and 17" back height with standard or low profile push handles</i>	2

Item Number	Part Number	Description	Quantity
2f	109115	1" Offset Backtube, 15" <i>Used with 16" back height with omit push handles</i>	2
2g	001312	1" Offset Backtube, 16" <i>Used with 17" back height with omit push handles</i>	2
3	000034	Sleeve 3/4" x 1 1/2" <i>Used with standard push handles, low profile push handles and fold down push handles</i>	2
4	000073	M5 x 24 Threaded Barrel	4
5	100669	M5 x 10 BTN SHCS BLKZC w/Patch	4
6	103524	M5 x 10 BTN SHCS BLK ZN	4
7a	000589	Backrest Connector 0" LW/RG	1
7b	000590	Backrest Connector 1" LW/RG	1
7c	000591	Backrest Connector 2" LW/RG	1
7d	000592	Backrest Connector 3" LW/RG	1
8	000669	M6 x 20.5 Threaded Barrel	2
9	101184	M6 x 10 BTN SHCS BLKZC w/Patch	4
10	100804	Tube End Plug 1" <i>Used with omit push handles</i>	4