

# Hanger Extension Tubes

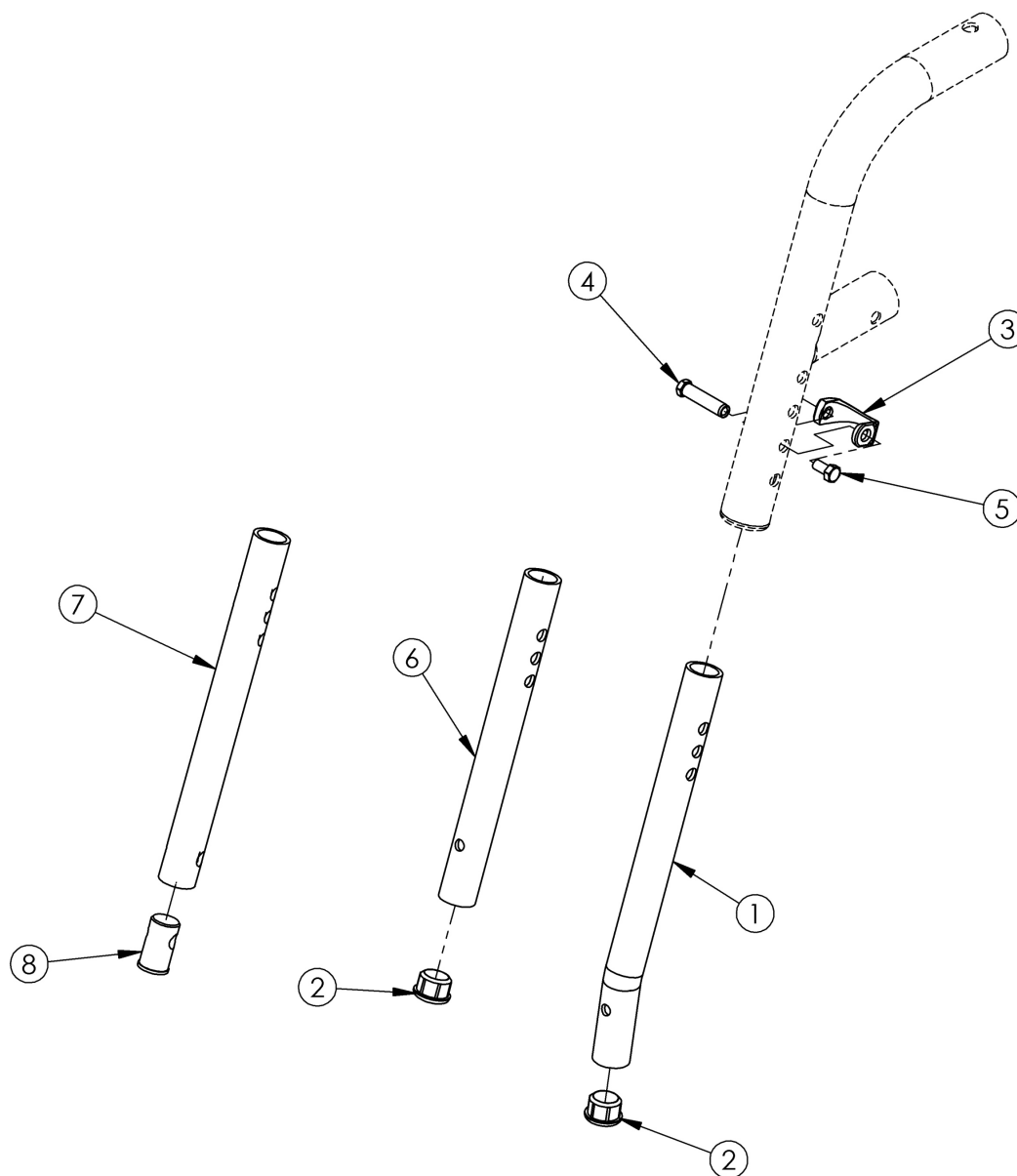

Composite  
Angle  
Adjustable  
Extension  
Tube  
Height

| Part No. | Length |
|----------|--------|
| 003111   | 9.1"   |
| 003112   | 11.2"  |
| 003113   | 13.6"  |

Straight  
Extension  
Tube  
Height

| Part No. | Length |
|----------|--------|
| 000340   | 8.5"   |
| 000341   | 10.7"  |
| 000342   | 13.0"  |

Bent  
Extension  
Tube  
Height

| Part No. | Length |
|----------|--------|
| 000039   | 8.5"   |
| 000040   | 10.6"  |
| 000041   | 13.0"  |

If hangers are being quoted/ordered in addition to extension tubes, fasteners (#3, #4, #5) are already included with the full hanger assemblies (Reference the 60,70,80,90 degree hanger pages).

| Item Number | Part Number | Description   | Quantity |
|-------------|-------------|---|----------|
| 6a          | 000340      | Hanger Extension Tube Straight Short<br><i>Use with 80° extension tube hangers or 80° fixed front frames with Composite footplates or Aluminum Angle Adjustable footplates.</i>             | 1        |
| 6b          | 000341      | Hanger Extension Tube Straight Medium<br><i>Use with 80° extension tube hangers or 80° fixed front frames with Composite footplates or Aluminum Angle Adjustable footplates.</i>            | 1        |
| 6c          | 000342      | Hanger Extension Tube Straight Long<br><i>Use with 80° extension tube hangers or 80° fixed front frames with Composite footplates or Aluminum Angle Adjustable footplates.</i>              | 1        |
| 6a, 2       | 502220      | Short Hanger Extension Tube Straight w/ Plug  | 1        |
| 6b, 2       | 502221      | Medium Hanger Extension Tube Straight w/ Plug   | 1        |
| 6c, 2       | 502222      | Long Hanger Extension Tube Straight w/ Plug   | 1        |
| 6a, 2 - 5   | 502226      | Short Hanger Extension Tube Straight w/ Plug and Fasteners  | 1        |
| 6b, 2 - 5   | 502227      | Medium Hanger Extension Tube Straight w/ Plug and Fasteners   | 1        |
| 6c, 2 - 5   | 502228      | Long Hanger Extension Tube Straight w/ Plug and Fasteners   | 1        |
| 1a          | 000039      | Hanger Extension Tube Bent Short<br><i>Use with 60° or 70° extension tube hangers or 70° fixed front frames with Composite footplates or Aluminum Angle Adjustable footplates.</i>          | 1        |
| 1b          | 000040      | Hanger Extension Tube Bent Medium<br><i>Use with 60° or 70° extension tube hangers or 70° fixed front frames with Composite footplates or Aluminum Angle Adjustable footplates.</i>         | 1        |
| 1c          | 000041      | Hanger Extension Tube Bent Long<br><i>Use with 60° or 70° extension tube hangers or 70° fixed front frames with Composite footplates or Aluminum Angle Adjustable footplates.</i>           | 1        |
| 1a, 2       | 502217      | Short Hanger Extension Tube Bent w/ Plug<br><i>Use with 60° or 70° extension tube hangers or 70° fixed front frames with Composite footplates or Aluminum Angle Adjustable footplates.</i>  | 1        |
| 1b, 2       | 502218      | Medium Hanger Extension Tube Bent w/ Plug<br><i>Use with 60° or 70° extension tube hangers or 70° fixed front frames with Composite footplates or Aluminum Angle Adjustable footplates.</i> | 1        |
| 1c, 2       | 502219      | Long Hanger Extension Tube Bent w/ Plug   | 1        |

| Item Number | Part Number | Description   | Quantity |
|-------------|-------------|---|----------|
|             |             | <i>Use with 60° or 70° extension tube hangers or 70° fixed front frames with Composite footplates or Aluminum Angle Adjustable footplates.</i>  |          |
| 1a, 2 - 5   | 502223      | Short Hanger Extension Tube Bent w/ Plug and Fasteners<br><i>Use with 60° or 70° extension tube hangers or 70° fixed front frames with Composite footplates or Aluminum Angle Adjustable footplates.</i>  | 1        |
| 1b, 2 - 5   | 502224      | Medium Hanger Extension Tube Bent w/ Plug and Fasteners<br><i>Use with 60° or 70° extension tube hangers or 70° fixed front frames with Composite footplates or Aluminum Angle Adjustable footplates.</i> | 1        |
| 1c, 2 - 5   | 502225      | Long Hanger Extension Tube Bent w/ Plug and Fasteners<br><i>Use with 60° or 70° extension tube hangers or 70° fixed front frames with Composite footplates or Aluminum Angle Adjustable footplates.</i>   | 1        |
| 7a          | 003111      | Hanger Extension Tube Composite Angle Adjustable Short<br><i>Use with Composite Angle Adjustable footplates.</i>  | 1        |
| 7b          | 003112      | Hanger Extension Tube Composite Angle Adjustable Medium<br><i>Use with Composite Angle Adjustable footplates.</i>   | 1        |
| 7c          | 003113      | Hanger Extension Tube Composite Angle Adjustable Long<br><i>Use with Composite Angle Adjustable footplates.</i>   | 1        |
| 7a, 8       | 503031      | Short Composite Angle Adjustable Extension Tube w/ Plug   | 1        |
| 7b, 8       | 503032      | Medium Composite Angle Adjustable Extension Tube w/ Plug  | 1        |
| 7c, 8       | 503033      | Long Composite Angle Adjustable Extension Tube w/ Plug  | 1        |
| 7a, 3-5, 8  | 503034      | Short Composite Angle Adjustable Extension Tube w/ Plug and Fasteners   | 1        |
| 7b, 3-5, 8  | 503035      | Medium Composite Angle Adjustable Extension Tube w/ Plug and Fasteners  | 1        |
| 7c, 3-5, 8  | 503036      | Long Composite Angle Adjustable Extension Tube w/ Plug and Fasteners  | 1        |
| 2           | 100638      | Tube End Plug 3/4"  | 1        |
| 3           | 000988      | Fastener Retainer   | 1        |
| 4           | 000987      | Threaded Fastener   | 1        |
| 5           | 200427      | M5 x 10 CLS8.8 HHCS ZC w/Patch DIN933   | 1        |
| 8           | 003161      | Footplate Plug for Composite Angle Adjustable Footplate Extension Tube  | 1        |

Distance between Point A and Point B  
B = Footplate Length

**NOTE:** The yardstick on the top plane of the seat frame must lie flat against frame. The yardstick going from the footplate to the second yardstick must be square against the hanger tube.

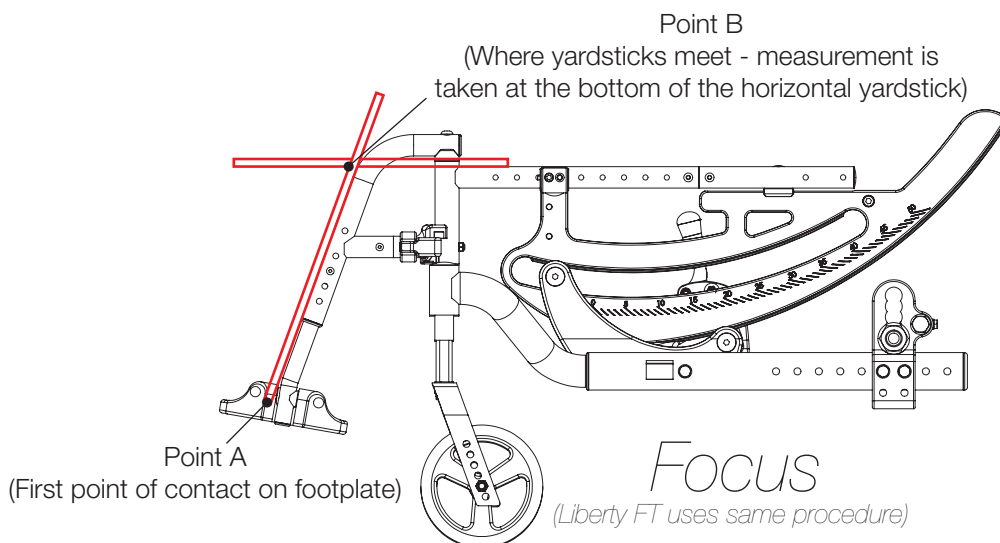

Distance between Point A and Point B  
B = Footplate Length

**NOTE:** The yardstick on the top plane of the seat frame must lie flat against frame. The yardstick going from the footplate to the second yardstick must be square against the front tube.



Distance between Point A and Point B  
B = Footplate Length

**NOTE:** The yardstick on the top plane of the hanger must lie flat against hanger. The yardstick going from the footplate to the second yardstick must be square against the hanger tube.

