

Focus CR Reclining Backrest

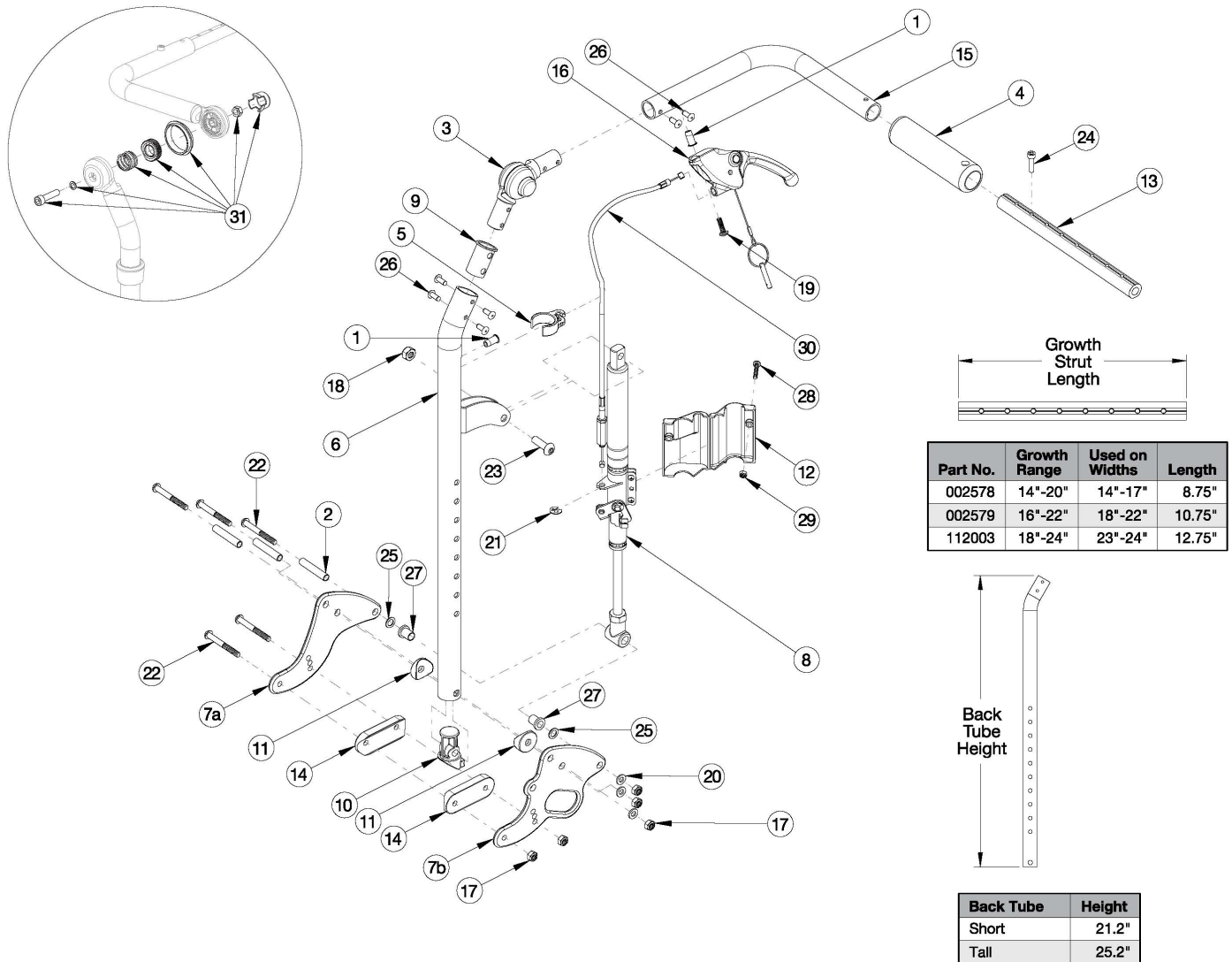

Part No.	Growth Range	Used on Widths	Length
002578	14"-20"	14"-17"	8.75"
002579	16"-22"	18"-22"	10.75"
112003	18"-24"	23"-24"	12.75"

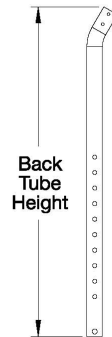

Back Tube	Height
Short	21.2"
Tall	25.2"

This design effective starting with serial numbers FCR0026599 and FCHD002333 <p>

If changing from another style backrest and the hand tilt is present, a new Hand Tilt Cable/Trigger Kit may be required. <p>

If retrofitting to a reclining backrest, and the configuration contains a foot tilt mechanism, a new foot tilt pedal kit is required.

Item Number	Part Number	Description	Quantity	Retail
1-5, 6a, 7a, 8a, 8b, 9-11, 12a, 12b, 13a, 14, 15a, 15b, 16-29, 30a	506764	Recline Back Kit, Short, 14-20" Width, Standard Gas Spring <i>Kit includes parts for both sides</i>	1	\$1,421.44
1-5, 6a, 7a, 8a, 8b, 9-11, 12a, 12b, 13b, 14, 15a, 15b, 16-29, 30a	506765	Recline Back Kit, Short, 16-22" Width, Standard Gas Spring <i>Kit includes parts for both sides</i>	1	\$1,426.46

Item Number	Part Number	Description	Quantity	Retail
1-5, 6a, 7a, 8a, 8b, 9-11, 12a, 12b, 13c, 14, 15a, 15b, 16-29, 30a	114290	Recline Back Kit, Short, 23-24" Width, Standard Gas Spring <i>Kit includes parts for both sides</i>	1	\$1,400.87
1-5, 6b, 7a, 8a, 8b, 9-11, 12a, 12b, 13a, 14, 15a, 15b, 16-29, 30b	506766	Recline Back Kit, Tall, 14-20" Width, Standard Gas Spring <i>Kit includes parts for both sides</i>	1	\$1,429.33
1-5, 6b, 7a, 8a, 8b, 9-11, 12a, 12b, 13b, 14, 15a, 15b, 16-29, 30b	506767	Recline Back Kit, Tall, 16-22" Width, Standard Gas Spring <i>Kit includes parts for both sides</i>	1	\$1,434.33
1-5, 6b, 7a, 8a, 8b, 9-11, 12a, 12b, 13c, 14, 15a, 15b, 16-29, 30b	114291	Recline Back Kit, Tall, 23-24" Width, Standard Gas Spring <i>Kit includes parts for both sides</i>	1	\$1,408.59
1-5, 6a, 7a, 8c, 8d, 9-11, 12a, 12b, 13a, 14, 15a, 15b, 16-29, 30a	506768	Recline Back Kit, Short, 14-20" Width, Heavy Duty Gas Spring <i>Kit includes parts for both sides</i>	1	\$1,421.44
1-5, 6a, 7a, 8c, 8d, 9-11, 12a, 12b, 13b, 14, 15a, 15b, 16-29, 30a	506769	Recline Back Kit, Short, 16-22" Width, Heavy Duty Gas Spring <i>Kit includes parts for both sides</i>	1	\$1,426.46
1-5, 6a, 7a, 8c, 8d, 9-11, 12a, 12b, 13c, 14, 15a, 15b, 16-29, 30a	114292	Recline Back Kit, Short, 23-24" Width, Heavy Duty Gas Spring <i>Kit includes parts for both sides</i>	1	\$1,400.87
1-5, 6b, 7a, 8c, 8d, 9-11, 12a, 12b, 13a, 14, 15a, 15b, 16-29, 30b	506770	Recline Back Kit, Tall, 14-20" Width, Heavy Duty Gas Spring <i>Kit includes parts for both sides</i>	1	\$1,429.33
1-5, 6b, 7a, 8c, 8d, 9-11, 12a, 12b, 13b, 14, 15a, 15b, 16-29, 30b	506771	Recline Back Kit, Tall, 16-22" Width, Heavy Duty Gas Spring <i>Kit includes parts for both sides</i>	1	\$1,434.33
1-5, 6b, 7a, 8c, 8d, 9-11, 12a, 12b, 13c, 14, 15a, 15b, 16-29, 30b	114293	Recline Back Kit, Tall, 23-24" Width, Heavy Duty Gas Spring <i>Kit includes parts for both sides</i>	1	\$1,408.59

Item Number	Part Number	Description	Quantity	Retail
1-5, 6a, 7b, 8a, 8b, 9-11, 12a, 12b, 13a, 14, 15a, 15b, 16-29, 30a	506772	Recline Back Kit, Short, 14-20" Width, Standard Gas Spring, Transit <i>Kit includes parts for both sides</i>	1	\$1,442.68
1-5, 6a, 7b, 8a, 8b, 9-11, 12a, 12b, 13b, 14, 15a, 15b, 16-29, 30a	506773	Recline Back Kit, Short, 16-22" Width, Standard Gas Spring, Transit <i>Kit includes parts for both sides</i>	1	\$1,447.70
1-5, 6a, 7b, 8a, 8b, 9-11, 12a, 12b, 13c, 14, 15a, 15b, 16-29, 30a	114294	Recline Back Kit, Short, 23-24" Width, Standard Gas Spring, Transit <i>Kit includes parts for both sides</i>	1	\$1,421.69
1-5, 6b, 7b, 8a, 8b, 9-11, 12a, 12b, 13a, 14, 15a, 15b, 16-29, 30b	506774	Recline Back Kit, Tall, 14-20" Width, Standard Gas Spring, Transit <i>Kit includes parts for both sides</i>	1	\$1,450.55
1-5, 6b, 7b, 8a, 8b, 9-11, 12a, 12b, 13b, 14, 15a, 15b, 16-29, 30b	506775	Recline Back Kit, Tall, 16-22" Width, Standard Gas Spring, Transit <i>Kit includes parts for both sides</i>	1	\$1,455.57
1-5, 6b, 7b, 8a, 8b, 9-11, 12a, 12b, 13c, 14, 15a, 15b, 16-29, 30b	114295	Recline Back Kit, Tall, 23-24" Width, Standard Gas Spring, Transit <i>Kit includes parts for both sides</i>	1	\$1,429.41
1-5, 6a, 7b, 8c, 8d, 9-11, 12a, 12b, 13a, 14, 15a, 15b, 16-29, 30a	506776	Recline Back Kit, Short, 14-20" Width, Heavy Duty Gas Spring, Transit <i>Kit includes parts for both sides</i>	1	\$1,442.68
1-5, 6a, 7b, 8c, 8d, 9-11, 12a, 12b, 13b, 14, 15a, 15b, 16-29, 30a	506777	Recline Back Kit, Short, 16-22" Width, Heavy Duty Gas Spring, Transit <i>Kit includes parts for both sides</i>	1	\$1,447.70
1-5, 6a, 7b, 8c, 8d, 9-11, 12a, 12b, 13c, 14, 15a, 15b, 16-29, 30a	114296	Recline Back Kit, Short, 23-24" Width, Heavy Duty Gas Spring, Transit <i>Kit includes parts for both sides</i>	1	\$1,421.69
1-5, 6b, 7b, 8c, 8d, 9-11, 12a, 12b, 13a, 14, 15a, 15b, 16-29, 30b	506778	Recline Back Kit, Tall, 14-20" Width, Heavy Duty Gas Spring, Transit <i>Kit includes parts for both sides</i>	1	\$1,450.55

Item Number	Part Number	Description	Quantity	Retail
1-5, 6b, 7b, 8c, 8d, 9-11, 12a, 12b, 13b, 14, 15a, 15b, 16-29, 30b	506779	Recline Back Kit, Tall, 16-22" Width, Heavy Duty Gas Spring, Transit <i>Kit includes parts for both sides</i>	1	\$1,455.57
1-5, 6b, 7b, 8c, 8d, 9-11, 12a, 12b, 13c, 14, 15a, 15b, 16-29, 30b	114297	Recline Back Kit, Tall, 23-24" Width, Heavy Duty Gas Spring, Transit <i>Kit includes parts for both sides</i>	1	\$1,429.41
1, 3, 4, 6a, 9, 15a, 26	506760	Recline Back Tube Subassembly, Short, Right	1	\$270.31
1, 3, 4, 6a, 9, 15b, 26	506761	Recline Back Tube Subassembly, Short, Left	1	\$270.31
1, 3, 4, 6b, 9, 15a, 26	506762	Recline Back Tube Subassembly, Tall, Right	1	\$272.82
1, 3, 4, 6b, 9, 15b, 26	506763	Recline Back Tube Subassembly, Tall, Left	1	\$272.82
2, 7a, 11, 14, 17, 20, 22, 25, 27	505857	Reclining Backrest Hardware Assembly (One Side), Std Focus	1	\$174.68
2, 7b, 11, 14, 17, 20, 22, 25, 27	505858	Reclining Backrest Hardware Assembly (One Side), Transit Focus	1	\$358.49
2	001075	Stop Pin Backrest Tilt	3	\$6.74
5	001117	Cable Clip 1"	1	\$3.83
7a	001262	Back Plate, Recline Tilt <i>Quantity of 4 used with non-transit. Quantity of 2 used with transit.</i>	2	\$62.54
7b	001263	Back Plate, Recline, Transit Tilt <i>Quantity of 2 used with transit.</i>	2	\$154.44
8a	001264	Gas Spring Lock 92mm 20kg, Left (Standard Weight Capacity)	1	\$152.19
8b	001265	Gas Spring Lock 92mm 20kg, Right (Standard Weight Capacity)	1	\$152.19
8c	001375	Gas Spring Lock 92mm 40kg, Left (Heavy Duty)	1	\$152.19
8d	001376	Gas Spring Lock 92mm 40kg, Right (Heavy Duty)	1	\$152.19
10	001267	Plug, Back Tube, Lower, Recline	1	\$2.20
11	001271	1" Saddle, .323 Hole	2	\$1.62
12a	001298	Cover, Gas Spring, Left	1	\$3.97
12b	001299	Cover, Gas Spring, Right	1	\$3.97
13a	002578	Growth Strut, Stroller, Short <i>Used on chairs 14"-17" wide</i>	1	\$25.72

Item Number	Part Number	Description	Quantity	Retail
13b	002579	Growth Strut, Stroller, Long <i>Used on chairs 18"-22" wide</i>	1	\$28.14
13c	112003	Growth Strut, Stroller, Extra Long <i>Used on chairs 23"-24" wide</i>	1	\$30.52
14	002594	Saddle, Dual, 1" OD X 1.75 SP	2	\$3.06
16	003492	Lever Assembly, Straight	1	\$24.95
17	100658	M6 Nylock Nut Blk Zn	5	\$1.05
18	100659	M8 Nylock Nut Blk Zn	1	\$1.05
19	100734	M5 x 16 PHMS ZC	1	\$1.58
20	100746	M6 Flat Washer Blk Zn	3	\$1.58
21	101076	1/4" E Ring	1	\$1.58
22	101781	M6 x 50mm Partial Thread BHCS Blk ZC	5	\$1.58
23	101814	M8 x 25 BHCS Blk Zn	1	\$1.05
24	101843	M5 x 20 SHCS Blk Zn	1	\$0.53
25	101861	Nylon Washer 5/16 x 1/2 x .03	2	\$0.53
27	102081	Bushing Flange .319 IDx.394 OD	2	\$0.56
28	102328	M4 x 25 Pan Head Phil Blk Zn	1	\$1.05
29	102329	M4 Nylock Nut Blk Zn	1	\$1.05
30a	004551	Cable, Recline, Short Tilt	1	\$90.25
30b	004552	Cable, Recline, Tall Tilt	1	\$91.69
31	110524	Locking Hinge Button Assembly with Instruction <i>This kit contains the contents inside callout # 3. This assembly may not be compatible if chair was invoiced prior to 6/22/16</i>	1	\$36.72