

# 1.5" Auto Buckle Pelvic Positioning Belt

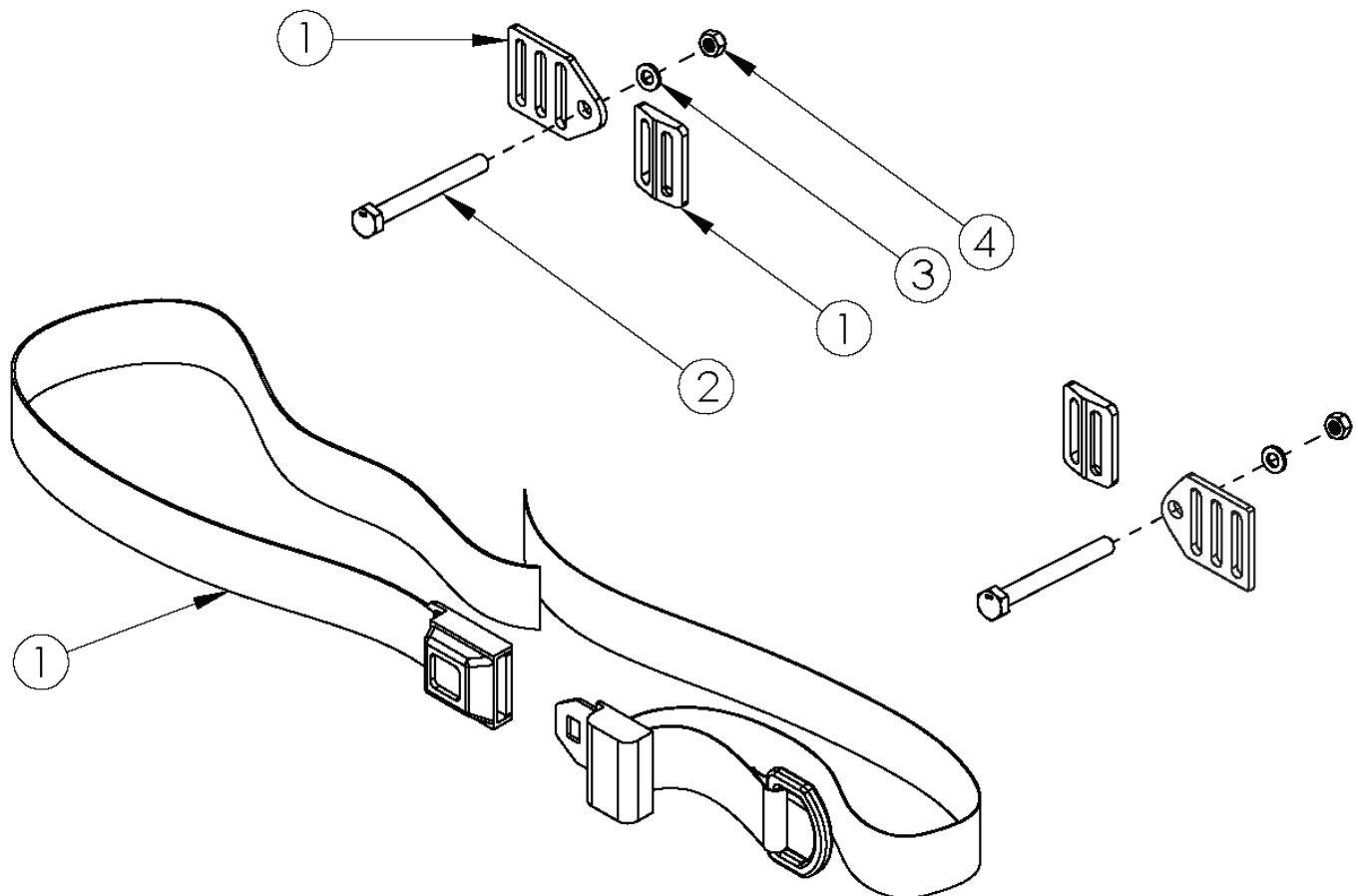

Item Number	Part Number	Description	Quantity
1a, 2c, 3, 4	100595	Belt Pelvic Positioning 1.5" Auto Buckle 56" <i>Used with seat widths up to 18" and standard weight capacity</i>	1
1a, 2e, 3, 4	111390	Belt Pelvic Positioning 1.5" Auto Buckle 56", Flip/Liberty <i>Used with seat widths up to 20"</i>	1
1b, 2a, 3, 4	111391	Belt Pelvic Positioning 1.5" Auto Buckle 60", Catalyst/Spark <i>Used with 21"-22" seat widths and all heavy duty</i>	1
1b, 2b, 3, 4	111392	Belt Pelvic Positioning 1.5" Auto Buckle 60", Focus <i>Used with 21"-24" seat widths</i>	1
1b, 2c, 3, 4	111393	Belt Pelvic Positioning 1.5" Auto Buckle 60", RG ALX/Rogue/LW XP <i>Used with 19"-22" seat widths and all heavy duty</i>	1
1b, 2d, 3, 4	111394	Belt Pelvic Positioning 1.5" Auto Buckle 60", Clik/Ethos <i>Used with seat widths 19" or greater</i>	1

Item Number	Part Number	Description	Quantity
1b, 2e, 3, 4	111395	Belt Pelvic Positioning 1.5" Auto Buckle 60", Flip/Liberty <i>Used with 21"-22" seat widths</i>	1
1b	100847	Belt Pelvic Positioning 1.5" Auto Buckle 60"	1
2a	100681	M6 x 40 CLS8.8 DIN931 HHCS ZC <i>Used on Catalyst and Spark</i>	2
2b	101125	M6 x 55 BTN SHCS BLKZC <i>Used on Focus</i>	2
2c	101781	M6 x 50mm Partial Thread BHCS Blk ZC <i>Used on Tsunami, Rogue and Rogue XP</i>	2
2d	100670	M6 x 45 BTN SHCS BLK ZC <i>Used on Klik and Ethos</i>	2
2e	101811	M6 x 35 BHCS Blk Zn <i>Used on Flip and Liberty</i>	2
3	100746	M6 Flat Washer Blk Zn	2
4	100658	M6 Nylock Nut Blk Zn	2