



# Q500 M SUSPENSION SPRING INSTRUCTION SHEET



Please read these instructions carefully before beginning the installation. Failure to understand and follow installation instructions may result in injury to installer and/or end user and may void the warranty. If you have any questions call Sunrise Medical Technical Support at (800) 333-4000.

NOTE- Some parts are not shown in the drawings for clarity.

## A. PRE-INSTALLATION 1 2

### 1. Remove spring:

- Using the 16mm socket wrench, remove drive wheels (A). Set wheels and lug nuts (B) aside, Fig 1.
- Use the 18mm crescent wrench to remove bolt (C) from the bottom of performance spring (G), use the 10mm crescent wrench to remove bolt (D), use the 6mm hex key to remove the screws (E), Fig 2. Discard hardware. Note- your chair may or may not have transit bracket (F).
- Remove spring and discard.

## B. INSTALLING NEW SUSPENSION SPRING 2 3

### 1. Assembly of suspension spring:

- Attach the new spring to the mounting holes. Note- Ensure that the bushing end is up, Fig 3.
- Install new bolts (C, D, and E) into spring, use washers and spacers as shown in Fig. 2. Tighten M8 screw (E) to 10-12ft-lbs (13.6-16.3Nm), tighten M6 bolt (D) to 7-9ft-lbs (9.5-12.2Nm), and M12 bolt (C) to 22-24ft-lbs (29.8-32.5Nm).
- Repeat all steps on the opposite side.
- Replace drive wheels, torque lug nuts to 25 ft-lbs +2/-0 (33.9Nm).



## C. INSPECT

- Suspension spring is oriented in the correct direction.
- All hardware has the correct torque.

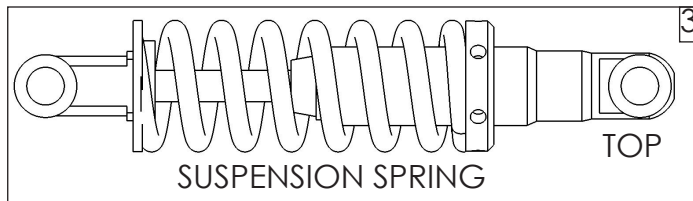

### Performance spring kit (two kits required):

- 1 ea Front shock (spring)
- 2 ea M8 x 1.25 x 35 bolts
- 1 ea Nylock nut

### Tools needed for assembly:

1. 6mm hex key
2. Torque wrench
3. 10mm crescent wrench
4. 18mm crescent wrench
5. 16mm socket wrench

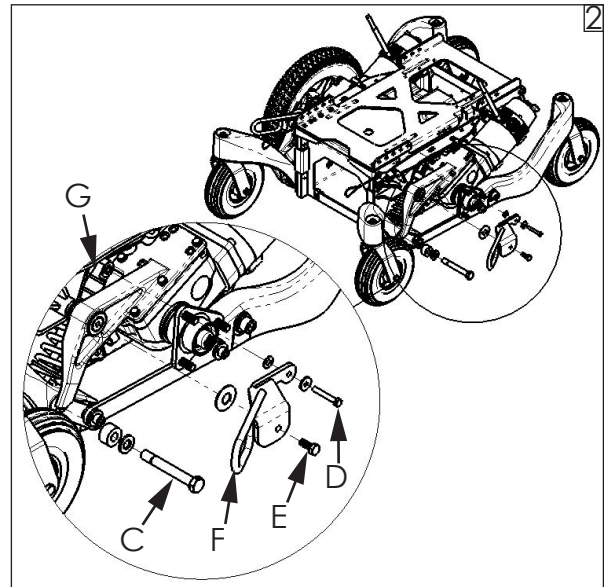
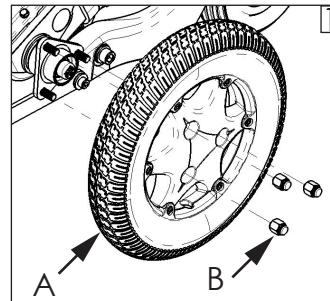

## ⚠ DEALER/TECHNICIAN WARNING

Attention dealers and qualified technicians, do not operate or service this device without first reading the owners manual. If you do not understand the instructions and warnings in the owners manual please contact the Quickie Technical Service Department before operating and/or servicing the Quickie device. Failure to do so may result in damage and/or injury.

Find more information and important warnings see the wheelchair owner's manual or at: [www.Sunrisemedical.com](http://www.Sunrisemedical.com).

Sunrise Medical 2842 N. Business Park Ave Fresno, CA 93727 USA  
In Canada (800) 263-3390



Customer service: (800) 333-4000  
or visit [www.SunriseMedical.com](http://www.SunriseMedical.com)

© 2019 Sunrise Medical (US) LLC  
9/13 248758 Rev. B