

# CR45 Adjustable Height Rigidizer Bar

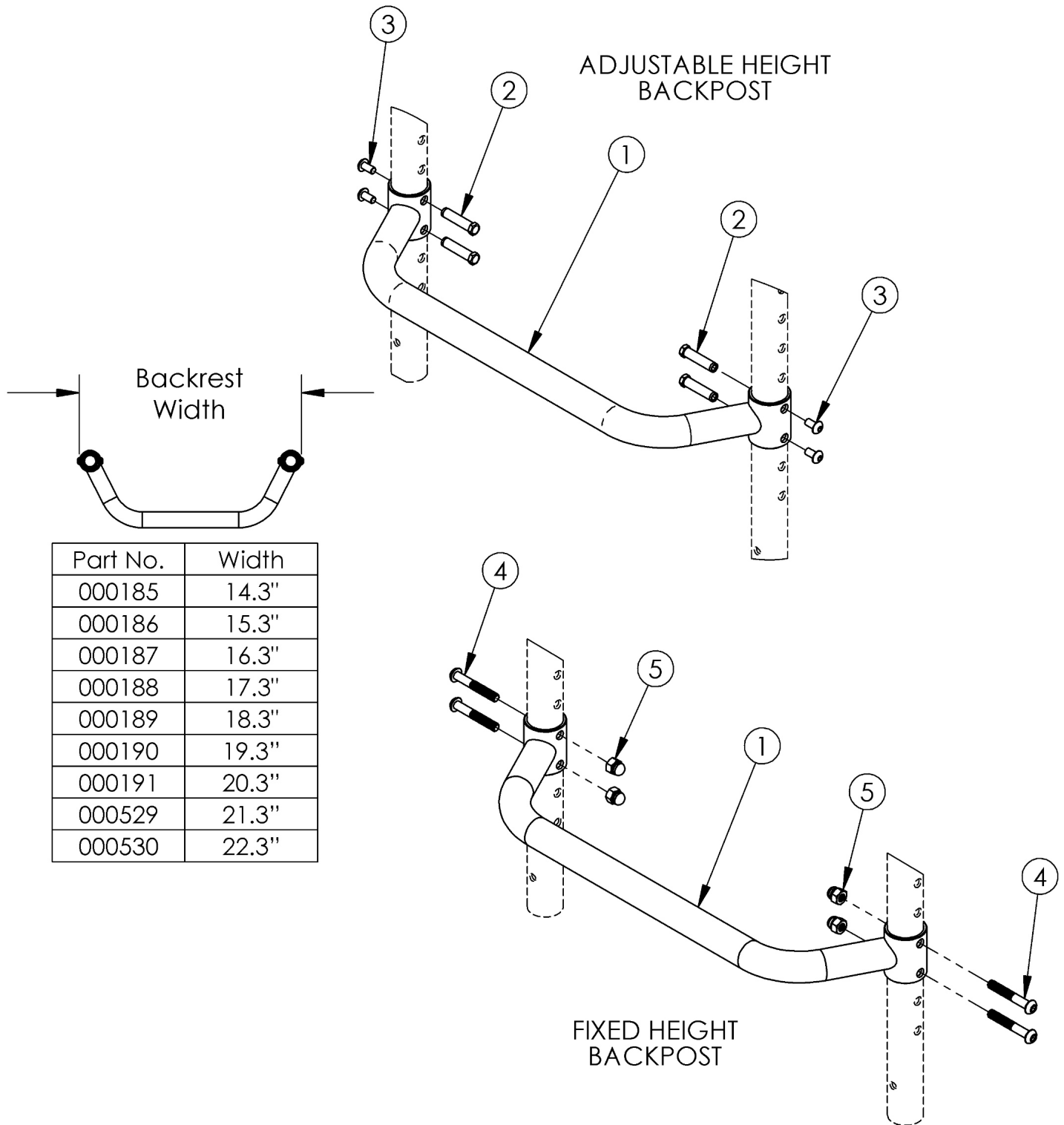

Adjustable Height Rigidizer Bar based on seat width

| Item Number | Part Number | Description                              | Quantity |
|-------------|-------------|--|----------|
| 1a          | 000185      | Adjustable Height Rigidizer Bar 14" Wide | 1        |
| 1b          | 000186      | Adjustable Height Rigidizer Bar 15" Wide | 1        |
| 1c          | 000187      | Adjustable Height Rigidizer Bar 16" Wide | 1        |
| 1d          | 000188      | Adjustable Height Rigidizer Bar 17" Wide | 1        |
| 1e          | 000189      | Adjustable Height Rigidizer Bar 18" Wide | 1        |
| 1f          | 000190      | Adjustable Height Rigidizer Bar 19" Wide | 1        |
| 1g          | 000191      | Adjustable Height Rigidizer Bar 20" Wide | 1        |
| 1h          | 000529      | Adjustable Height Rigidizer Bar 21"      | 1        |
| 1i          | 000530      | Adjustable Height Rigidizer Bar 22"      | 1        |
| 2           | 000987      | Threaded Fastener                        | 4        |
| 3           | 100669      | M5 x 10 BTN SHCS BLKZC w/Patch           | 4        |
| 4           | 100797      | M6 x 40 BHCS BLK ZC                      | 4        |
| 5           | 100558      | M6 Nyl Ins Domed Cap L/N Zc              | 4        |