

CR45 Adjustable Height Rigidizer Bar Growth

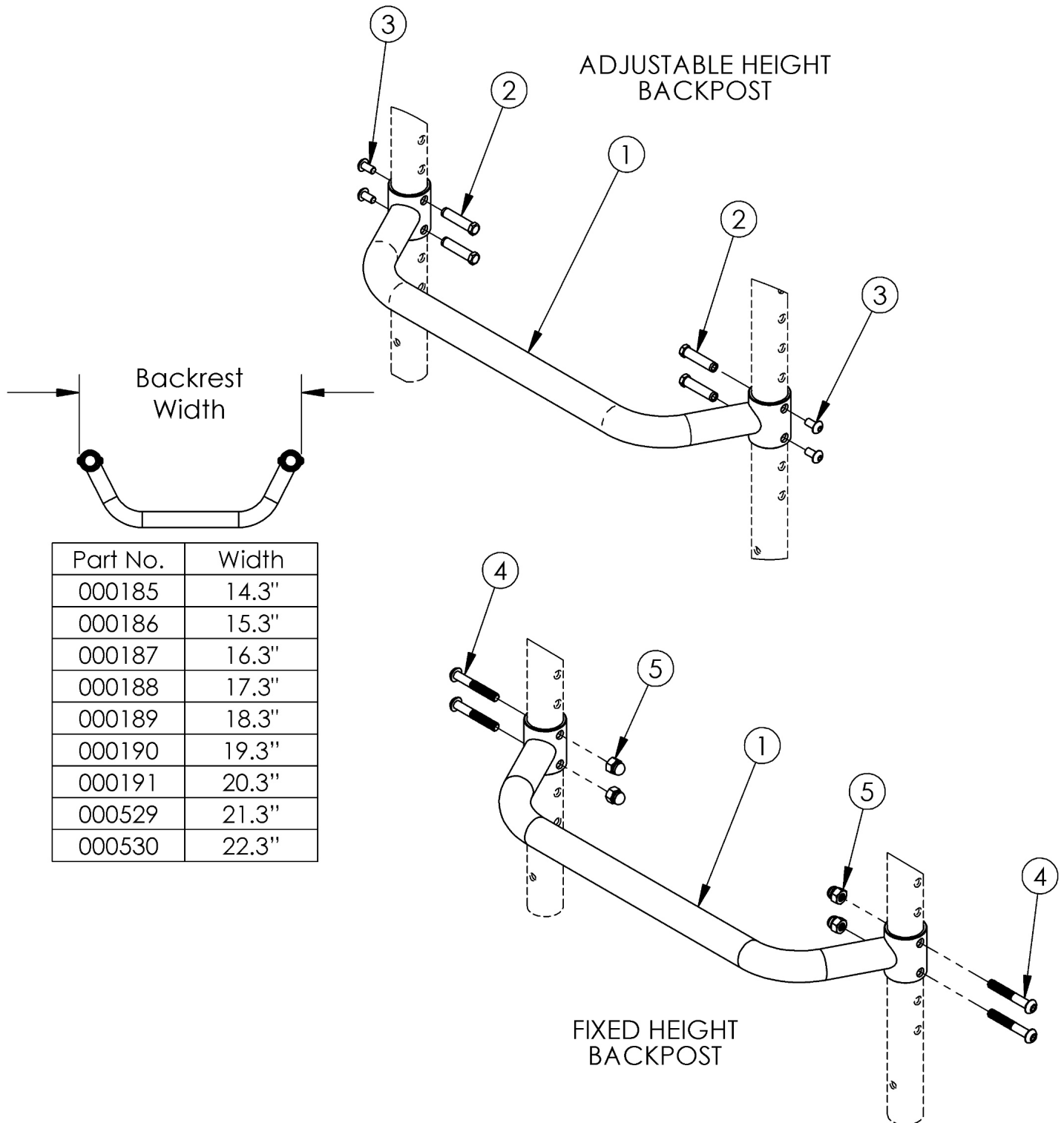

Has your width changed? If yes, please select accordingly.

| Item Number | Part Number | Description | Quantity |
|-------------|-------------|--|----------|
| 1a | 000185 | Adjustable Height Rigidizer Bar 14" Wide | 1 |
| 1b | 000186 | Adjustable Height Rigidizer Bar 15" Wide | 1 |
| 1c | 000187 | Adjustable Height Rigidizer Bar 16" Wide | 1 |
| 1d | 000188 | Adjustable Height Rigidizer Bar 17" Wide | 1 |
| 1e | 000189 | Adjustable Height Rigidizer Bar 18" Wide | 1 |
| 1f | 000190 | Adjustable Height Rigidizer Bar 19" Wide | 1 |
| 1g | 000191 | Adjustable Height Rigidizer Bar 20" Wide | 1 |
| 1h | 000529 | Adjustable Height Rigidizer Bar 21" | 1 |
| 1i | 000530 | Adjustable Height Rigidizer Bar 22" | 1 |
| 2 | 000987 | Threaded Fastener | 4 |
| 3 | 100669 | M5 x 10 BTN SHCS BLKZC w/Patch | 4 |
| 4 | 100797 | M6 x 40 BHCS BLK ZC | 4 |
| 5 | 100558 | M6 NYL INS Domed Cap L/N ZC | 4 |