

Clik / Rogue XP Height Adjustable Back Post

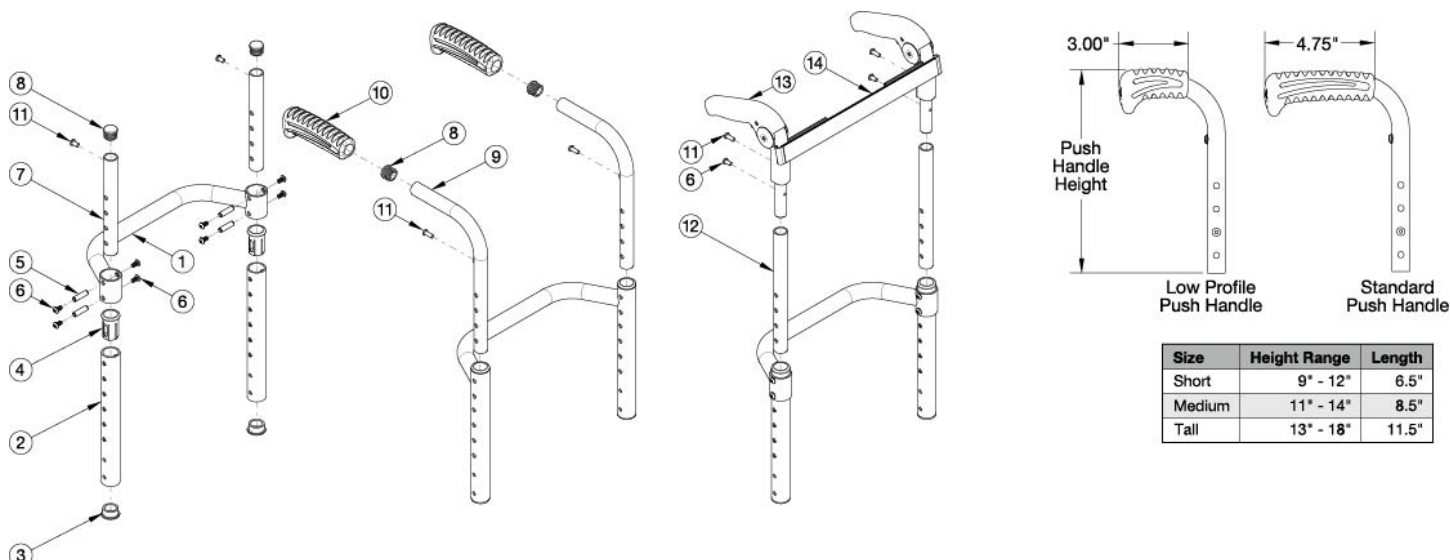

For item 1, see Little Wave Clik Adjustable Height Rigidizer Bar page or Rogue XP Adjustable Height Rigidizer Bar page. If changing from another style backrest and the Drum Brake is present, a new Drum Brake Cable Kit may be required

Item Number	Part Number	Description	Quantity
6, 12a, 11, 13	502609	Fold Down Push Handle Assembly for Height Adj Back Short, Clik/Rogue XP <i>Used with Short back height range. Includes both 11a and 11b</i>	1
6, 12b, 11, 13	502610	Fold Down Push Handle Assembly for Height Adj Back Tall, Clik/Rogue XP <i>Used with Medium and Tall back height ranges. Includes 11a and 11b</i>	1
8, 9a, 10a	502602	Standard Push Handle Assembly, Short <i>Used with Extra Short and Short back height ranges and drum brake is not present</i>	1
8, 9b, 10a	110582	Standard Push Handle Assembly Tall <i>Used with Medium and Tall back height ranges and drum brake is not present</i>	1
8, 9e, 10a	113221	Backtube w/ Push Handle Short with Backcane Extension, Drum Brake, Rigid <i>Used with Extra Short and Short back height ranges and drum brake is present. To view the backcane extension included in this kit, see the Rogue XP / Clik / Little Wave XP Drum Brake page.</i>	1
8, 9f, 10a	113222	Backtube w/ Push Handle Tall with Backcane Extension, Drum Brake, Rigid <i>Used with Medium and Tall back height ranges and drum brake is present. To view the backcane extension included in this kit, see the Rogue XP / Clik / Little Wave XP Drum Brake page.</i>	1
8, 9c, 10b	002758	Low Profile Push Handle Short Rigid <i>Used with Extra Short and Short back height ranges</i>	1

Item Number	Part Number	Description	Quantity
8, 9d, 10b	110583	Low Profile Push Handle Assembly Tall <i>Used with Medium and Tall back height ranges</i>	1
2a, 3, 4	502604	Height Adjustable Back Post 6.5" with Tube End Plug and Sleeve <i>Used with Extra Short back height range with omit push handles, standard push handles and low profile push handles or used with Short back height range with fold down push handles</i>	1
2b, 3, 4	110581	Height Adjustable Back Post 7.5" with Tube End Plug and Sleeve <i>Used with Medium back height range with fold down push handles</i>	1
2c, 3, 4	502605	Height Adjustable Back Post 8.5" with Tube End Plug and Sleeve <i>Used with Short back height range with omit push handles, standard push handles and low profile push handles or used with tall back height range with fold down push handles</i>	1
2d, 3, 4	502606	Height Adjustable Back Post 10.5" with Tube End Plug and Sleeve <i>Used with Medium and Tall back height ranges with omit push handles, standard push handles and low profile push handles</i>	1
3	100804	Tube End Plug 1"	2
4	000034	Sleeve 3/4" x 1 1/2"	2
5	000073	M5 x 24 Threaded Barrel	4
6	103524	M5 x 10 BTN SHCS BLK ZN	8
7a, 8	502608	Straight Upper Back Tube 6.25" with Tube End Plug <i>Used with Extra Short and Short back height ranges</i>	1
7b, 8	107209	Straight Upper Back Tube 9.5" with Tube End Plug <i>Used with Medium and Tall back height ranges</i>	1
8	100638	Tube End Plug 3/4"	2
10a	109432	Ergo Push Handle Grip 3/4" Standard with Instruction	1
10b	109430	Ergo Push Handle Grip 3/4" Low Profile with Instruction	1
11a	100734	M5 x 16 PHMS ZC <i>Used to mount Fold Down Push Handle</i>	2
11b	101843	M5 x 20 SHCS Blk Zn <i>Used to attach upholstery</i>	2
13	001735	Folding Handle Assembly Rigid <i>This is to replace an existing Fold Down Push Handle. If wanting to retrofit to the Fold Down Push Handle, order one of the following complete assemblies based on back height range: 502609 or 502610. Includes 100734 and 101843/</i>	1
14a	001748	Tension Strap Folding Handle 9-11 Wide	1

Item Number	Part Number	Description	Quantity
14b	001749	Tension Strap Folding Handle 12-13 Wide	1
14c	001750	Tension Strap Folding Handle 14-15 Wide	1
14d	001751	Tension Strap Folding Handle 16-17 Wide	1
14e	001752	Tension Strap Folding Handle 18-19 Wide	1