



Please read these instructions carefully before beginning the installation. Failure to understand and follow installation instructions may result in injury to installer and/or end user and may void the warranty. If you have any questions call Sunrise Medical Technical Support at (800) 333-4000.

Parts:

1. 2 ea armrest link (A)
2. 4 ea retaining clip (B)
3. 1 ea threaded spindle (C)
4. 1 ea M6x10 SHCS (D)
5. 2 ea brass spacer (E)
6. 1 ea washer (F)
7. 2 ea Phillips head screw (G)
8. 1 ea right-hand shroud (H)

Required tools:

1. 5mm hex key
2. Phillips screwdriver
3. Torque wrench

**With Armrest-
See Sections A-C**

**Without Armrest-
See Sections D-E**

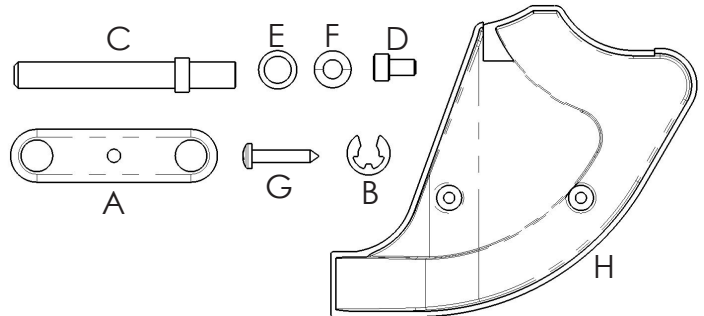

A. With armrest: installing armrest link

1. Unfold the backrest, and raise the armrest in order to install the armrest link (A) with the bushing facing toward the pins as shown in figure 1.
2. Install the retaining clips (B) onto the pins as shown in figure 2 and 3.

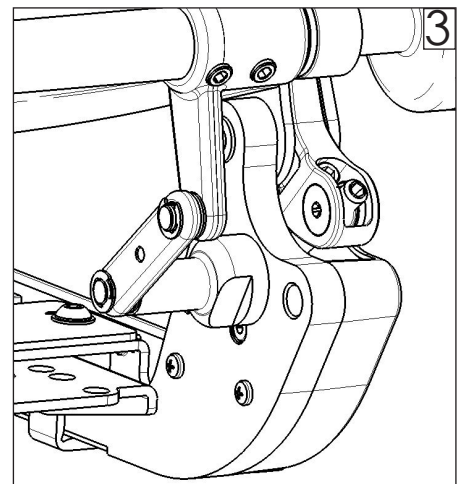
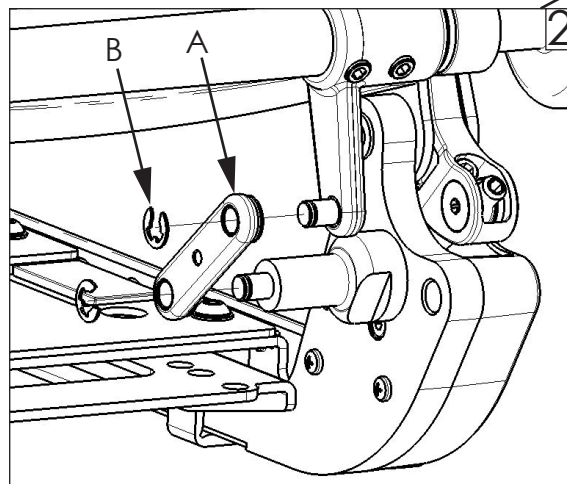
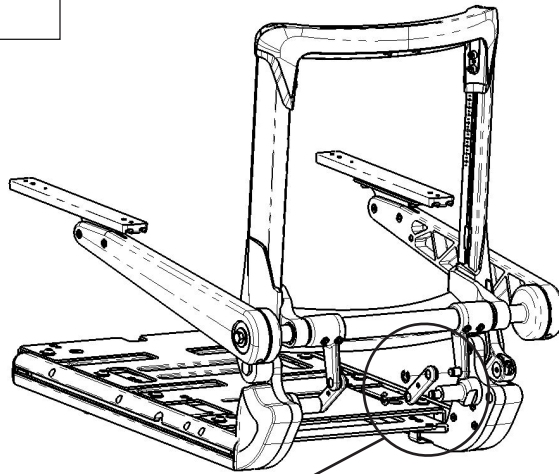
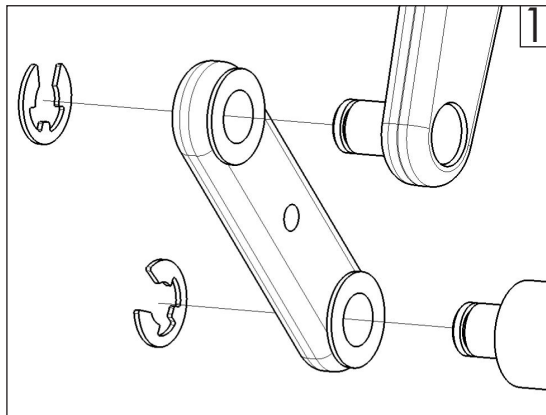

Sunrise Medical 2842 N. Business Park Ave Fresno, CA 93727 USA
In Canada (800) 263-3390



Please read these instructions carefully before beginning the installation. Failure to understand and follow installation instructions may result in injury to installer and/or end user and may void the warranty. If you have any questions call Sunrise Medical Technical Support at (800) 333-4000.

B. Installing Backrest locking hardware (with armrests)

Note: items notated in parentheses are for reference.

1. Using a 5mm hex key, install the threaded spindle (C) and one of the brass spacers (E) through the (J) and (K) as shown in figure 4.

2. Using a 5mm hex key, install the last brass spacer (E), the washer (F), and the M6 SHCS (D) into the threaded spindle (C) as shown in figure 4. Using the torque wrench torque the M6 SHCS to 1.8 ft-lbs (2.5Nm).



3. Using a Phillips head screwdriver, install the Phillips head screws (G) and the right-hand shroud (H), as shown in figure 5. Using a torque wrench, torque the Phillips head screw to 2.2 ft-lbs (3.0Nm).



C. Inspect

1. Inspect to verify all torque specifications are met.
2. Verify that back angle adjustment functions properly, by adjusting the threaded spindle (C) with a 5mm hex key.
3. Verify the armrest recline up and then back down again.

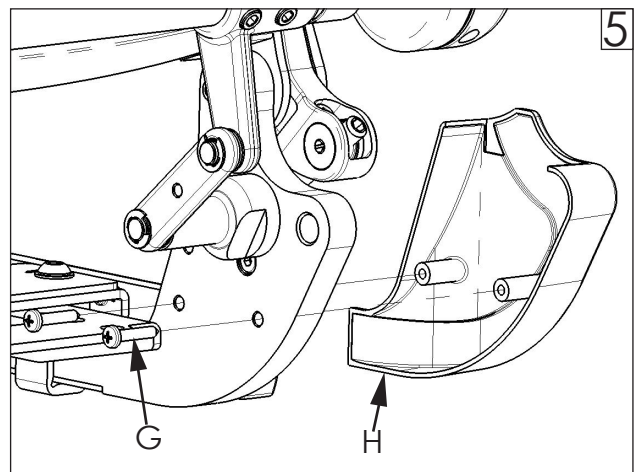
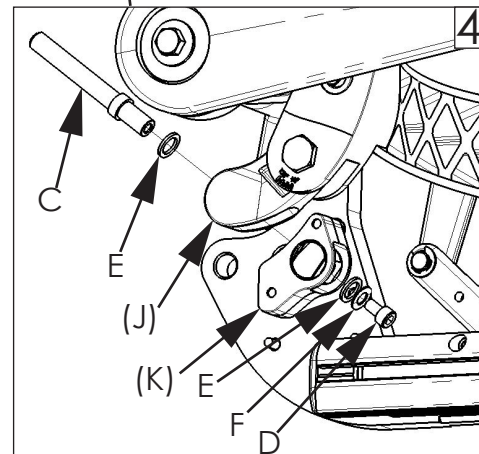
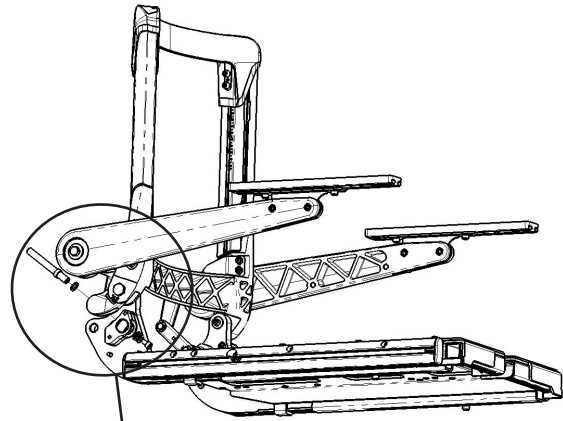

⚠️ DEALER/TECHNICIAN WARNING

Attention dealers and qualified technicians, do not operate or service this device without first reading the owners manual. If you do not understand the instructions and warnings in the owners manual please contact the Quickie Technical Service Department before operating and/or servicing the Quickie device. Failure to do so may result in damage and/or injury.

Find more information and important warnings see the wheelchair owner's manual or at: www.SunriseMedical.com.

Sunrise Medical 2842 N. Business Park Ave Fresno, CA 93727 USA
In Canada (800) 263-3390



SEDEO PRO RIGID SEAT ASSEMBLY INSTRUCTION SHEET



Please read these instructions carefully before beginning the installation. Failure to understand and follow installation instructions may result in injury to installer and/or end user and may void the warranty. If you have any questions call Sunrise Medical Technical Support at (800) 333-4000.

Parts:

1. 1 ea M6x30 SHCS (L)
2. 1 ea spacer (M)
3. 1 ea receiver nut (N)

Required tools:

1. 5mm hex key
2. Torque wrench

D. Installing Backrest locking hardware (without armrests)

Note: items notated in parentheses are for reference.

1. Unfold the backrest, and align the mounting hole on the side of the frame, shown in figure 6.
2. Using a 5mm hex key, install the M6x30 SHCS (L), spacer (M), and receiver nut (N) through the mounting hole, as shown in figure 6.
3. Using a torque wrench, torque the M6x30 SHCS (L) to 6.6 ft-lbs (9.0 Nm).



E. Inspect

1. Inspect to verify all torque specifications are met.
2. Verify that back angle adjustment functions properly, by adjusting the threaded spindle (C) with a 5mm hex key.

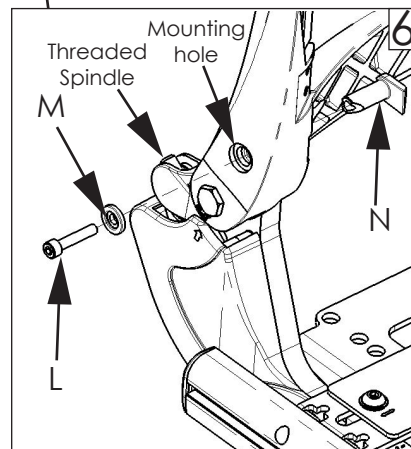
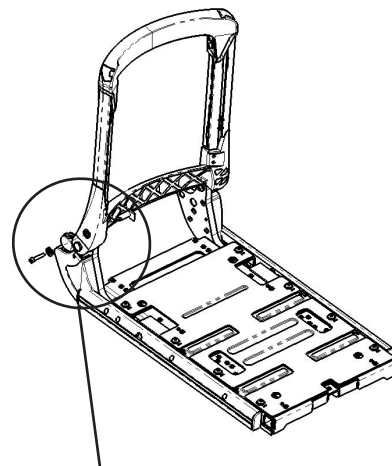
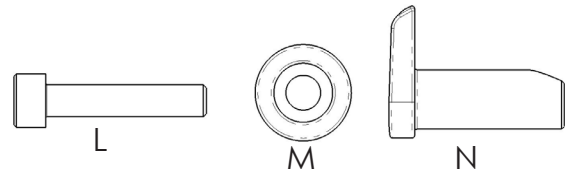

⚠️ DEALER/TECHNICIAN WARNING

Attention dealers and qualified technicians, do not operate or service this device without first reading the owners manual. If you do not understand the instructions and warnings in the owners manual please contact the Quickie Technical Service Department before operating and/or servicing the Quickie device. Failure to do so may result in damage and/or injury.

Find more information and important warnings see the wheelchair owner's manual or at: www.Sunrisemedical.com.

Sunrise Medical 2842 N. Business Park Ave Fresno, CA 93727 USA
In Canada (800) 263-3390



Customer service: (800) 333-4000
or visit www.SunriseMedical.com

© 2019 Sunrise Medical (US) LLC
11/2019 251263 Rev. A Page 3of3