

Tool Needed:

- 10mm wrench



Assemblies Included:

Two sets of fasteners provided. Reference Fastener Key below.

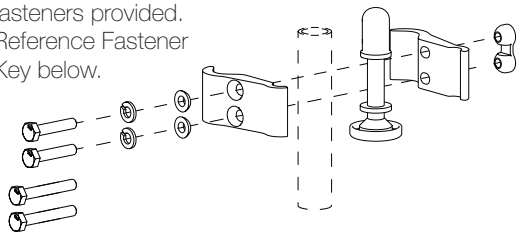

X2

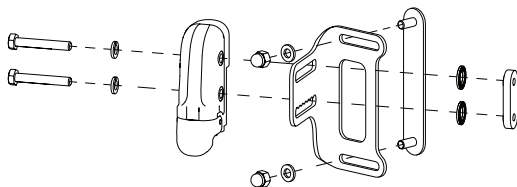

X2

Fastener Key:

Fastener drawings are actual size so hardware can be compared to drawings.

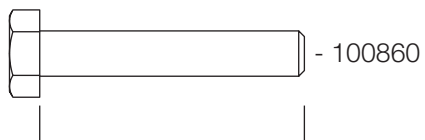

35mm (Used for 1" and 1-1/8" back canes)

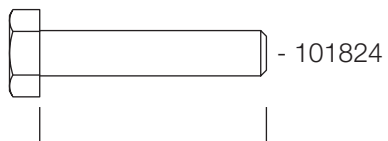

30mm (Used for 3/4" and 7/8" back canes)

If you have any questions or concerns about any aspect of this Axiom back, please do not hesitate to contact us by:

Telephone:
715-254-0991

In Writing at:
Ki Mobility
5201 Woodward Drive
Stevens Point, WI 54481
U.S.A

Or via email at:
sales@kimobility.com

AXIOM

BACKS



Ki Mobility
5201 Woodward Drive
Stevens Point, Wisconsin 54481
715-254-0991
www.kimobility.com

QUICK START GUIDE

General Setup (Before Delivery) - If ordered with installation on chair, skip to Step 4

- 1 Remove backrest shell from cover. Install backrest bracket to shell with stud plate (A), two washers (B) and two dome nuts (C). Install so stud plate studs are 1" from the top of each bracket slot. Loosely tighten hardware. Repeat on opposite side.

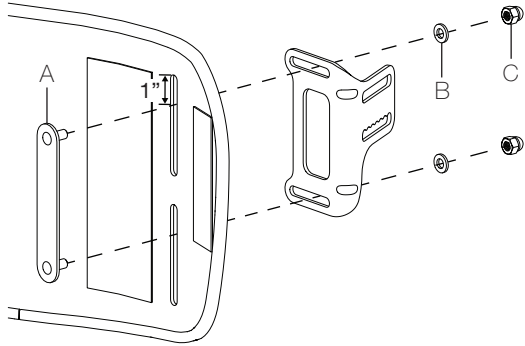

- 2 Install housing (C) to bracket with two bolts (A), two lock washers (B), two washers (D), two spring discs (E) and a nut plate (F). Loosely tighten hardware and repeat on opposite side.

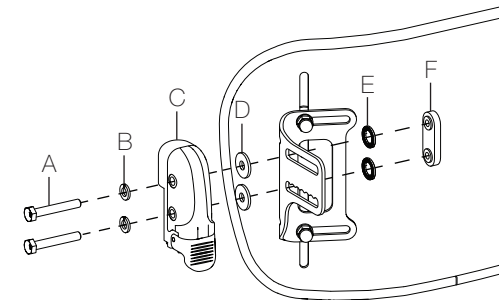

- 3 Install backrest mount clamp (B) to mount plate (C) using two lock washers (E), two spherical washers (D) and a dual nut (A). Bolts should thread inwards from the outside of the chair. Choose bolts, from the two sizes provided, that adequately thread through dual nut without coming up short or sticking out excessively. Loosely tighten hardware. Repeat with second set of backrest mount clamps.

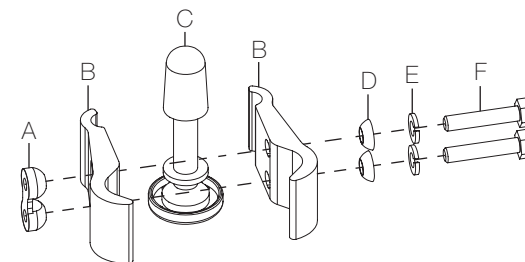

- 4 Install the backrest assembly onto the backrest mounts.

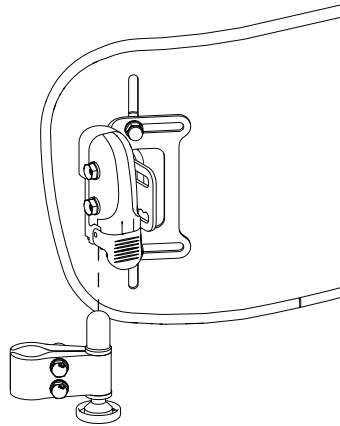

- 5 Visualize the user seated on the chair with a cushion and where the clamps will mount on the backrest canes. Ensure there will be no interference with the backrest canes. The bottom edge of backrest will typically fall between an 1" to 2" above the top of the cushion. Loosen the mount clamps and install onto backrest canes.

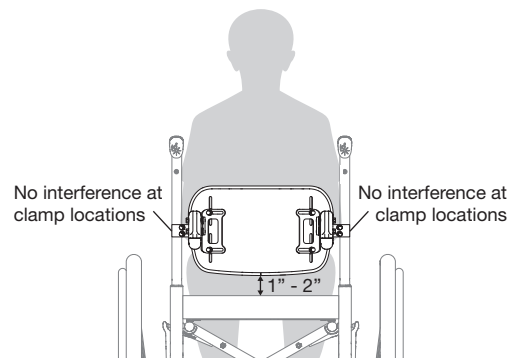

- 6 Adjust backrest so it appears centered between the two back canes and both clamps are set at the same height on both sides. Using a tape measure is recommended to ensure both sides are set up equally.
- 7 Tighten all hardware enough so pieces are secured during travel. Overtightening the back post clamp hardware may cause damage to backrest canes.
- 8 Reinstall backrest cover. Remove and reinstall backrest multiple times to ensure alignment is correct and all pieces are secured in place.

Custom Adjustments (User Present)

- 1 Adjust the height of the backrest, if needed, by loosening the two nuts on the backrest bracket. Slide shell up or down to achieve desired height and retighten hardware. Ensure both sides are set the same.

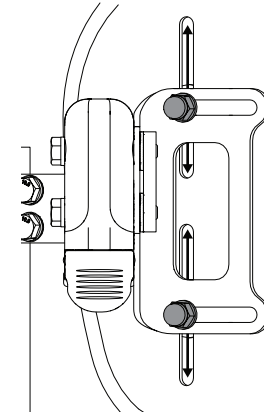

- 2 The angle and the depth of the backrest are adjusted, if needed, at the same time. Loosen the two bolts on the bracket and adjust the angle and depth of the backrest in one movement. Retighten hardware once desired configuration is achieved.

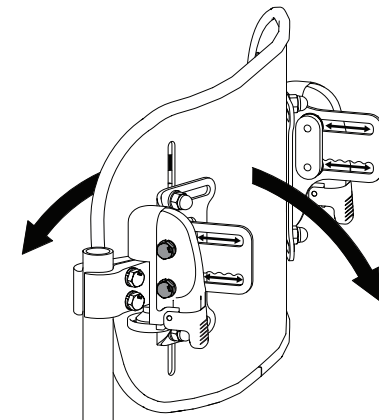

- 3 Tighten all hardware to 110 in-lbs except the acorn nuts which are tightened to 80 in-lbs. Overtightening the back post clamp hardware may cause damage to backrest canes.
- 4 With no user in chair, remove and reinstall backrest multiple times to ensure alignment is correct and all pieces are secured in place.