

Focus CR Height Adjustable with Adjustable Handle Backrest

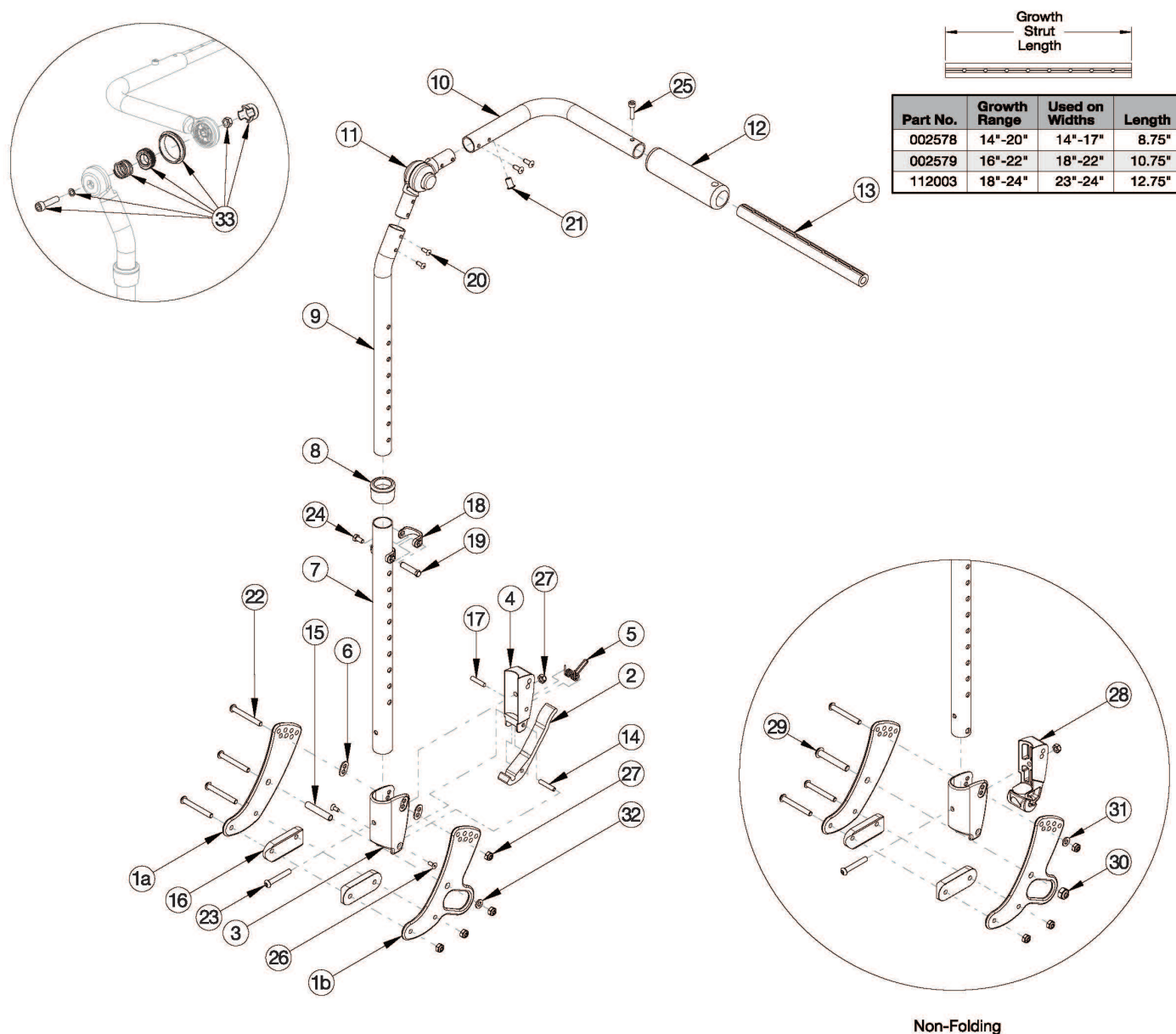

If chair was invoiced prior to 12/18/23, an upper back tube assembly is required. If chair was invoiced after to 12/18/23, parts 9-11 and 20 shown in the diagram above can now be purchased individually. This Focus CR Height Adjustable Backrest is effective starting October 2015 with serial numbers prior to FCR0026599 and FCHD002333, unless a foot tilt or power tilt is present. If foot tilt or power tilt is present, this design effective starting with serial numbers FCR0033747 and FCHD002467. If changing from another style backrest or changing back cane height and the hand tilt is present, a new Hand Tilt Cable/Trigger Kit may be required. If retrofitting from a foot tilt or power tilt to hand tilt and serial number is prior to FCR0033747 and FCHD002467, new back cane assemblies are required in addition to the hand tilt mechanism. If changing from another style and Drum Brake present, Brake Lever may be needed.

| Item Number | Part Number | Description | Quantity |
|---------------------------------------|-------------|--|----------|
| 2-6, 7a, 8, 14, 17-19, 23, 24, 26, 27 | 502663 | Back Assembly w/Latch Insert Lower Tube Height Adjustable Short Focus/CR45/Flip | 1 |
| 2-6, 7b, 8, 14, 17-19, 23, 24, 26, 27 | 502664 | Back Assembly w/Latch Insert Lower Tube Height Adjustable Tall Focus/CR45/Flip | 1 |
| 3, 7a, 8, 18, 19, 23, 24, 28 | 502673 | Lower Tube w/Latch Insert Height Adjustable Back Short Non-Folding Focus/CR45/Flip | 1 |
| 3, 7b, 8, 18, 19, 23, 24, 28 | 502674 | Lower Tube w/Latch Insert Height Adjustable Back Tall Non-Folding Focus/CR45/Flip | 1 |
| 9a, 10a, 11, 12, 20, 21 | 502665 | Upper Back Tube Assembly Height Adj, Right Focus/Flip <i>Used if foot tilt or power tilt is present and serial number is prior to FCR0033747 and FCHD002467.</i> | 1 |
| 9a, 10b, 11, 12, 20, 21 | 506758 | Upper Back Tube Assembly Height Adjustable, Right Focus <i>Use if hand tilt mechanism is present and the serial number is after FCR0026599 and FCHD002333. If changing to a new hand tilt mechanism and serial number is prior to FCR0026599 and FCHD002333, this kit is required in addition to the hand tilt mechanism. Used if foot tilt or power tilt is present and serial number is or after FCR0033747 and FCHD002467.</i> | 1 |
| 9b, 10c, 11, 12, 20, 21 | 502666 | Upper Back Tube Assembly Height Adj, Left Focus/Flip <i>Used if foot tilt or power tilt is present and serial number is prior to FCR0033747 and FCHD002467.</i> | 1 |
| 9b, 10d, 11, 12, 20, 21 | 506759 | Upper Back Tube Assembly Height Adjustable, Left Focus <i>Use if hand tilt mechanism is present and the serial number is after FCR0026599 and FCHD002333. If changing to a new hand tilt mechanism and serial number is prior to FCR0026599 and FCHD002333, this kit is required in addition to the hand tilt mechanism. Used if foot tilt or power tilt is present and serial number is or after FCR0033747 and FCHD002467.</i> | 1 |
| 1a, 15, 16, 22, 27, 32 | 502675 | Backrest Hardware Assembly, Single Side, Std Focus | 1 |
| 1a, 1b, 15, 16, 22, 27, 32 | 502676 | Backrest Hardware Assembly, Single Side, Transit Focus | 1 |
| 1a, 16, 22, 27, 29-31 | 503102 | Backrest Hardware Assembly, Single Side, Std Non-Folding Focus | 1 |
| 1a, 1b, 16, 22, 27, 29-31 | 503103 | Backrest Hardware Assembly, Single Side, Transit Non-Folding Focus | 1 |
| 10c, 12, 20, 21, 25 | 122977 | Push Handle Tube w/ Grip and Hardware Short, Left | 1 |
| 10d, 12, 20, 21, 25 | 122918 | Push Handle Tube w/ Grip and Hardware, Left | 1 |
| 10a, 12, 20, 21, 25 | 122978 | Push Handle Tube w/ Grip and Hardware Short, Right | 1 |
| 10b, 12, 20, 21, 25 | 122920 | Push Handle Tube w/ Grip and Hardware, Right | 1 |
| 13a, 25 | 503107 | Growth Strut Assembly Short, Focus/Flip <i>Used on chairs 14"-17" wide</i> | 1 |
| 13b, 25 | 503108 | Growth Strut Assembly Long, Flip/Focus <i>Used on chairs 18"-22" wide</i> | 1 |

| Item Number | Part Number | Description | Quantity |
|-------------|-------------|---|----------|
| 13c, 25 | 114289 | Growth Strut Assembly Extra Long, Focus <i>Used on chairs 23"-24" wide</i> | 1 |
| 1a | 001071 | Back Plate Std TILT <i>Quantity of 4 used with non-transit. Quantity of 2 used with transit.</i> | 2 |
| 1b | 001421 | Back Plate Transit Inner TILT <i>Quantity of 2 used with transit.</i> | 1 |
| 2 | 001893 | Latch Lever, Backrest | 1 |
| 3, 6 | 503834 | Cover Plate, Latch Insert Kit | 1 |
| 4 | 001895 | Latch Insert, Folding Backrest | 1 |
| 5 | 001896 | Spring, Backrest Latch | 1 |
| 6 | 001897 | Washer, Dual, PSA | 2 |
| 8 | 001083 | Bushing Height Adjustable Back Tilt | 1 |
| 9a | 002597 | Tube, Upper Ht Adj Back R <i>Used on chairs starting 12/18/23</i> | 1 |
| 9b | 002598 | Tube, Upper Ht Adj Back L <i>Used on chairs starting 12/18/23</i> | 1 |
| 11 | 116066 | Locking Hinge Assembly <i>Used on chairs starting 12/18/23</i> | 1 |
| 13a | 002578 | Growth Strut, Stroller, Short | 1 |
| 13b | 002579 | Growth Strut, Stroller, Long | 1 |
| 13c | 112003 | Growth Strut, Stroller, Extra Long | 1 |
| 14 | 002513 | Threaded Barrel, 5mm OD x M4 | 1 |
| 15 | 002738 | Spacer .313 OD x .243 ID x 1.68 long | 1 |
| 16 | 002594 | Saddle, Dual, 1" OD X 1.75 SP | 2 |
| 17 | 102694 | Dowel Pin, M5 X 24, Blk Zn | 1 |
| 18 | 000988 | Fastener Retainer | 1 |
| 19 | 000987 | Threaded Fastener | 1 |
| 20 | 100669 | M5 x 10 BTN SHCS BLKZC w/Patch <i>Used on chairs starting 12/18/23</i> | 4 |
| 22 | 101781 | M6 x 50mm Partial Thread BHCS Blk ZC | 4 |

| Item Number | Part Number | Description | Quantity |
|-------------|-------------|---|----------|
| 23 | 100797 | M6 x 40 BHCS BLK ZC | 1 |
| 24 | 200427 | M5 x 10 CLS8.8 HHCS ZC w/Patch DIN933 | 1 |
| 25 | 101843 | M5 x 20 SHCS Blk Zn | 1 |
| 26 | 101818 | M4 x 10 FHCS BLKZC w/Patch | 2 |
| 27 | 100658 | M6 Nylock Nut Blk Zn | 5 |
| 28 | 002035 | Insert, Backrest, Non-Folding | 1 |
| 29 | 101815 | M8 x 50 BHCS Blk Zn | 1 |
| 30 | 100659 | M8 Nylock Nut Blk Zn | 1 |
| 31 | 100746 | M6 Flat Washer Blk Zn | 1 |
| 32 | 101861 | Nylon Washer 5/16 x 1/2 x .03 | 1 |
| 33 | 110524 | Locking Hinge Button Assembly with Instruction <i>This kit contains the contents inside callout # 11. This assembly may not be compatible if chair was invoiced prior to 6/22/16</i> | 1 |