

Universal BEVERAGE HOLDER

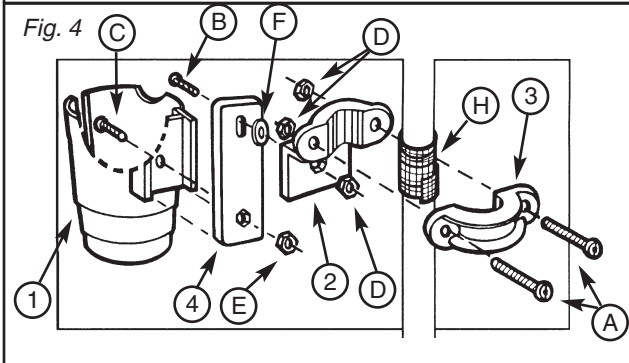
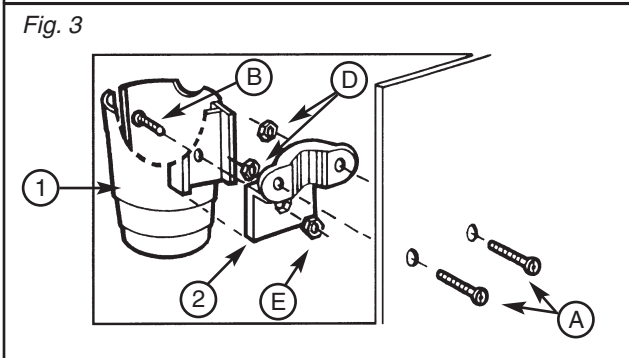
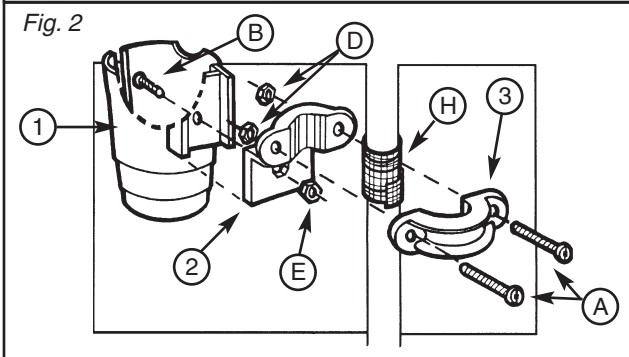
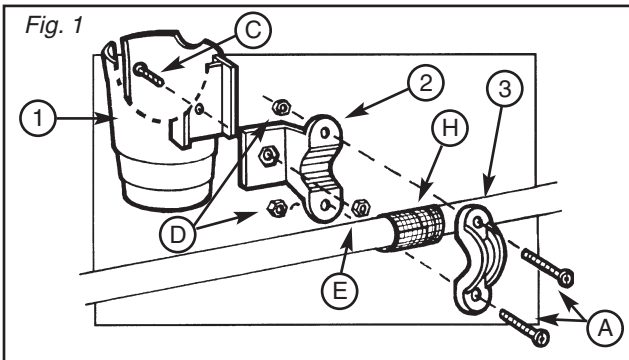

Mounts to: 7/8" – 1-1/2" tubing or on a flat surface at least 1" x 3".
Holds Beverage Containers: 10 oz. to 32 oz.

Mounting Option Instructions

Horizontal Mount

- Using a Phillips head screwdriver and wrench, attach the large clamp (2) to the beverage container (1) with the small screw (C) and self-locking nut (E). Be sure the large clamp (2) is attached vertically.
- Wrap the non-slip grip strip (H) around the desired bar where the beverage holder will be attached.
- Place the assembled beverage holder on one side of the bar and the smaller clamp (3) on the other side.
- Using the two large screws (A) and two nuts (D), connect the assembled beverage holder to the small clamp (3). Be sure to tighten both screws equally.

Vertical Mount

- Using a Phillips head screwdriver and wrench, attach the large clamp (2) to the beverage container (1) with the medium screw (B) and self-locking nut (E). Be sure the large clamp (2) is attached horizontally.
- Please refer to the Horizontal Mount instructions and continue as described in Horizontal Mount step #2.

Flat Mount

- Using a Phillips head screwdriver and wrench, attach the large clamp (2) to the beverage container (1) with the medium screw (B) and self-locking nut (E). Be sure the large clamp (2) is attached horizontally.
- Drill holes in the desired location on a flat surface at least 1" x 3". Be sure these holes match up to the holes on the large clamp (2).
- Insert the two large screws (A) through the drilled holes and secure with nuts (D). Do not overtighten. Small clamp (3) and non-slip grip strip (H) are not required for this mounting option.

Swing Mount

- Slide the extension bar (4) into the slot on the beverage container (1). Using a Phillips head screwdriver and wrench, attach the extension bar (4) to the beverage container (1) with the small screw (C) and self-locking nut (E). Use the single hole and not the slotted end of the extension bar (4) for this step. Also, be sure nut (E) fits into the inset area on the extension bar (4).
- Attach the large clamp (2) to the extension bar (4) using the medium screw (B), washer (F) and nut (D). Do not over tighten; the large clamp (2) and extension bar (4) should be able to swing freely.
- Please refer to the Horizontal Mount instructions and continue as described in Horizontal Mount step #2.

NOTE:

Included are two black plastic screw tips that can be added on the large screws (A) to any mounting option for added safety. Also included, is a styrene insert that fits into the beverage container to help keep beverages cold.

Package Contents:

- | | | |
|--------------------------|--------------------|---------------------------|
| 1–Beverage Container (1) | A–Large Screws (2) | F–Plastic Washer (1) |
| 2–Large Clamp (1) | B–Medium Screw (1) | G–Plastic Screw Tip (2) |
| 3–Small Clamp (1) | C–Small Screw (1) | H–Non-Slip Grip Strip (1) |
| 4–Extension Bar (1) | D–Nut (3) | |
| 5–Styrene Insert (1) | E–Lock Nut (1) | |

Required Tools

- Wrench ► Phillips Head Screwdriver ► Drill, for Flat Mounting option

WARNING: Periodically check assembly for tightness. **Never use the Universal Beverage Holder if any parts appear to be loose or damaged, as personal injury may result.**

NOTE: If any parts are missing, do not return to the place of purchase. Contact Customer Care at 877-505-6190.