

# Arc Dynamic Back

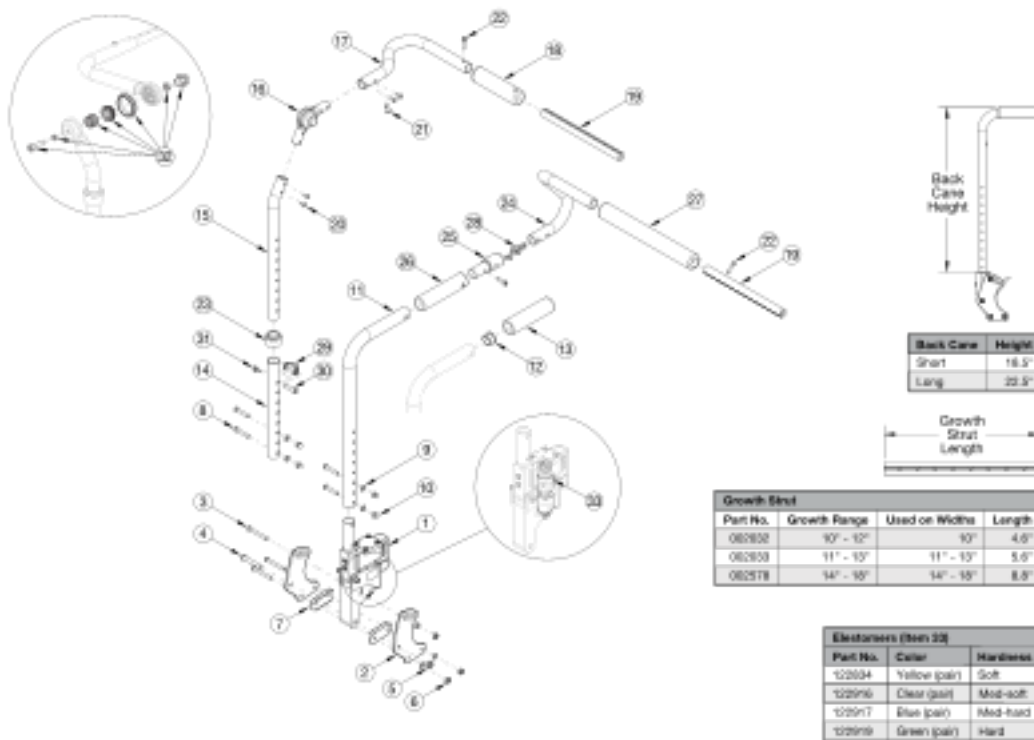

If chair was invoiced prior to 12/18/23 and if a Height Adjustable Backrest is present, an upper back tube assembly is required. If chair was invoiced after to 12/18/23 and if a Height Adjustable Backrest is present, parts 15-18 shown in the diagram above can now be purchased individually. Callout #17: The curved tube is used with the small and medium width ranges (10"-14") and the straight shaped tube is used with the large and extra large (14"-18") width ranges. When changing backrest types, check to see if new cables and tilt triggers are needed for both foot and hand tilts.

Item Number	Part Number	Description	Quantity
1a, 2a	113875	Dynamic Back for Adjustable Height Backrest with Standard Back Plate, PAIR, Arc	1
1b, 2a	113876	Dynamic Back for Stroller Handle Backrest with Standard Back Plate, PAIR, Arc	1
1a, 2a, 2b	113877	Dynamic Back for Adjustable Height Backrest with Transit Back Plate, PAIR, Arc	1
1b, 2a, 2b	113878	Dynamic Back for Stroller Handle Backrest with Transit Back Plate, PAIR, Arc	1
54a	122834	Yellow Replacement Elastomers (Pair)	1

Item Number	Part Number	Description	Quantity
54b	122916	Clear Replacement Elastomers (Pair)	1
54c	122917	Blue Replacement Elastomers (Pair)	1
54d	122919	Green Replacement Elastomers (Pair)	1
10a, 11, 12, 23-25	113879	Stroller Handle Back Tube with Grip, Dynamic Back, Short, Arc	1
10b, 11, 12, 23-25	113880	Stroller Handle Back Tube with Grip, Dynamic Back, Tall, Arc	1
10a, 23-25, 29	113881	Stroller Handle Back Tube with Grip for Stroller Handle Extension, Dynamic Back, Short, Arc	1
10b, 23-25, 29	113882	Stroller Handle Back Tube with Grip for Stroller Handle Extension, Dynamic Back, Tall, Arc	1
13, 14, 20-25	113883	Height Adjustable Back Tube Assembly, Lower, Dynamic Back, Tall, Arc	1
15a, 16, 17a, 18, 19, 43	113884	Height Adjustable Back Tube Assembly, Upper, Dynamic Back, 10-13" Wide, Right, Arc	1
15b, 16, 17b, 18, 19, 43	113885	Height Adjustable Back Tube Assembly, Upper, Dynamic Back, 10-13" Wide, Left, Arc	1
15a, 16, 17c, 18, 19, 43	113886	Height Adjustable Back Tube Assembly, Upper, Dynamic Back, 14-18" Wide, Right, Arc	1
15b, 16, 17d, 18, 19, 43	113887	Height Adjustable Back Tube Assembly, Upper, Dynamic Back, 14-18" Wide, Left, Arc	1
46, 47, 48a, 48b, 49, 50, 51a	113539	Removable Stroller Handle Assembly, 10" width, Arc	1
46, 47, 48a, 48b, 49, 50, 51b	113540	Removable Stroller Handle Assembly, 11-13" width, Arc	1
46, 47, 48c, 48d, 49, 50, 51c	113541	Removable Stroller Handle Assembly, 14-18" width, Arc	1
30, 32, 34, 42, 44, 45	113600	Rigidizer Handle Pivot Assembly with Adapter with Foam Grip, Arc	1
31, 33, 34, 36-41, 44, 45	113601	Rigidizer Handle Latch Assembly with Adapter with Foam Grip, Arc	1
30-34, 25a, 36-45	113602	Rigidizer Handle Complete Assembly, Small and Large Width Ranges, Arc	1
30-34, 25b, 36-45	113603	Rigidizer Handle Complete Assembly, Medium and X-Large Width Ranges, Arc	1
4-9, 27, 28	113546	Backrest Roller Kit, Arc	2
3, 26, 28	113888	Dynamic Back Frame Attaching Hardware Kit, Arc	1
2a	110190	Back Plate, Bearing Guide, Standard	1
2b	113181	Transit Back Plate, Standard, Arc	1
3	002595	Saddle, Dual, 1" OD X 1.5 SP	1
11	100804	Tube End Plug 1"	1
14	001083	Bushing Height Adjustable Back Tilt	1

Item Number	Part Number	Description	Quantity
15a	002597	Tube, Upper Ht Adj Back R <i>Used on chairs starting 12/18/23</i>	1
15b	002598	Tube, Upper Ht Adj Back L <i>Used on chairs starting 12/18/23</i>	1
16	116066	Locking Hinge Assembly <i>Used on chairs starting 12/18/23</i>	1
17a	110251	Push Handle, Angle Adjustable Offset, Right <i>Used on chairs starting 12/18/23</i>	1
17b	110252	Push Handle, Angle Adjustable Offset, Left <i>Used on chairs starting 12/18/23</i>	1
17c	110256	Push Handle, Angle Adjustable, Right <i>Used on chairs starting 12/18/23</i>	1
17d	110257	Push Handle, Angle Adjustable, Left <i>Used on chairs starting 12/18/23</i>	1
18	100669	M5 x 10 BTN SHCS BLKZC w/Patch <i>Used on chairs starting 12/18/23</i>	4
20	000988	Fastener Retainer	1
21	000987	Threaded Fastener	1
22	200427	M5 x 10 CLS8.8 HHCS ZC w/Patch DIN933	1
23	101811	M6 x 35 BHCS Blk Zn	2
24	100746	M6 Flat Washer Blk Zn	2
25	100558	M6 Nyl Ins Domed Cap L/N Zc	2
26	101781	M6 x 50mm Partial Thread BHCS Blk ZC	6
28	100658	M6 Nylock Nut Blk Zn	6
31	110259	Adapter, Latch, Rigidizer Handle	1
35a	110264	Cross Tube, Rigidizer Handle, 14-16 Wide	1
35b	110265	Cross Tube, Rigidizer Handle, 16-18 Wide	1
40	110290	SHCS, M4 x 0.7 x 18, CLS12.9, BLZ, NYL, DIN912	1
41	101185	M6 x 14 CLS8.8 DIN7984 Low SHCS BLKZC	1
42	110291	E-RING, M13-M18, DIN6799, ZC	1
43	100669	M5 x 10 BTN SHCS BLKZC w/Patch	1

Item Number	Part Number	Description	Quantity
44	102614	M5 Split Lock Washer BLK ZC	1
45	101766	M5 X 10 Cls12.9 Din912 Shcs Pln	1
46	001243	Stroller Handle Adaptor	1
50	101843	M5 x 20 SHCS Blk Zn	1
51a	002032	Growth Strut, Stroller, 10-12 <i>Used on 10" widths</i>	1
51b	002033	Growth Strut, Stroller, 11-13 <i>Used on 11-13" widths</i>	1
51c	002578	Growth Strut, Stroller, Short <i>Used on 14-18" Widths</i>	1