

Catalyst Stroller Handle Back Post with Removable Stroller Handle Extension (Depth Adjustable)

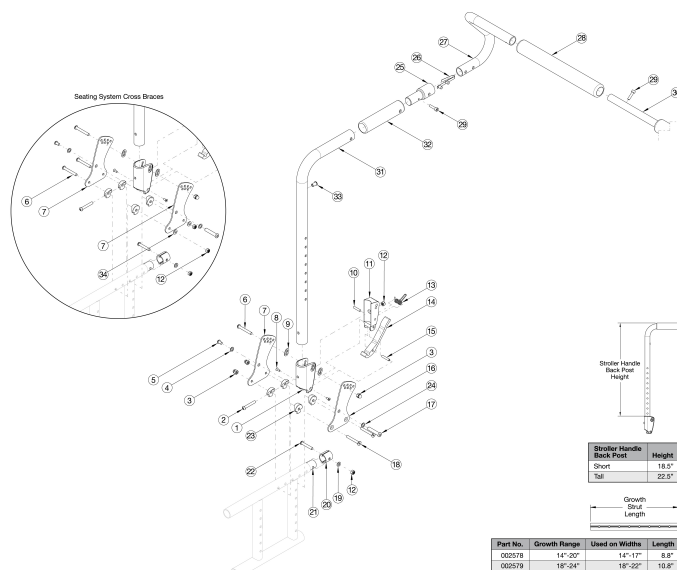

This backrest style and removable stroller handle extension was released February 8th, 2021. If changing from another style backrest and the Drum Brake is present, a new Drum Brake Cable Kit may be required. If Anti-Rollback is present, see Back Tubes for Anti-Rollback System.

Item Number	Part Number	Description	Quantity
25, 26, 27a, 27b, 28, 29, 30a, 31a, 32, 33	112640	<p>Stroller Handle Back Post, Short, with Removable Stroller Handle Extension Assembly, 14-17" Wide, Catalyst/Spark, PAIR</p> <p><i>This kit does not contain any backrest hardware. For a complete retrofit, select this kit and the desired Depth Adjustable Backrest Hardware Assembly. If chair was invoiced with backrest code 50BOP032, new backcanes are not required to retrofit the drum brake. If chair was invoiced with backrest code 50BOP010, a complete backrest retrofit to this Depth Adjustable Back design is required in order to retrofit the drum brake.</i></p>	1
25, 26, 27a, 27b, 28, 29, 30a, 31b, 32, 33	112641	<p>Stroller Handle Back Post, Tall, with Removable Stroller Handle Extension Assembly, 14-17" Wide, Catalyst/Spark, PAIR</p> <p><i>This kit does not contain any backrest hardware. For a complete retrofit, select this kit and the desired Depth Adjustable Backrest Hardware Assembly. If chair was invoiced with backrest code 50BOP032, new backcanes are not required to retrofit the drum brake. If chair was invoiced with backrest code 50BOP010, a complete backrest retrofit to this Depth Adjustable Back design is required in order to retrofit the drum brake.</i></p>	1
25, 26, 27a, 27b, 28, 29, 30b, 31a, 32, 33	112642	<p>Stroller Handle Back Post, Short, with Removable Stroller Handle Extension Assembly, 18-22" Wide, PAIR</p>	1

Item Number	Part Number	Description	Quantity
		<i>This kit does not contain any backrest hardware. For a complete retrofit, select this kit and the desired Depth Adjustable Backrest Hardware Assembly. If chair was invoiced with backrest code 50BOP032, new backcanes are not required to retrofit the drum brake. If chair was invoiced with backrest code 50BOP010, a complete backrest retrofit to this Depth Adjustable Back design is required in order to retrofit the drum brake.</i>	
25, 26, 27a, 27b, 28, 29, 30b, 31b, 32, 33	112643	Stroller Handle Back Post, Tall, with Removable Stroller Handle Extension Assembly, 18-22" Wide, PAIR <i>This kit does not contain any backrest hardware. For a complete retrofit, select this kit and the desired Depth Adjustable Backrest Hardware Assembly. If chair was invoiced with backrest code 50BOP032, new backcanes are not required to retrofit the drum brake. If chair was invoiced with backrest code 50BOP010, a complete backrest retrofit to this Depth Adjustable Back design is required in order to retrofit the drum brake.</i>	1
25, 26, 27a, 27b, 28, 29, 30a	112644	Removable Stroller Handle Extension Assembly, 14" - 17" Wide, Catalyst/Spark, PAIR <i>This kit does not contain back posts or backrest hardware</i>	1
25, 26, 27a, 27b, 28, 29, 30b	112645	Removable Stroller Handle Extension Assembly, 18" - 22" Wide, PAIR <i>This kit does not contain back posts or backrest hardware</i>	1
31a, 32, 33	112646	Stroller Handle Back Post for Removable Stroller Handle Extension, Short <i>If chair was invoiced with backrest code 50BOP032, new backcanes are not required to retrofit the drum brake. If chair was invoiced with backrest code 50BOP010, a complete backrest retrofit to this Depth Adjustable Back design is required in order to retrofit the drum brake</i>	1
31b, 32, 33	112647	Stroller Handle Back Post for Removable Stroller Handle Extension, Tall <i>If chair was invoiced with backrest code 50BOP032, new backcanes are not required to retrofit the drum brake. If chair was invoiced with backrest code 50BOP010, a complete backrest retrofit to this Depth Adjustable Back design is required in order to retrofit the drum brake</i>	1
1-15, 16a, 17-20, 22-24	112603	Depth Adjustable Backrest Hardware Assembly, for Std Cross Braces, Left Side	1
1-15, 16b, 17-20, 22-24	112604	Depth Adjustable Backrest Hardware Assembly, for Seating Cross Braces Right	1
1-15, 16a, 16b, 17-20, 22-24	122900	Depth Adjustable Backrest Hardware Assembly, for Std Cross Braces Pair	1
1-15, 17-20, 22, 23, 34	112605	Depth Adjustable Backrest Hardware Assembly, for Seating Cross Braces Left	1
1-15, 17-20, 22, 23, 34	122899	Depth Adjustable Backrest Hardware Assembly, for Seating Cross Braces Right	1
1-15, 17-20, 22, 23, 34	112606	Depth Adjustable Backrest Hardware Assembly, for Seating Cross Braces, PAIR	1
1, 9	503834	Cover Plate, Latch Insert Kit	1
2	100797	M6 x 40 BHCS BLK ZC	1
3	100558	M6 Nyl Ins Domed Cap L/N Zc	3
4	101701	Washer 3.315/.350 x .425/.525 x .059/.067 18-8 F/W	1

Item Number	Part Number	Description	Quantity
5	101184	M6 x 10 BTN SHCS BLKZC w/Patch	1
6	100670	M6 x 45 BTN SHCS BLK ZC	1
7	111833	Depth Adjustable Back Plate, Folding <i>Use quantity 1 per side if standard cross braces are present. Use quantity 2 per side if seating system cross braces are present.</i>	1
8	101818	M4 x 10 FHCS BLKZC w/Patch	2
9	001897	Washer, Dual, PSA	2
10	102694	Dowel Pin, M5 X 24, Blk Zn	1
11	001895	Latch Insert, Folding Backrest	1
12	100658	M6 Nylock Nut Blk Zn <i>Use quantity 2 per side if standard cross braces are present. Use quantity 4 per side if seating system cross braces are present.</i>	2
13	001896	Spring, Backrest Latch	1
14	001893	Latch Lever, Backrest	1
15	002513	Threaded Barrel, 5mm OD x M4	1
16a	111835	Depth Adjustable Back Plate, Inner, Folding, Left <i>Only used when standard cross braces are present</i>	1
16b	111834	Depth Adjustable Back Plate, Inner, Folding, Right <i>Only used when standard cross braces are present</i>	1
17	003284	Binding Post, 8mm x 40mm x M6	1
18	101592	M6 x 45 CLS10.9 DIN7991 FHCS BLKZC	2
19	100746	M6 Flat Washer Blk Zn	1
20	114443	Tube Spacer, Black, 1" OD x .083" x .80 LG <i>Replacement for part number 001230</i>	2
21	000605	Depth Adjustable Frame Extension Tube, Catalyst/Spark	1
22	101811	M6 x 35 BHCS Blk Zn	1
23	000612	1" Half Saddle Washer	4
24	101861	Nylon Washer 5/16 x 1/2 x .03 <i>Only used when standard cross braces are present</i>	1
25	001243	Stroller Handle Adaptor	1
26	100533	Detent Button	1

Item Number	Part Number	Description	Quantity
27a, 28	501091	Stroller Handle with Foam Grip, Left	1
27b, 28	501090	Stroller Handle with Foam Grip, Right	1
29	101843	M5 x 20 SHCS Blk Zn	2
30a	002578	Growth Strut, Stroller, Short <i>Used on chair widths 14-17" Wide</i>	1
30b	002579	Growth Strut, Stroller, Long <i>Used on chair widths 18-22" Wide</i>	1
34	102803	Washer Flat .250 X .500 X .027 Hx Blz <i>Only used when seating system cross braces are present</i>	2