

Flip Rear Frame

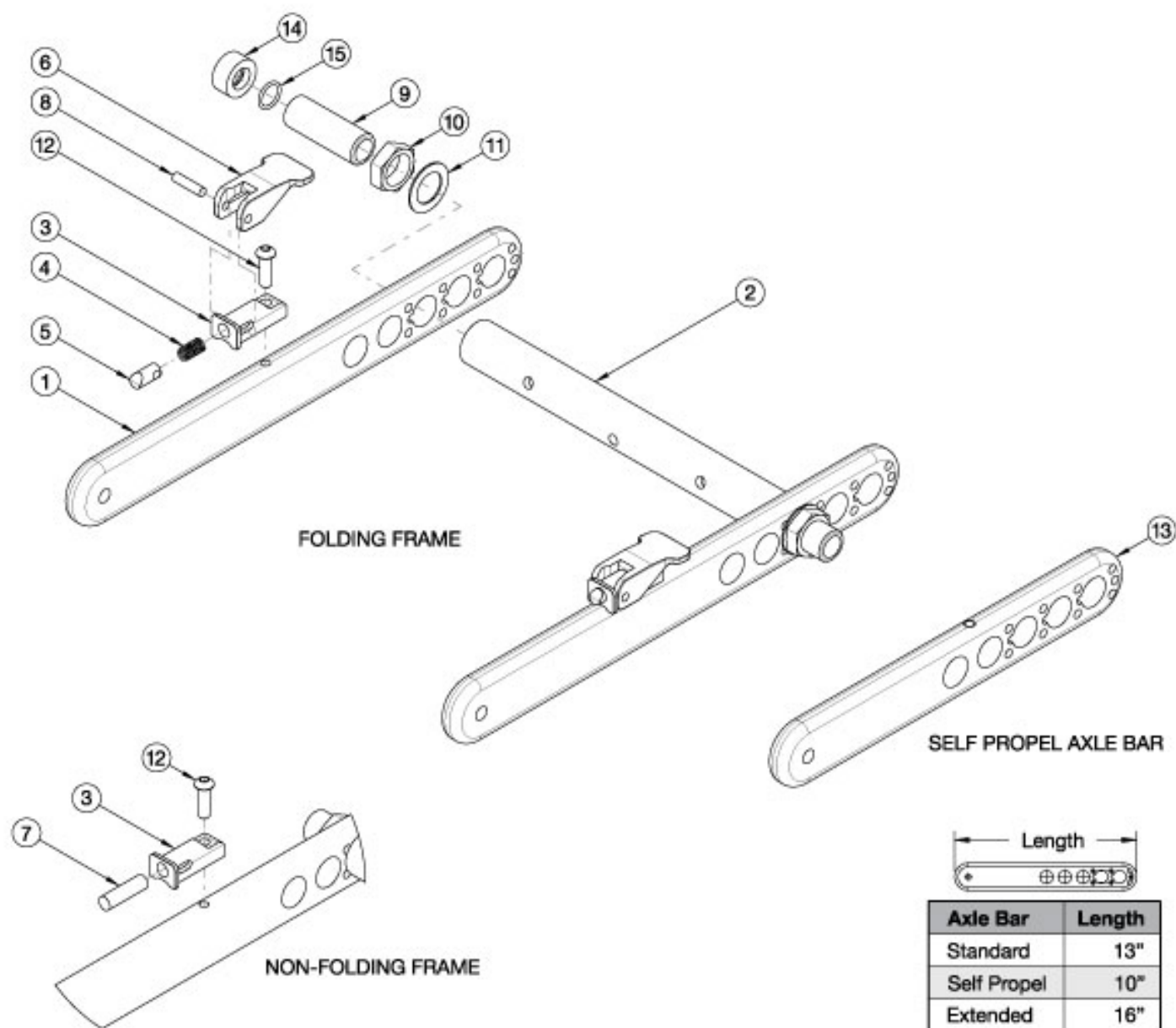

| Item Number | Part Number | Description | Quantity |
|-------------|-------------|---|----------|
| 3-6, 8, 12 | 502795 | Base Kit, Folding, FLIP <i>This kit is for one side; order quantity 2 for both sides</i> | 1 |
| 3, 7, 8, 12 | 502796 | Base Kit, Rigid, FLIP <i>This kit is for one side; order quantity 2 for both sides</i> | 1 |
| 1a | 001838 | Axle Bar, Standard | 1 |
| 1b | 003838 | Axle Bar, Extended <i>Used with reclining backrest</i> | 1 |

| Item Number | Part Number | Description | Quantity |
|-------------|-------------|--|----------|
| 2a | 001840 | Axle Tube, 10W | 1 |
| 2b | 001841 | Axle Tube, 11W | 1 |
| 2c | 001842 | Axle Tube, 12W | 1 |
| 2d | 001843 | Axle Tube, 13W | 1 |
| 2e | 001844 | Axle Tube, 14W | 1 |
| 2f | 001845 | Axle Tube, 15W | 1 |
| 2g | 001846 | Axle Tube, 16W | 1 |
| 2h | 001847 | Axle Tube, 17W | 1 |
| 2i | 001848 | Axle Tube, 18W | 1 |
| 3 | 001849 | Plunger Housing, Fold Release | 2 |
| 4 | 001850 | Spring, Fold Release | 2 |
| 5 | 001851 | Locking Pin, Axle Bar | 2 |
| 6 | 002646 | Lever, Fold Release | 2 |
| 7 | 102781 | Dowel Pin, M8 x 28, SS | 2 |
| 8 | 102782 | Dowel Pin, M5 x 20, SS | 2 |
| 9a | 114480 | Axle Receiver, 2.5" Length <i>Replaced part number 100756. Used with quick release axles. Not used if Drum Brake is present; see Little Wave Flip Drum Brake.</i> | 2 |
| 9b | 003239 | Axle Receiver, Threaded Axle <i>Used with fixed axles</i> | 2 |
| 10 | 100514 | Axle Receiver Nut M18 x D12 x 8mm | 2 |
| 11 | 100583 | Axle Plate Washer 18mm | 2 |
| 12 | 101721 | M6 x 16 Btn SHCS w/ Patch | 2 |
| 13 | 001839 | Axle Bar, Self Propel | 1 |
| 14, 15 | 506326 | Axle Spacer Kit <i>Used with MAXX Mag wheels in combination with the 100756 axle receiver (discontinued 3/3/2023)</i> | 1 |