

Catalyst Pelvic Positioning Belts - 1.5" Auto Buckle and Hardware

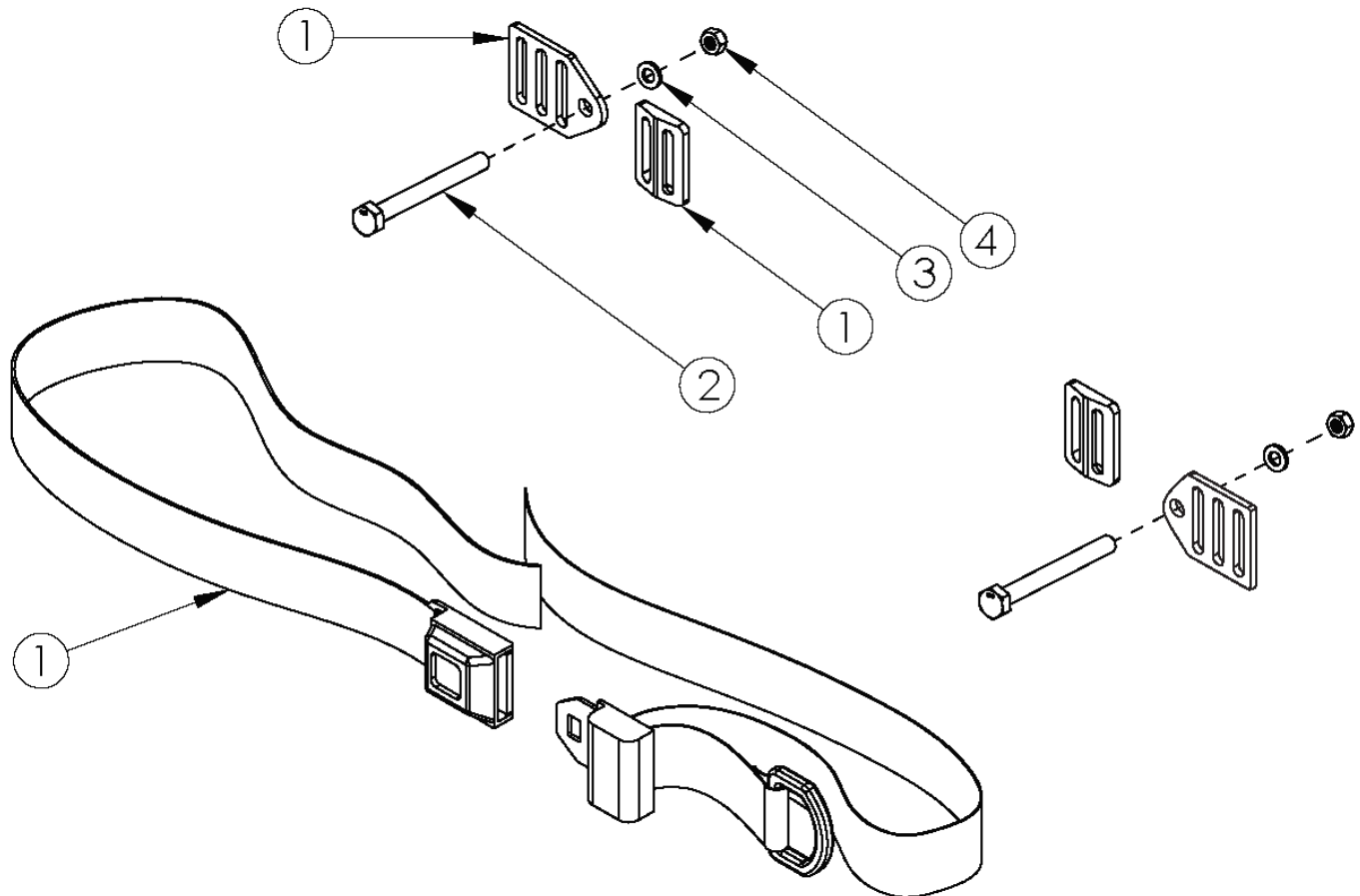

Item Number	Part Number	Description	Quantity
1a, 2, 3, 4	100595	Belt Pelvic Positioning 1.5" Auto Buckle 56" <i>Used with seat widths up to 20" and standard weight capacity</i>	1
1b, 2, 3, 4	111391	Belt Pelvic Positioning 1.5" Auto Buckle 60", Catalyst/Spark <i>Used with 21"-22" seat widths and all heavy duty</i>	1
1b	100847	Belt Pelvic Positioning 1.5" Auto Buckle 60"	1
2	100681	M6 x 40 CLS8.8 DIN931 HHCS ZC	2
3	100746	M6 Flat Washer Blk Zn	2
4	100658	M6 Nylock Nut Blk Zn	2