

# Catalyst Standard Back Upholstery

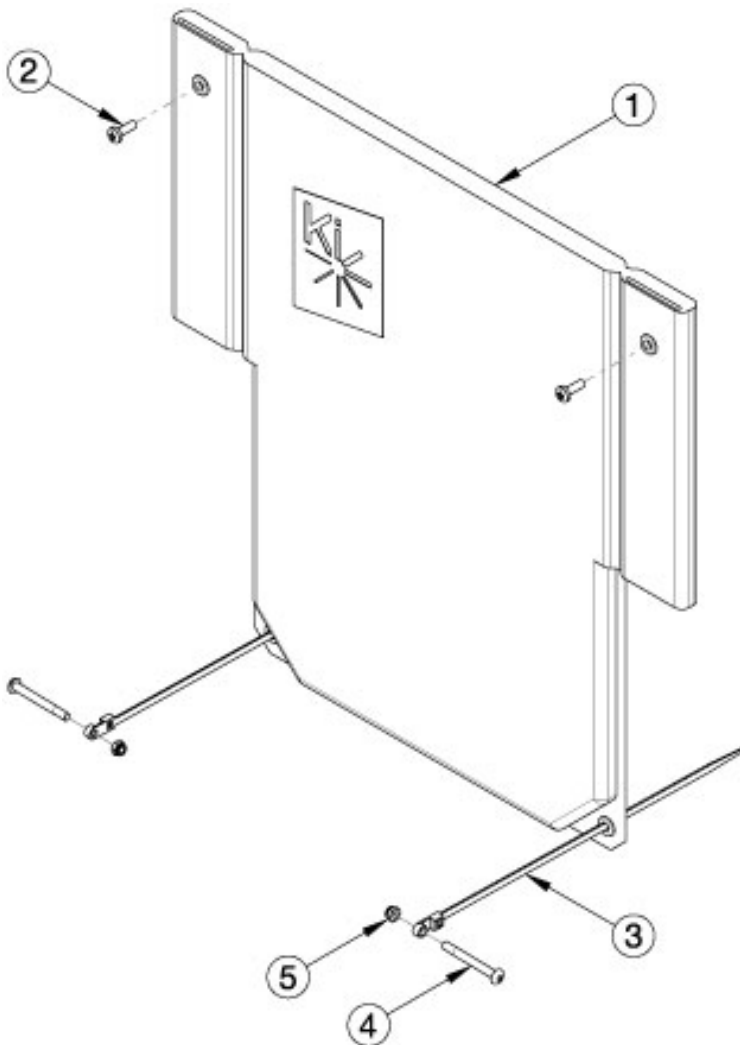

Standard Back Upholstery Compatibility		
Back Post	Height Range	Back Height
Standard	Short	8.5" - 11.5"
	Medium	12.5" - 15.5"
	Tall	16.5" - 19.5"
Angle Adjustable	Short	14" - 16"
	Medium	16" - 18"
	Tall	18" - 20"

The Catalyst 4 only utilizes the "Tall" back upholstery options. The Catalyst 4C utilizes all back upholstery options. Attaching hardware is not included with the back upholstery.

Item Number	Part Number	Description	Quantity
3, 4, 5	503727	Zip Tie Kit <i>This kit contains one zip tie, one bolt and one nut.</i>	1
3, 4, 5	503745	Zip Tie Kit PAIR	1
1a	100145	Back Upholstery Short 14" Wide CAT	1
1b	100148	Back Upholstery Short 15" Wide CAT	1
1c	100151	Back Upholstery Short 16" Wide CAT	1
1d	100154	Back Upholstery Short 17" Wide CAT	1
1e	100157	Back Upholstery Short 18" Wide CAT	1

Item Number	Part Number	Description	Quantity
1f	100160	Back Upholstery Short 19" Wide CAT	1
1g	100163	Back Upholstery Short 20" Wide CAT	1
1h	100146	Back Upholstery Medium 14" Wide CAT	1
1i	100149	Back Upholstery Medium 15" Wide CAT	1
1j	100152	Back Upholstery Medium 16" Wide CAT	1
1k	100155	Back Upholstery Medium 17" Wide CAT	1
1l	100158	Back Upholstery Medium 18" Wide CAT	1
1m	100161	Back Upholstery Medium 19" Wide CAT	1
1n	100164	Back Upholstery Medium 20" Wide CAT	1
1o	100147	Back Upholstery Tall 14" Wide CAT	1
1p	100150	Back Upholstery Tall 15" Wide CAT	1
1q	100153	Back Upholstery Tall 16" Wide CAT	1
1r	100156	Back Upholstery Tall 17" Wide CAT	1
1s	100159	Back Upholstery Tall 18" Wide CAT	1
1t	100162	Back Upholstery Tall 19" Wide CAT	1
1u	100165	Back Upholstery Tall 20" Wide CAT	1
1v	100874	Back Upholstery Tall 21" Wide CAT	1
1w	100246	Back Upholstery Tall 22" Wide CAT	1
2	100734	M5 x 16 PHMS ZC	2
3	100685	Zip Tie, Black	2
4	100666	M5 x 45 BTN SHCS BLKZC	2
5	100657	M5 Nylock Nut Blk Zn	2