

Non-Folding Backrest

Instructions for Initial Backrest Assembly

1. Remove nut (1) and washer (2) from lower screw in back plate.
2. Remove lower screw (3) with washer (4) from back plate, retaining saddles (5).
3. Hold saddles to both sides of back cane at lower hole and raise back canes upright, moving lower part of back cane between back plates and align holes in back plates, saddles, and back canes. Use a screwdriver or similar object as an aligning tool if necessary.

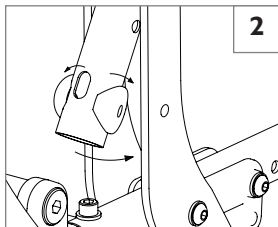
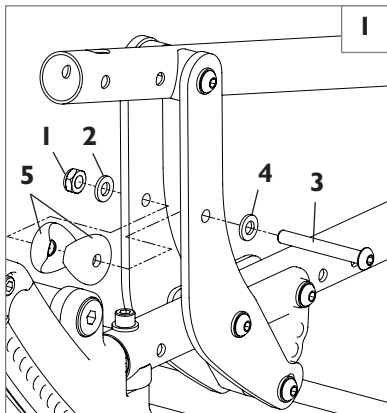

RECOMMENDATION: Just before back cane goes between back plates, rotate saddles around the back cane toward the front of the chair to allow the saddles to lead in between the back plates more easily. (Fig. 2)

- Once holes are aligned, insert screw through back plates, saddles and back cane. Install washer and lock nut and tighten snugly. Head of screw should face the outside of the chair. Backrest should appear as shown in figure 3.
- Repeat for opposite side of chair.

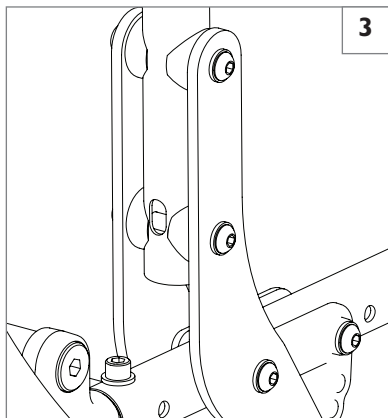

Finished Assembly

Sunrise Medical (US) LLC • 2842 Business Park Ave. • Fresno, CA 93727 • USA
In Canada (800) 263-3390