

Flip for Leckey Attendant Foot Lock

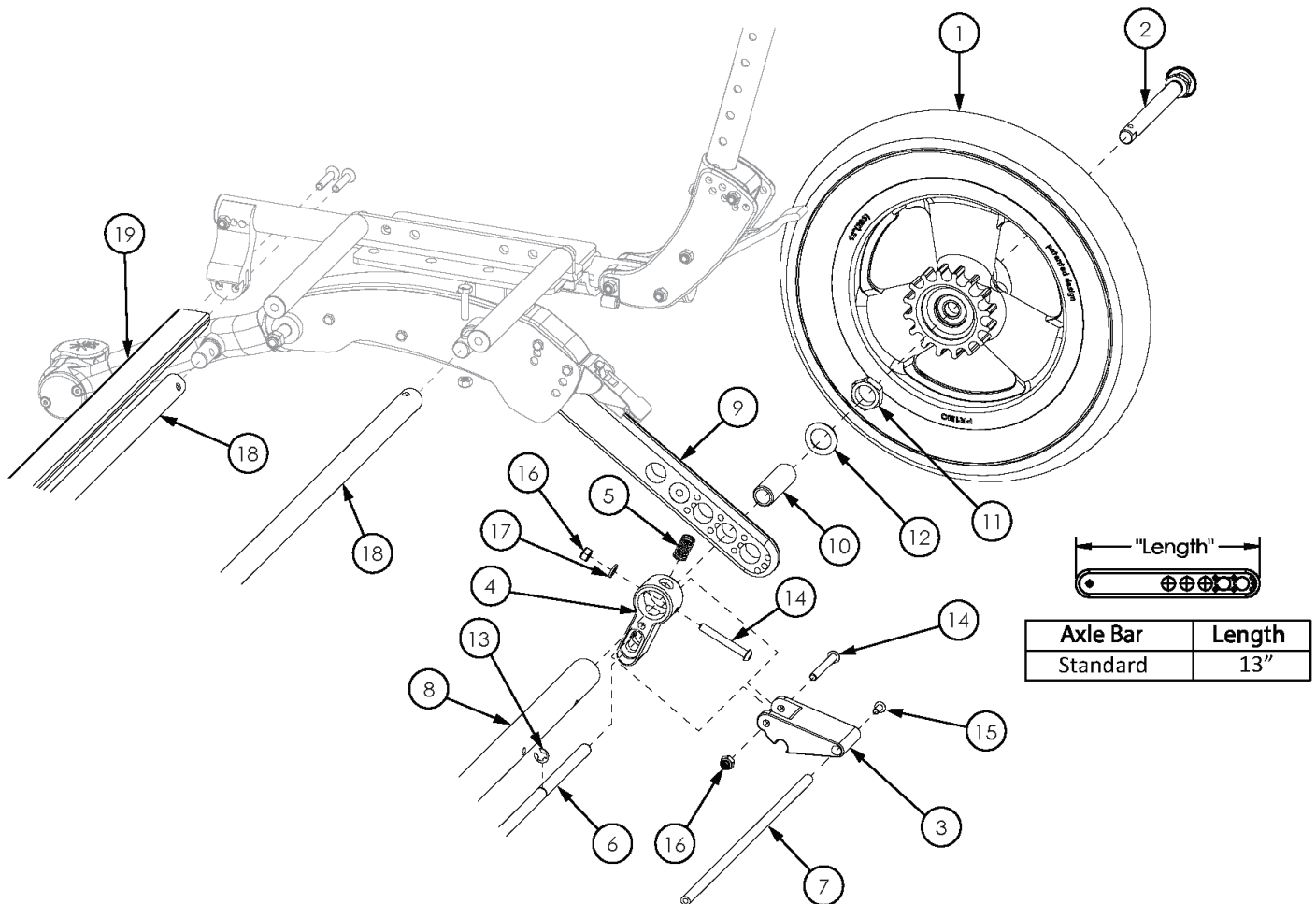

This design effective starting with serial number FLP007536 Attendant Foot Lock Kits do not include wheel or locking hub; please also select the appropriate Attendant Foot Lock Wheels

Item Number	Part Number	Description	Quantity
3-5, 6a, 7a, 13-17	505474	Attendant Foot Lock Kit 14 Wide FLIP	1
3-5, 6b, 7b, 13-17	505475	Attendant Foot Lock Kit 15 Wide FLIP	1
4, 6a, 7a, 8a, 13, 18a, 18c, 19a	505483	Strut Kit 14" Wide Flip w/ Attendant Foot Lock	1
4, 6b, 7b, 8b, 13, 18b, 18d, 19b	505484	Strut Kit 15" Wide Flip w/ Attendant Foot Lock	1
4, 6a, 13	505465	Locking Rod Hub Lock 14 Wide Kit	1
4, 6b, 13	505466	Locking Rod Hub Lock 15 Wide Kit	1

Item Number	Part Number	Description	Quantity
1a	502853	Flip Attendant Foot Lock Wheel, 12" Pneumatic EACH	1
1b	502854	Flip Attendant Foot Lock Wheel, 12" Airless EACH	1
1c	502855	Flip Attendant Foot Lock Wheel, 12" Full Poly EACH	1
1d	502856	Flip Attendant Foot Lock Wheel, 16" Pneumatic EACH	1
1e	502857	Flip Attendant Foot Lock Wheel, 16" Airless EACH	1
1f	502858	Flip Attendant Foot Lock Wheel, 16" Full Poly EACH	1
2a	101108	Axle Quick Release w/ Button 1/2" x 99MM <i>Used with axle receiver 100756 (Discontinued 3/3/2023)</i>	2
2b	101191	Axle Quick Release w/ Button 1/2" x 110MM <i>Used with axle receiver 114480</i>	1
3	001928	Lever, Hub Lock	2
5	001929	Spring, Hub Lock	2
7a	001943	Link Rod Hub Lock 14 Wide	1
7b	001944	Link Rod Hub Lock 15 Wide	1
8a	001844	Axle Tube, 14W	1
8b	001845	Axle Tube, 15W	1
9a	001838	Axle Bar, Standard	2
10	114480	Axle Receiver, 2.5" Length <i>Replaced part number 100756</i>	2
11	100514	Axle Receiver Nut M18 x D12 x 8mm	2
12	100583	Axle Plate Washer 18mm	2
13	103503	3/8" External Self-Locking Shaft Ring	2
14	100670	M6 x 45 BTN SHCS BLK ZC	4
15	100669	M5 x 10 BTN SHCS BLKZC w/Patch	2
16	100658	M6 Nylock Nut Blk Zn	4
17	100746	M6 Flat Washer Blk Zn	2
18a	002632	Frame Growth Strut 10.5" <i>Used on 14" wide chairs</i>	1
18b	002633	Frame Growth Strut 11.5" <i>Used on 15" wide chairs</i>	1

Item Number	Part Number	Description	Quantity
18c	002635	Frame Growth Strut 13.5" <i>Used on 14" wide chairs</i>	1
18d	002636	Frame Growth Strut 14.5" <i>Used on 15" wide chairs</i>	1
19a	001883	Strut Tube Seat 14 Wide	1
19b	001884	Strut Tube Seat 15 Wide	1