

Catalyst Reclining Backrest

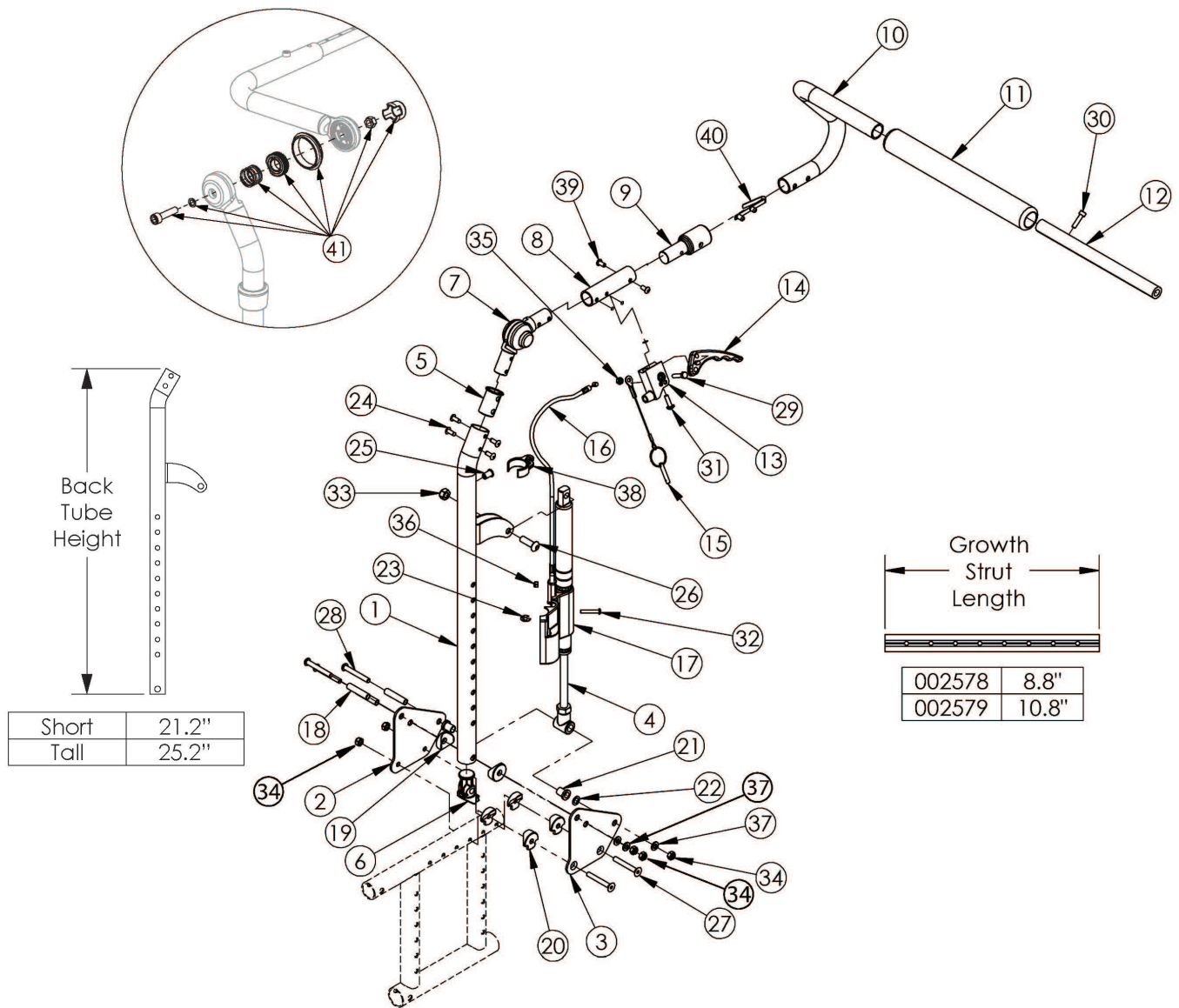

If retrofitting, new rear frames and amputee axle plates are required. New sized anti-tips may be required <p>
 Not available with Transit Option or Heavy Duty option.

Item Number	Part Number	Description	Quantity	Retail
1a, 2, 3a, 3b, 4a, 4b, 5-7, 8a, 8b, 9, 10a, 10b, 11, 12a, 13-15, 16a, 17a, 17b, 18-40	503333	Recline Back Kit, Short Height, 14-17" Width, Standard Gas Spring PAIR, Catalyst <i>Contains parts for complete retrofit</i>	1	\$1,207.93

Item Number	Part Number	Description	Quantity	Retail
1a, 2, 3a, 3b, 4a, 4b, 5-7, 8a, 8b, 9, 10a, 10b, 11, 12b, 13-15, 16a, 17a, 17b, 18- 40	503334	Recline Back Kit, Short Height, 18-22" Width, Standard Gas Spring PAIR, Catalyst <i>Contains parts for complete retrofit</i>	1	\$1,207.93
1b, 2, 3a, 3b, 4a, 4b, 5-7, 8a, 8b, 9, 10a, 10b, 11, 12a, 13-15, 16b, 17a, 17b, 18- 40	503335	Recline Back Kit, Tall Height, 14-17" Width, Standard Gas Spring PAIR, Catalyst <i>Contains parts for complete retrofit</i>	1	\$1,207.93
1b, 2, 3a, 3b, 4a, 4b, 5-7, 8a, 8b, 9, 10a, 10b, 11, 12b, 13-15, 16b, 17a, 17b, 18- 40	503336	Recline Back Kit, Tall Height, 18-22" Width, Standard Gas Spring PAIR, Catalyst <i>Contains parts for complete retrofit</i>	1	\$1,207.93
1a, 2, 3a, 3b, 4c, 4d, 5-7, 8a, 8b, 9, 10a, 10b, 11, 12a, 13-15, 16a, 17a, 17b, 18- 40	503337	Recline Back Kit, Short Height, 14-17" Width, Heavy Duty Gas Spring PAIR, Catalyst <i>Contains parts for complete retrofit</i>	1	\$1,207.93
1a, 2, 3a, 3b, 4c, 4d, 5-7, 8a, 8b, 9, 10a, 10b, 11, 12b, 13-15, 16a, 17a, 17b, 18- 40	503338	Recline Back Kit, Short Height, 18-22" Width, Heavy Duty Gas Spring PAIR, Catalyst <i>Contains parts for complete retrofit</i>	1	\$1,207.93
1b, 2, 3a, 3b, 4c, 4d, 5-7, 8a, 8b, 9, 10a, 10b, 11, 12a, 13-15, 16b, 17a, 17b, 18- 40	503339	Recline Back Kit, Tall Height, 14-17" Width, Heavy Duty Gas Spring PAIR, Catalyst <i>Contains parts for complete retrofit</i>	1	\$1,207.93
1b, 2, 3a, 3b, 4c, 4d, 5-7, 8a, 8b, 9, 10a, 10b, 11, 12b, 13-15, 16b, 17a, 17b, 18- 40	503340	Recline Back Kit, Tall Height, 18-22" Width, Heavy Duty Gas Spring PAIR, Catalyst <i>Contains parts for complete retrofit</i>	1	\$1,207.93
1a, 5, 7, 8b, 9, 10a, 11, 24, 25, 39, 40	503327	Recline Back Tube Subassembly, Short 22", Right, Catalyst	1	\$149.34

Item Number	Part Number	Description	Quantity	Retail
1a, 5, 7, 8a, 9, 10b, 11, 24, 25, 39, 40	503328	Recline Back Tube Subassembly, Short 22", Left, Catalyst	1	\$149.34
1b, 5, 7, 8b, 9, 10a, 11, 24, 25, 39, 40	503329	Recline Back Tube Subassembly, Tall 26", Right, Catalyst	1	\$152.04
1b, 5, 7, 8a, 9, 10b, 11, 24, 25, 39, 40	503330	Recline Back Tube Subassembly, Tall 26", Left, Catalyst	1	\$152.04
9, 10a, 10b, 11, 12a, 30, 39, 40	503331	Recline Removable Stroller Handle Assembly 14 - 17W Catalyst <i>Kit includes parts for both sides</i>	1	\$127.56
9, 10a, 10b, 11, 12b, 30, 39, 40	503332	Recline Removable Stroller Handle Assembly 18 - 22W Catalyst <i>Kit includes parts for both sides</i>	1	\$127.56
2	003217	Backplate, Catalyst Recline, Outside	1	\$29.35
3a	003218	Backplate, Catalyst Recline, Inside Left	1	\$35.52
3b	003219	Backplate, Catalyst Recline, Inside Right	1	\$35.52
4a	001264	Gas Spring Lock 92mm 20kg, Left (Standard Weight Capacity)	1	\$159.80
4b	001265	Gas Spring Lock 92mm 20kg, Right (Standard Weight Capacity)	1	\$159.80
4c	001375	Gas Spring Lock 92mm 40kg, Left (Heavy Duty)	1	\$159.80
4d	001376	Gas Spring Lock 92mm 40kg, Right (Heavy Duty)	1	\$159.80
6	001267	Plug, Back Tube, Lower, Recline	1	\$2.31
9	003222	Recline Stroller Handle Adaptor	1	\$16.67
10a, 11	501090	Stroller Handle with Foam Grip, Right	1	\$53.73
10b, 11	501091	Stroller Handle with Foam Grip, Left	1	\$53.73
12a	002578	Growth Strut, Stroller, Short <i>Used on chair widths 14 - 17</i>	1	\$27.01
12b	002579	Growth Strut, Stroller, Long <i>Used on chair widths 18 - 22</i>	1	\$29.55
13	003638	Trigger Mount, No Lockout	1	\$3.31
14	001123	Trigger Horizontal	1	\$8.25
15	001124	Pin with Lanyard	1	\$19.85
16a	001268	Cable, Recline, Short	1	\$97.60
16b	001269	Cable, Recline, Long	1	\$99.16

Item Number	Part Number	Description	Quantity	Retail
17a	001298	Cover, Gas Spring, Left	1	\$4.17
17b	001299	Cover, Gas Spring, Right	1	\$4.17
18	003223	Recline Backplate Stop Pin	3	\$2.76
19	001271	1" Saddle, .323 Hole	2	\$1.70
20	000612	1" Half Saddle Washer	4	\$2.02
21	102081	Bushing Flange .319 IDx.394 OD	2	\$0.59
22	101861	Nylon Washer 5/16 x 1/2 x .03	2	\$0.56
23	101076	1/4" E Ring	1	\$1.66
26	101814	M8 x 25 BHCS Blk Zn	1	\$1.10
27	101592	M6 x 45 CLS10.9 DIN7991 FHCS BLKZC	2	\$2.76
28	100670	M6 x 45 BTN SHCS BLK ZC	3	\$1.66
29	101820	M5 x 22 HHCS Blk Zn	1	\$6.07
30	101843	M5 x 20 SHCS Blk Zn	1	\$0.56
31	100734	M5 x 16 PHMS ZC	1	\$1.66
32	102328	M4 x 25 Pan Head Phil Blk Zn	1	\$1.10
33	100659	M8 Nylock Nut Blk Zn	1	\$1.10
34	100658	M6 Nylock Nut Blk Zn	5	\$1.10
35	100657	M5 Nylock Nut Blk Zn	1	\$0.56
36	102329	M4 Nylock Nut Blk Zn	1	\$1.10
37	100746	M6 Flat Washer Blk Zn	3	\$1.66
38	001117	Cable Clip 1"	1	\$4.02
39	100669	M5 x 10 BTN SHCS BLKZC w/Patch	2	\$1.66
40	100533	Detent Button	1	\$3.77
41	110524	Locking Hinge Button Assembly with Instruction <i>This kit contains the contents inside callout # 7. This assembly may not be compatible if chair was invoiced prior to 6/22/16</i>	1	\$38.56