

Arc Caster Forks and Stems

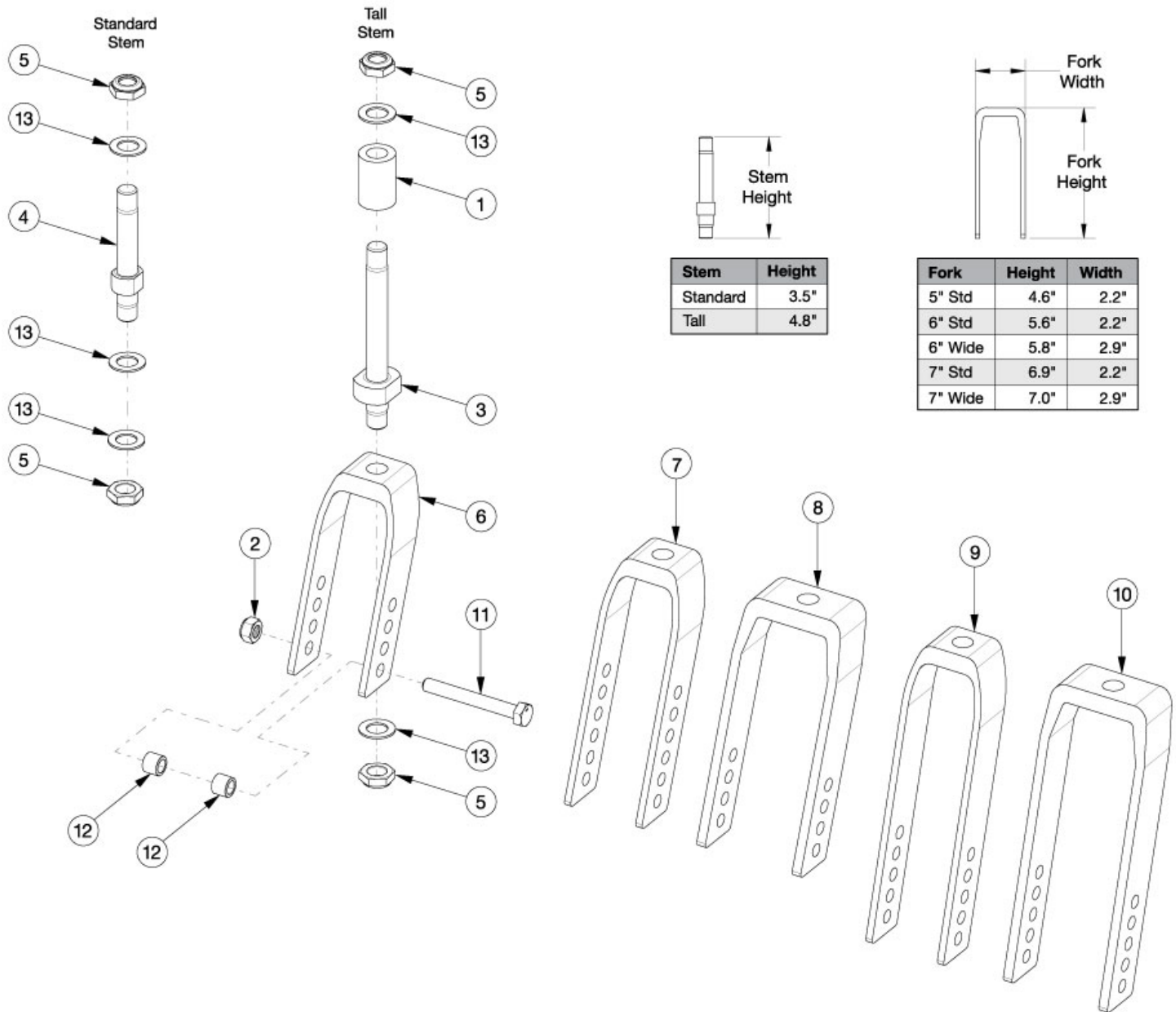

Stem	Height
Standard	3.5"
Tall	4.8"

Fork	Height	Width
5" Std	4.6"	2.2"
6" Std	5.6"	2.2"
6" Wide	5.8"	2.9"
7" Std	6.9"	2.2"
7" Wide	7.0"	2.9"

If changing to 2" casters, wide forks and hardware needed.

Item Number	Part Number	Description	Quantity
4-6, 13	113773	5" Fork Assembly, Standard Stem, Arc	1
4, 5, 7, 13	113774	6" Fork Assembly, Standard Stem, Arc	1
4, 5, 8, 13	113775	6" Wide Fork Assembly, Standard Stem, Arc <i>Used with 6 x 2" Poly caster</i>	1
4, 5, 9, 13	113776	7" Fork Assembly, Standard Stem, Arc	1

Item Number	Part Number	Description	Quantity
4, 5, 10, 13	113777	7" Wide Fork Assembly, Standard Stem, Arc <i>Used with 6 x 2" Poly caster</i>	1
1, 3, 5, 6, 13	113778	5" Fork Assembly, Tall Stem, Arc	1
1, 3, 5, 7, 13	113779	6" Fork Assembly, Tall Stem, Arc	1
1, 3, 5, 8, 13	113780	6" Wide Fork Assembly, Tall Stem, Arc <i>Used with 6 x 2" Poly caster</i>	1
1, 3, 5, 9, 13	113781	7" Fork Assembly, Tall Stem, Arc	1
1, 3, 5, 10, 13	113782	7" Wide Fork Assembly, Tall Stem, Arc <i>Used with 6 x 2" Poly caster</i>	1
1	002476	Spacer, 3/4" OD x 1/2" ID x 1.23	1
2	100659	M8 Nylock Nut Blk Zn	1
4, 5, 13	113783	Caster Stem, Standard, Arc	1
1, 3, 5, 13	113784	Caster Stem, Tall, Arc	1
5	100529	M12 x 1.25mm Lock Nut Black	2
5, 6	113785	5" Caster Fork, Arc	1
5, 7	113786	6" Caster Fork, Arc	1
5, 8	113787	6" Wide Caster Fork, Arc <i>Used with 6 x 2" Poly caster</i>	1
5, 9	113788	7" Caster Fork, Arc	1
5, 10	113789	7" Wide Caster Fork, Arc <i>Used with 6 x 2" Poly caster</i>	1
11a	101829	M8 x 65 HHCS Blk Zn	1
11b	101831	M8 x 80 HHCS Blk Zn <i>Used with 6 x 2" Poly caster</i>	1
12a	100792	Caster Spacer D8 x D12 x 10mm / Close Mount Handrim Spacer	2
12b	001246	Caster Spacer Black 6 x 2 Poly .472ODX.319IDX.370LG <i>Used with 6 x 2" Poly caster</i>	2
13	100682	Washer 1/2" .518 x .875 x .047 F/W Black Zinc	3
2, 11a, 12a	111379	Caster Attaching Hardware Kit <i>Used with all casters except the 6 x 2" Poly caster</i>	1
2, 11b, 12b	111380	Caster Attaching Hardware Kit for Wide Forks <i>Used with 6 x 2" Poly caster</i>	1