

## (Discontinued 2) Ethos / Rogue Height Adjustable Back Post with Adjustable Height Rigidizer Bar

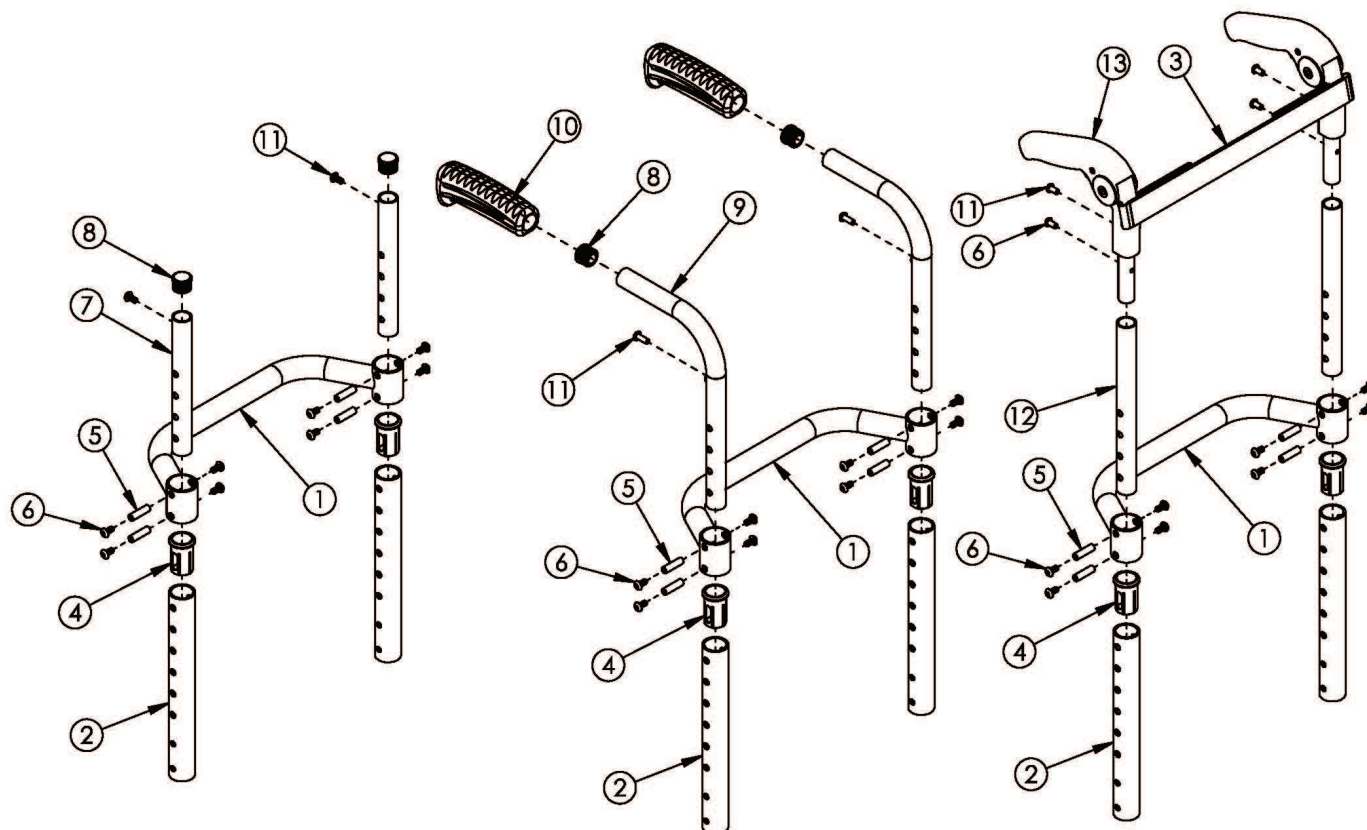

If chair was ordered with Rigid Locking Fold Down Back, please see Rigid Height Adjustable Back Post with Adjustable Height Rigidizer Bar page. Effective on Rogue starting with serial number RG0016612. If retrofitting to this backrest on Rogue, a new backrest mount and hardware may be required. Tension Straps (#3) are based on seat width and used in combination with back upholstery.

Item Number	Part Number	Description	Quantity
6, 11, 12a, 13	110359	Fold Down Push Handle Assembly, Height Adjustable, Short <i>Used with short back height range</i>	1
6, 11, 12b, 13	107211	Fold Down Push Handle Assembly, Height Adjustable, Medium <i>Used with medium back height range</i>	1
6, 11, 12c, 13	107212	Fold Down Push Handle Assembly, Height Adjustable, Tall <i>Used with tall back height range</i>	1
8, 9a, 10a	502602	Standard Push Handle Assembly, Short <i>Used with short back height range</i>	2
8, 9b, 10a	107225	Standard Push Handle Assembly, Medium <i>Used with medium back height range</i>	2

Item Number	Part Number	Description	Quantity
8, 9c, 10a	107227	Standard Push Handle Assembly, Tall <i>Used with tall back height range</i>	2
8, 9d, 10b	107205	Low Profile Push Handle Assembly, Short <i>Used with short back height range</i>	2
8, 9e, 10b	107226	Low Profile Push Handle Assembly, Medium <i>Used with medium back height range</i>	2
8, 9f, 10b	107228	Low Profile Push Handle Assembly, Tall <i>Used with tall back height range</i>	2
1a	000527	Adjustable Height Rigidizer Bar 12" Wide	1
1b	000528	Adjustable Height Rigidizer Bar 13" Wide	1
1c	000185	Adjustable Height Rigidizer Bar 14" Wide	1
1d	000186	Adjustable Height Rigidizer Bar 15" Wide	1
1e	000187	Adjustable Height Rigidizer Bar 16" Wide	1
1f	000188	Adjustable Height Rigidizer Bar 17" Wide	1
1g	000189	Adjustable Height Rigidizer Bar 18" Wide	1
1h	000190	Adjustable Height Rigidizer Bar 19" Wide	1
1i	000191	Adjustable Height Rigidizer Bar 20" Wide	1
2a, 4	107246	Height Adjustable Back Post with Sleeve Short <i>Used with standard push handles, low push handles or omit push handles with a short height range</i>	1
2b, 4	107247	Height Adjustable Back Post with Sleeve Medium <i>Used with standard push handles, low push handles or omit push handles with a medium height range</i>	1
2c, 4	107248	Height Adjustable Back Post with Sleeve Tall <i>Used with standard push handles, low push handles or omit push handles with a tall height range</i>	1
2d, 4	110352	Height Adjustable Back Post for Fold Down Push Handle with Sleeve Short <i>Used with fold down push handles with a short height range</i>	1
2e, 4	110353	Height Adjustable Back Post for Fold Down Push Handle with Sleeve Medium <i>Used with fold down push handles with a medium height range</i>	1
2f, 4	110354	Height Adjustable Back Post for Fold Down Push Handle with Sleeve Tall <i>Used with fold down push handles with a tall height range</i>	1
3a	001749	Tension Strap Folding Handle 12-13 Wide	1
3b	001750	Tension Strap Folding Handle 14-15 Wide	1

Item Number	Part Number	Description	Quantity
3c	001751	Tension Strap Folding Handle 16-17 Wide	1
3d	001752	Tension Strap Folding Handle 18-19 Wide	1
3e	001753	Tension Strap Folding Handle 20-22 Wide	1
4	000034	Sleeve 3/4" x 1 1/2"	2
5	000073	M5 x 24 Threaded Barrel	4
6	100669	M5 x 10 BTN SHCS BLKZC w/Patch	8
7a, 8	502608	Straight Upper Back Tube 6.25" with Tube End Plug <i>Used with short back height range</i>	1
7b, 8	107209	Straight Upper Back Tube 9.5" with Tube End Plug <i>Used with medium or tall back height ranges</i>	1
8	100638	Tube End Plug 3/4"	2
10a	109432	Ergo Push Handle Grip 3/4" Standard with Instruction	1
10b	109430	Ergo Push Handle Grip 3/4" Low Profile with Instruction	1
11	100734	M5 x 16 PHMS ZC <i>Used to mount back upholstery and/or Fold Down Push Handle</i>	2
13	001735	Folding Handle Assembly Rigid <i>This is to replace an existing Fold Down Push Handle. If wanting to retrofit to the Fold Down Push Handle, order one of the following complete assemblies based on back height range: 110359, 107211 or 107212</i>	1