

101

New White Frame!

Rehab Shower/Commode Chair-Bath/Toilet Modular System

- Packages Now Available
- Stainless Steel Frame
- Height Adjustable
- Can be used as a Raised Toilet Seat
- Lightweight
- 350 lb. Weight Capacity
- Several New Seat Options Available

The 101 is unique in its design to accommodate perineal access from any of four directions. The cut-out portion of the seat can be placed over the toilet in the desired direction and the legs can be adjusted in height while maintaining a stable platform for seating.

With the 12 different seating options and large seating surface the 101 provides excellent support while the cut-out may offer some additional pressure relief. With these options, the customer can find the size, contour, and shape to fit a wide range of needs. It is lightweight, easy to move out of the way, and no tools are required for disassembling the legs for travel or for height adjustment. Easy to use, versatile, sturdy, and comfortable makes the 101 an outstanding bathroom aid.



FRAMES



PRT50000
18"Wx18"D
White Stainless
Steel Frame



Shown with
P61086 Seat



Shown with
P60725 Seat



Shown with
P61063 Seat

LEGS



PRT50001
Short Legs w/
Crutch Tips
(height seat range
from floor to bottom
frame-15.375"-18.375")



PRT50002
Short Legs w/
Suction Tips
(height seat range
from floor to bottom
frame-15.375"-18.375")



PRT50003
Long Legs w/
Crutch Tips
(height seat range
from floor to bottom
frame-18.375"-21.125")



PRT50004
Long Legs w/
Suction Tips
(height seat range
from floor to bottom
frame-18.375"-21.125")

Seat Opening
Measurements

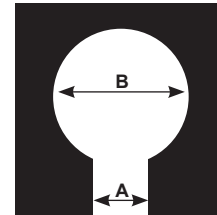

Oval Opening
Measurements

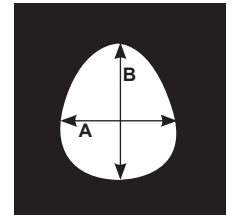

SEATS

*Seat works in all 4 positions



P60928*
16"Wx16"D
Ensolite® 1" foam
Front/Rear Open Seat
A-4"xB-6.5" opening



P60686*
16"Wx18"D
Ensolite® 2" foam
Front/Rear Open Seat
A-4.25"xB-7" opening



P60811*
16"Wx15.5"D
Ensolite® 2" waterfall foam
Front/Rear Open Seat
A-3.5"xB-6" opening



P60722*
18"Wx16"D
Ensolite® 2" foam
Front/Rear Open Seat
A-4.5"xB-7.5" opening



P60911*
18"Wx18"D
Ensolite® 1" foam
Front/Rear Open Seat
A-4.5"xB-7.5" opening



P60913*
18"Wx18"D
Ensolite® 2" waterfall foam
Front/Rear Open Seat
A-5.25"xB-8" opening



P60993*
18"Wx18"D
Comfortuff® 1.5" waterfall foam
Front/Rear Open Seat
A-5"xB-8" opening



P60850*
18"Wx18"D
Ensolite® 1" waterfall foam
Front/Rear Open Seat
A-5"xB-8" opening



P61063
18"Wx18"D
Ensolite® 2" foam
Front Open Contoured Seat
A-4.25"xB-7.5" opening



P61058
18"Wx18"D
Ensolite® 2" waterfall foam
Front Open Contoured Seat
A-5.5"xB-8.25" opening

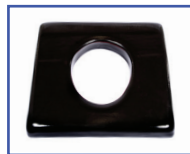

P60725
18"Wx16"D
Ensolite® 2" foam
Oval Seat
A-7.75"xB-9" opening



P61086
18"Wx18"D
Ensolite® 2" foam
Solid Seat

full option details at
activeaid.com

SPECIFICATIONS

Weight Capacity	350 lbs.
Height Adjustment Range from Floor to Bottom of Frame	
Short Legs	15.375"- 18.375"
Long Legs	18.375"-21.125"
Base Footprint-Short Legs	21.5"W x 23.25"D
Base Footprint-Long Legs	22.25"W x 24"D