

## (Discontinued 1) Rogue Style Fixed Height Back Post with Non-Adjustable Height Rigidizer Bar on Rogue ALX (Formerly Tsunami)

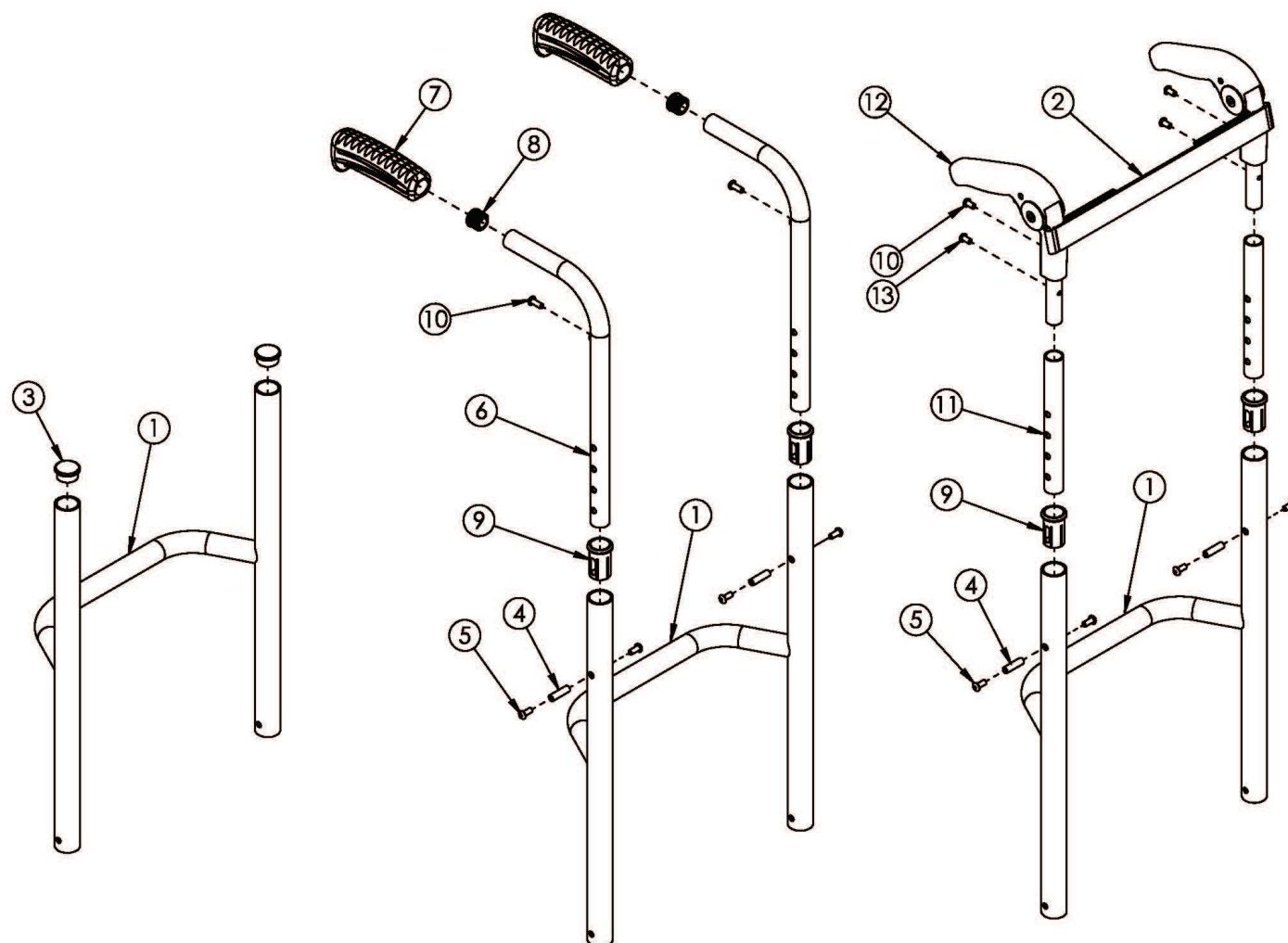

*This Rogue Style Backrest is not available with the Tsunami Heavy Duty option. If retrofitting to this backrest style, a minimum 1" of adjustable depth is required in addition to the Rogue Style Locking Backrest Mount and Hardware.*

| Item Number | Part Number | Description   | Quantity |
|-------------|-------------|---|----------|
| 1a          | 108760      | Fixed Height Rigid Backrest 5", 14" Wide<br><i>Used with 9" back height with standard or low profile push handles</i>   | 1        |
| 1b          | 108762      | Fixed Height Rigid Backrest 6", 14" Wide<br><i>Used with 10" back height with standard or low profile push handles or 12" back height with fold down push handles</i> | 1        |
| 1c          | 108764      | Fixed Height Rigid Backrest 7", 14" Wide  | 1        |

| Item Number | Part Number | Description  | Quantity |
|-------------|-------------|--|----------|
|             |             | <i>Used with 9" back height with omit push handles, 11" back height with standard or low profile push handles or 13" back height with fold down push handles</i>   |          |
| 1d          | 108766      | Fixed Height Rigid Backrest 8", 14" Wide<br><i>Used with 10" back height with omit push handles, 12" back height with standard or low profile push handles or 14" back height with fold down push handles</i>  | 1        |
| 1e          | 108768      | Fixed Height Rigid Backrest 9", 14" Wide<br><i>Used with 11" back height with omit push handles, 13" back height with standard or low profile push handles or 15" back height with fold down push handles</i>  | 1        |
| 1f          | 108770      | Fixed Height Rigid Backrest 10", 14" Wide<br><i>Used with 12" back height with omit push handles, 14" back height with standard or low profile push handles or 16" back height with fold down push handles</i> | 1        |
| 1g          | 108772      | Fixed Height Rigid Backrest 11", 14" Wide<br><i>Used with 13" back height with omit push handles, 15" back height with standard or low profile push handles or 17" back height with fold down push handles</i> | 1        |
| 1h          | 108774      | Fixed Height Rigid Backrest 12", 14" Wide<br><i>Used with 14" back height with omit push handles, 16" back height with standard or low profile push handles or 18" back height with fold down push handles</i> | 1        |
| 1i          | 108775      | Fixed Height Rigid Backrest 13", 14" Wide<br><i>Used with 15" back height with omit push handles or 17" back height with standard or low profile push handles</i>  | 1        |
| 1j          | 108776      | Fixed Height Rigid Backrest 14", 14" Wide<br><i>Used with 16" back height with omit push handles or 18" back height with standard or low profile push handles</i>  | 1        |
| 1k          | 108777      | Fixed Height Rigid Backrest 15", 14" Wide<br><i>Used with 17" back height with omit push handles</i>   | 1        |
| 1l          | 108778      | Fixed Height Rigid Backrest 16", 14" Wide<br><i>Used with 18" back height with omit push handles</i>   | 1        |
| 1m          | 108779      | Fixed Height Rigid Backrest 5", 15" Wide<br><i>Used with 9" back height with standard or low profile push handles</i>  | 1        |
| 1n          | 108781      | Fixed Height Rigid Backrest 6", 15" Wide<br><i>Used with 10" back height with standard or low profile push handles or 12" back height with fold down push handles</i>  | 1        |
| 1o          | 108783      | Fixed Height Rigid Backrest 7", 15" Wide<br><i>Used with 9" back height with omit push handles, 11" back height with standard or low profile push handles or 13" back height with fold down push handles</i>   | 1        |
| 1p          | 108785      | Fixed Height Rigid Backrest 8", 15" Wide<br><i>Used with 10" back height with omit push handles, 12" back height with standard or low profile push handles or 14" back height with fold down push handles</i>  | 1        |

| Item Number | Part Number | Description  | Quantity |
|-------------|-------------|--|----------|
| 1q          | 108787      | Fixed Height Rigid Backrest 9", 15" Wide<br><i>Used with 11" back height with omit push handles, 13" back height with standard or low profile push handles or 15" back height with fold down push handles</i>  | 1        |
| 1r          | 108789      | Fixed Height Rigid Backrest 10", 15" Wide<br><i>Used with 12" back height with omit push handles, 14" back height with standard or low profile push handles or 16" back height with fold down push handles</i> | 1        |
| 1s          | 108791      | Fixed Height Rigid Backrest 11", 15" Wide<br><i>Used with 13" back height with omit push handles, 15" back height with standard or low profile push handles or 17" back height with fold down push handles</i> | 1        |
| 1t          | 108793      | Fixed Height Rigid Backrest 12", 15" Wide<br><i>Used with 14" back height with omit push handles, 16" back height with standard or low profile push handles or 18" back height with fold down push handles</i> | 1        |
| 1u          | 108794      | Fixed Height Rigid Backrest 13", 15" Wide<br><i>Used with 15" back height with omit push handles or 17" back height with standard or low profile push handles</i>  | 1        |
| 1v          | 108795      | Fixed Height Rigid Backrest 14", 15" Wide<br><i>Used with 16" back height with omit push handles or 18" back height with standard or low profile push handles</i>  | 1        |
| 1w          | 108796      | Fixed Height Rigid Backrest 15", 15" Wide<br><i>Used with 17" back height with omit push handles</i>   | 1        |
| 1x          | 108797      | Fixed Height Rigid Backrest 16", 15" Wide<br><i>Used with 18" back height with omit push handles</i>   | 1        |
| 1y          | 108798      | Fixed Height Rigid Backrest 5", 16" Wide<br><i>Used with 9" back height with standard or low profile push handles</i>  | 1        |
| 1z          | 108800      | Fixed Height Rigid Backrest 6", 16" Wide<br><i>Used with 10" back height with standard or low profile push handles or 12" back height with fold down push handles</i>  | 1        |
| 1aa         | 108802      | Fixed Height Rigid Backrest 7", 16" Wide<br><i>Used with 9" back height with omit push handles, 11" back height with standard or low profile push handles or 13" back height with fold down push handles</i>   | 1        |
| 1ab         | 108804      | Fixed Height Rigid Backrest 8", 16" Wide<br><i>Used with 10" back height with omit push handles, 12" back height with standard or low profile push handles or 14" back height with fold down push handles</i>  | 1        |
| 1ac         | 108806      | Fixed Height Rigid Backrest 9", 16" Wide<br><i>Used with 11" back height with omit push handles, 13" back height with standard or low profile push handles or 15" back height with fold down push handles</i>  | 1        |
| 1ad         | 108808      | Fixed Height Rigid Backrest 10", 16" Wide  | 1        |

| Item Number | Part Number | Description  | Quantity |
|-------------|-------------|--|----------|
|             |             | <i>Used with 12" back height with omit push handles, 14" back height with standard or low profile push handles or 16" back height with fold down push handles</i>  |          |
| 1ae         | 108810      | Fixed Height Rigid Backrest 11", 16" Wide<br><i>Used with 13" back height with omit push handles, 15" back height with standard or low profile push handles or 17" back height with fold down push handles</i> | 1        |
| 1af         | 108812      | Fixed Height Rigid Backrest 12", 16" Wide<br><i>Used with 14" back height with omit push handles, 16" back height with standard or low profile push handles or 18" back height with fold down push handles</i> | 1        |
| 1ag         | 108813      | Fixed Height Rigid Backrest 13", 16" Wide<br><i>Used with 15" back height with omit push handles or 17" back height with standard or low profile push handles</i>  | 1        |
| 1ah         | 108814      | Fixed Height Rigid Backrest 14", 16" Wide<br><i>Used with 16" back height with omit push handles or 18" back height with standard or low profile push handles</i>  | 1        |
| 1ai         | 108815      | Fixed Height Rigid Backrest 15", 16" Wide<br><i>Used with 17" back height with omit push handles</i>   | 1        |
| 1aj         | 108816      | Fixed Height Rigid Backrest 16", 16" Wide<br><i>Used with 18" back height with omit push handles</i>   | 1        |
| 1ak         | 108817      | Fixed Height Rigid Backrest 5", 17" Wide<br><i>Used with 9" back height with standard or low profile push handles</i>  | 1        |
| 1al         | 108819      | Fixed Height Rigid Backrest 6", 17" Wide<br><i>Used with 10" back height with standard or low profile push handles or 12" back height with fold down push handles</i>  | 1        |
| 1am         | 108821      | Fixed Height Rigid Backrest 7", 17" Wide<br><i>Used with 9" back height with omit push handles, 11" back height with standard or low profile push handles or 13" back height with fold down push handles</i>   | 1        |
| 1an         | 108823      | Fixed Height Rigid Backrest 8", 17" Wide<br><i>Used with 10" back height with omit push handles, 12" back height with standard or low profile push handles or 14" back height with fold down push handles</i>  | 1        |
| 1ao         | 108825      | Fixed Height Rigid Backrest 9", 17" Wide<br><i>Used with 11" back height with omit push handles, 13" back height with standard or low profile push handles or 15" back height with fold down push handles</i>  | 1        |
| 1ap         | 108827      | Fixed Height Rigid Backrest 10", 17" Wide<br><i>Used with 12" back height with omit push handles, 14" back height with standard or low profile push handles or 16" back height with fold down push handles</i> | 1        |
| 1aq         | 108829      | Fixed Height Rigid Backrest 11", 17" Wide<br><i>Used with 13" back height with omit push handles, 15" back height with standard or low profile push handles or 17" back height with fold down push handles</i> | 1        |

| Item Number | Part Number | Description  | Quantity |
|-------------|-------------|--|----------|
| 1ar         | 108831      | Fixed Height Rigid Backrest 12", 17" Wide<br><i>Used with 14" back height with omit push handles, 16" back height with standard or low profile push handles or 18" back height with fold down push handles</i> | 1        |
| 1as         | 108832      | Fixed Height Rigid Backrest 13", 17" Wide<br><i>Used with 15" back height with omit push handles or 17" back height with standard or low profile push handles</i>  | 1        |
| 1at         | 108833      | Fixed Height Rigid Backrest 14", 17" Wide<br><i>Used with 16" back height with omit push handles or 18" back height with standard or low profile push handles</i>  | 1        |
| 1au         | 108834      | Fixed Height Rigid Backrest 15", 17" Wide<br><i>Used with 17" back height with omit push handles</i>   | 1        |
| 1av         | 108835      | Fixed Height Rigid Backrest 16", 17" Wide<br><i>Used with 18" back height with omit push handles</i>   | 1        |
| 1aw         | 108836      | Fixed Height Rigid Backrest 5", 18" Wide<br><i>Used with 9" back height with standard or low profile push handles</i>  | 1        |
| 1ax         | 108838      | Fixed Height Rigid Backrest 6", 18" Wide<br><i>Used with 10" back height with standard or low profile push handles or 12" back height with fold down push handles</i>  | 1        |
| 1ay         | 108840      | Fixed Height Rigid Backrest 7", 18" Wide<br><i>Used with 9" back height with omit push handles, 11" back height with standard or low profile push handles or 13" back height with fold down push handles</i>   | 1        |
| 1az         | 108842      | Fixed Height Rigid Backrest 8", 18" Wide<br><i>Used with 10" back height with omit push handles, 12" back height with standard or low profile push handles or 14" back height with fold down push handles</i>  | 1        |
| 1ba         | 108844      | Fixed Height Rigid Backrest 9", 18" Wide<br><i>Used with 11" back height with omit push handles, 13" back height with standard or low profile push handles or 15" back height with fold down push handles</i>  | 1        |
| 1bb         | 108846      | Fixed Height Rigid Backrest 10", 18" Wide<br><i>Used with 12" back height with omit push handles, 14" back height with standard or low profile push handles or 16" back height with fold down push handles</i> | 1        |
| 1bc         | 108848      | Fixed Height Rigid Backrest 11", 18" Wide<br><i>Used with 13" back height with omit push handles, 15" back height with standard or low profile push handles or 17" back height with fold down push handles</i> | 1        |
| 1bd         | 108850      | Fixed Height Rigid Backrest 12", 18" Wide<br><i>Used with 14" back height with omit push handles, 16" back height with standard or low profile push handles or 18" back height with fold down push handles</i> | 1        |
| 1be         | 108851      | Fixed Height Rigid Backrest 13", 18" Wide  | 1        |

| Item Number | Part Number | Description  | Quantity |
|-------------|-------------|--|----------|
|             |             | <i>Used with 15" back height with omit push handles or 17" back height with standard or low profile push handles</i>   |          |
| 1bf         | 108852      | Fixed Height Rigid Backrest 14", 18" Wide<br><i>Used with 16" back height with omit push handles or 18" back height with standard or low profile push handles</i>  | 1        |
| 1bg         | 108853      | Fixed Height Rigid Backrest 15", 18" Wide<br><i>Used with 17" back height with omit push handles</i>   | 1        |
| 1bh         | 108854      | Fixed Height Rigid Backrest 16", 18" Wide<br><i>Used with 18" back height with omit push handles</i>   | 1        |
| 1bi         | 108855      | Fixed Height Rigid Backrest 5", 19" Wide<br><i>Used with 9" back height with standard or low profile push handles</i>  | 1        |
| 1bj         | 108857      | Fixed Height Rigid Backrest 6", 19" Wide<br><i>Used with 10" back height with standard or low profile push handles or 12" back height with fold down push handles</i>  | 1        |
| 1bk         | 108859      | Fixed Height Rigid Backrest 7", 19" Wide<br><i>Used with 9" back height with omit push handles, 11" back height with standard or low profile push handles or 13" back height with fold down push handles</i>   | 1        |
| 1bl         | 108861      | Fixed Height Rigid Backrest 8", 19" Wide<br><i>Used with 10" back height with omit push handles, 12" back height with standard or low profile push handles or 14" back height with fold down push handles</i>  | 1        |
| 1bm         | 108863      | Fixed Height Rigid Backrest 9", 19" Wide<br><i>Used with 11" back height with omit push handles, 13" back height with standard or low profile push handles or 15" back height with fold down push handles</i>  | 1        |
| 1bn         | 108865      | Fixed Height Rigid Backrest 10", 19" Wide<br><i>Used with 12" back height with omit push handles, 14" back height with standard or low profile push handles or 16" back height with fold down push handles</i> | 1        |
| 1bo         | 108867      | Fixed Height Rigid Backrest 11", 19" Wide<br><i>Used with 13" back height with omit push handles, 15" back height with standard or low profile push handles or 17" back height with fold down push handles</i> | 1        |
| 1bp         | 108869      | Fixed Height Rigid Backrest 12", 19" Wide<br><i>Used with 14" back height with omit push handles, 16" back height with standard or low profile push handles or 18" back height with fold down push handles</i> | 1        |
| 1bq         | 108870      | Fixed Height Rigid Backrest 13", 19" Wide<br><i>Used with 15" back height with omit push handles or 17" back height with standard or low profile push handles</i>  | 1        |
| 1br         | 108871      | Fixed Height Rigid Backrest 14", 19" Wide<br><i>Used with 16" back height with omit push handles or 18" back height with standard or low profile push handles</i>  | 1        |
| 1bs         | 108872      | Fixed Height Rigid Backrest 15", 19" Wide  | 1        |

| Item Number | Part Number | Description  | Quantity |
|-------------|-------------|--|----------|
|             |             | <i>Used with 17" back height with omit push handles</i>  |          |
| 1bt         | 108873      | Fixed Height Rigid Backrest 16", 19" Wide<br><i>Used with 18" back height with omit push handles</i>   | 1        |
| 1bu         | 108874      | Fixed Height Rigid Backrest 5", 20" Wide<br><i>Used with 9" back height with standard or low profile push handles</i>  | 1        |
| 1bv         | 108876      | Fixed Height Rigid Backrest 6", 20" Wide<br><i>Used with 10" back height with standard or low profile push handles or 12" back height with fold down push handles</i>  | 1        |
| 1bw         | 108878      | Fixed Height Rigid Backrest 7", 20" Wide<br><i>Used with 9" back height with omit push handles, 11" back height with standard or low profile push handles or 13" back height with fold down push handles</i>   | 1        |
| 1bx         | 108880      | Fixed Height Rigid Backrest 8", 20" Wide<br><i>Used with 10" back height with omit push handles, 12" back height with standard or low profile push handles or 14" back height with fold down push handles</i>  | 1        |
| 1by         | 108882      | Fixed Height Rigid Backrest 9", 20" Wide<br><i>Used with 11" back height with omit push handles, 13" back height with standard or low profile push handles or 15" back height with fold down push handles</i>  | 1        |
| 1bz         | 108884      | Fixed Height Rigid Backrest 10", 20" Wide<br><i>Used with 12" back height with omit push handles, 14" back height with standard or low profile push handles or 16" back height with fold down push handles</i> | 1        |
| 1ca         | 108886      | Fixed Height Rigid Backrest 11", 20" Wide<br><i>Used with 13" back height with omit push handles, 15" back height with standard or low profile push handles or 17" back height with fold down push handles</i> | 1        |
| 1cb         | 108888      | Fixed Height Rigid Backrest 12", 20" Wide<br><i>Used with 14" back height with omit push handles, 16" back height with standard or low profile push handles or 18" back height with fold down push handles</i> | 1        |
| 1cc         | 108889      | Fixed Height Rigid Backrest 13", 20" Wide<br><i>Used with 15" back height with omit push handles or 17" back height with standard or low profile push handles</i>  | 1        |
| 1cd         | 108890      | Fixed Height Rigid Backrest 14", 20" Wide<br><i>Used with 16" back height with omit push handles or 18" back height with standard or low profile push handles</i>  | 1        |
| 1ce         | 108891      | Fixed Height Rigid Backrest 15", 20" Wide<br><i>Used with 17" back height with omit push handles</i>   | 1        |
| 1cf         | 108892      | Fixed Height Rigid Backrest 16", 20" Wide<br><i>Used with 18" back height with omit push handles</i>   | 1        |
| 2a          | 001750      | Tension Strap Folding Handle 14-15 Wide  | 1        |

| Item Number     | Part Number | Description  | Quantity |
|-----------------|-------------|--|----------|
| 2b              | 001751      | Tension Strap Folding Handle 16-17 Wide  | 1        |
| 2c              | 001752      | Tension Strap Folding Handle 18-19 Wide  | 1        |
| 2d              | 001753      | Tension Strap Folding Handle 20-22 Wide  | 1        |
| 3               | 100804      | Tube End Plug 1"   | 2        |
| 4               | 000073      | M5 x 24 Threaded Barrel  | 2        |
| 5               | 100669      | M5 x 10 BTN SHCS BLKZC w/Patch   | 4        |
| 6, 7a, 8        | 502602      | Standard Push Handle Assembly, Short<br><i>Used with 9" - 18" back heights</i>   | 1        |
| 6, 7b, 8        | 107205      | Low Profile Push Handle Assembly, Short<br><i>Used with 9" - 18" back heights</i>  | 1        |
| 7a              | 109432      | Ergo Push Handle Grip 3/4" Standard with Instruction   | 1        |
| 7b              | 109430      | Ergo Push Handle Grip 3/4" Low Profile with Instruction  | 1        |
| 8               | 100638      | Tube End Plug 3/4"   | 1        |
| 9               | 000034      | Sleeve 3/4" x 1 1/2"   | 2        |
| 10              | 100734      | M5 x 16 PHMS ZC<br><i>Used to mount back upholstery and/or Fold Down Push Handle</i>   | 2        |
| 10, 11a, 12, 13 | 110529      | Fold Down Push Handle Assembly, Fixed, 12" Back Height<br><i>Used with 12" back height</i>   | 1        |
| 10, 11b, 12, 13 | 110530      | Fold Down Push Handle Assembly, Fixed, 13-18" Back Height<br><i>Used with 13" - 18" back heights</i>   | 1        |
| 12              | 001735      | Folding Handle Assembly Rigid<br><br><i>This is to replace an existing Fold Down Push Handle. If wanting to retrofit to the Fold Down Push Handle, order one of the following complete assemblies based on the desired back height: 110529 or 110530</i> | 1        |