



2842 Business Park Avenue
 Fresno, California 93727-1328
 (209) 292-2171 • (800) 456-8168

INSTRUCTION SHEET

Quick-Release Backrest Assembly

(Quickie GPSA/GPV/Ti/Triumph/Carbon/Shadow 3D)

Quick-Release Backrest Assembly Key

1. Eccentric cap screw
2. Eccentric washer
3. Side plate
4. Saddle
5. Latch spring
6. Latch
7. Latch bushing
8. Nylock nut
9. Nylock half nut
10. Latch cord
11. Latch cord adjuster
12. Lower cap screw
13. Flat washer
14. Back Frame
15. Pivot cap screw
16. Flat washer
17. Saddle
18. Nylock nut
19. 3/4" cap screw
20. Wave washer
21. Internal nut
22. Height adjustable post

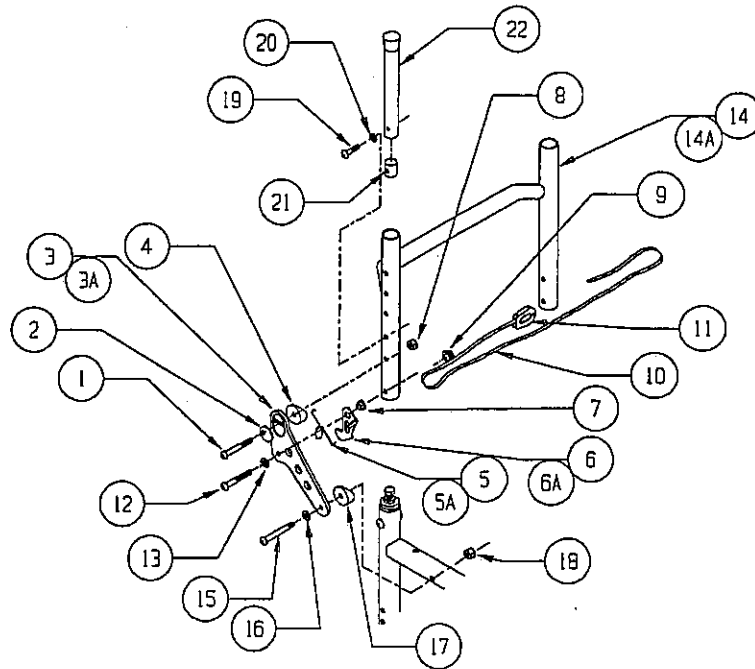

BACKFRM

The back frame assembly will come with items 1-13 assembled to the back frame, item 14. Also included with the back frame will be 2 sets of items 15-18.

1. Mounting back frame assembly to wheelchair.

- a. Remove old back frame assembly from wheelchair including 2 (two) sets of the vertical post (22), internal nut (21), 3/4" long screw (19), and wave washer (20). Retain items 19-22 for reuse with the new back frame.
- b. Remove 2 (two) sets of hardware (15-18) from the new back frame assembly.
- c. Install back frame assembly (1-14) to wheelchair by positioning saddles (17) over seat frame rails and installing cap screws (15) through flat washers (16), side plates (3, 3A), saddles (17), and wheelchair seat frame rails. Tighten nuts (18) onto cap screws (15) securely. (Back frame assembly must be able to pivot on cap screws (15)).

2. Height adjustment of back frame posts in the top four positions.

- a. Make sure the internal nut (21) is located in the end of the height adjustment post (22) so that the threaded hole in the internal nut (21) is aligned with the through hole in the post (22).
- b. Insert the post (22) and internal nut (21) down into the vertical members of the back frame (14). Locate the through hole in the post (22) concentric with one of the top four holes in the back frame (14).
- c. Install the 3/4" long screw (19) through the wave washer (20) and the back frame (14) hole into the internal nut (21) in the height adjustment post (22). Tighten securely (7 ft-lb). Repeat this procedure for the opposite side of the back frame (14) making sure that the tops of the height adjustment posts (22) are the same distance from the seating surface.

FOR DEALER USE Installed by: _____ Date: _____ (retain as record of installation)

3. Height adjustment of back frame posts in the lowest position.

- a. Remove the internal nuts (21) from the end of the height adjustment posts (22). Retain the internal nuts (21), 3/4" long screws (19), and wave washers (20) for possible future use.
- b. On one side of the back frame at a time, remove nut (8) from cap screw (1) and withdraw cap screw (1) from eccentric washer (2), side plate (3,3A), saddle (4), and the back frame (14).
- c. Lower the height adjustment post (22) until the hole in the bottom of the post (22) is concentric with the hole in the back frame (14) from which the cap screw (1) was withdrawn.
- d. Reinstall the cap screw (1) through the eccentric washer (2), the side plate (3, 3A), the saddle (4), and the back frame (14). Ensure that the upper tail of the latch spring (5, 5A) is on the back side of the saddle (4). Tighten nut (8) securely (7 ft-lb) onto the cap screw (1).
- e. Repeat this procedure for the remaining side of the back frame (14), ensuring that the eccentric washers (2) are in the same orientation in both side plates (3, 3A). This will ensure that the correct back frame to seat frame angle is maintained.

FOR DEALER USE Installed by: _____ Date: _____ (retain as record of installation)