

Rogue and Little Wave Camber Mount

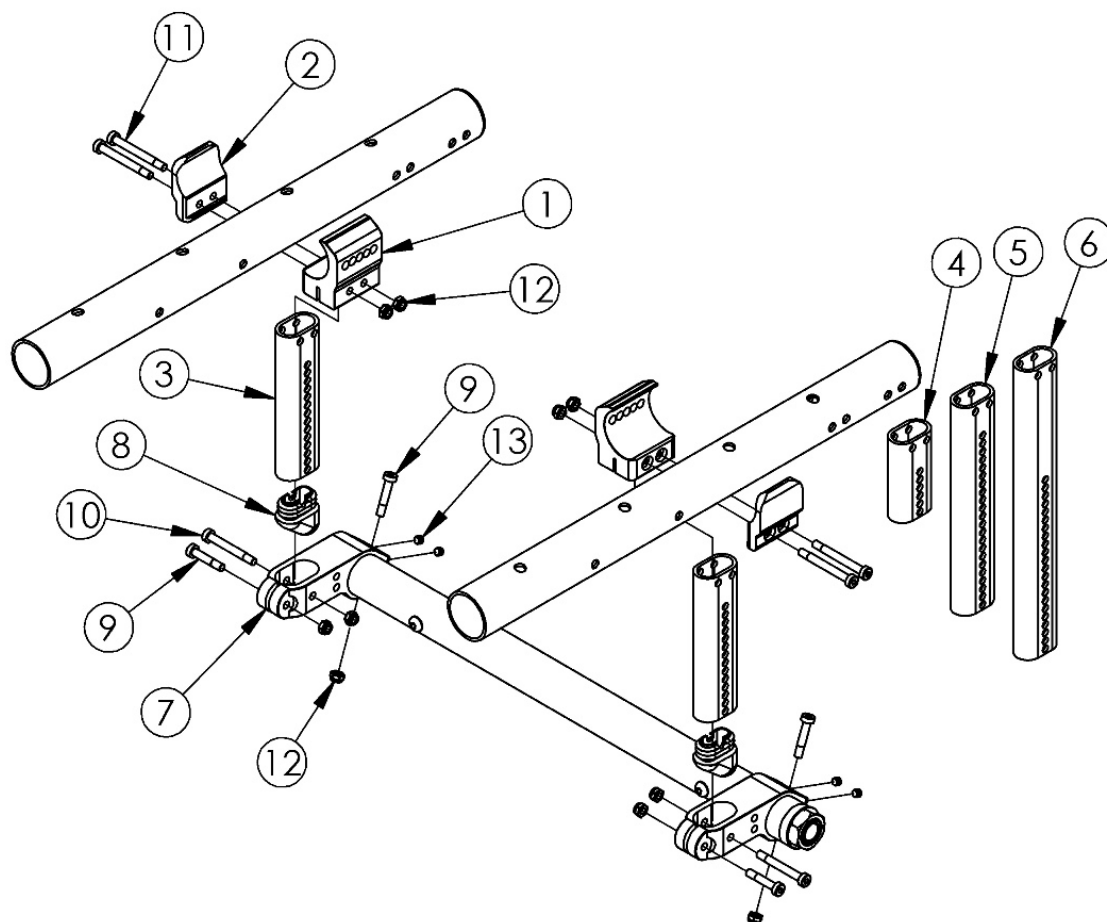

Replacement Camber Mount Towers may be quoted, but must be ordered through Customer Service <p>

If Little Wave XP was invoiced prior to June 2013, Standard or MX index or sliding towers may be present.

Item Number	Part Number	Description	Quantity	Retail
1, 2a, 11a, 12	503289	Camber Tower Clamp Black Anodized w/ Hardware Assembly, One Side RG/LW	1	\$64.07
1, 2b, 11a, 12	503289_ _ _	Color Anodized Camber Tower Clamp w/ Hardware Assembly, One Side RG/LW	1	\$85.89
7a, 9, 10, 12, 13	503290	Camber Tower Mount Black Anodized w/ Hardware Assembly, One Side RG/LW	1	\$75.33
7b, 9, 10, 12, 13	503290_ _ _	Color Anodized Camber Tower Mount w/ Hardware Assembly, One Side RG/LW	1	\$84.26
1	000912	Inside Camber Mount Clamp Rigid	1	\$27.31
2a	000913	Outside Camber Mount Clamp Black Anodized Rigid	1	\$27.31

Item Number	Part Number	Description	Quantity	Retail
		<i>Used only on Rogue with positive CG or when a Wheelchair Drive Ready System is not present</i>		
2b	000913_ _ _	Color Anodized Outside Camber Mount Clamp Rigid <i>Used only on Rogue with positive CG or when a Wheelchair Drive Ready System is not present</i>	1	\$41.78
3a	000924	Camber Mount Tower Medium Black Anodized Rigid	1	\$27.31
3b	000924_ _ _	Color Anodized Camber Mount Tower Medium Rigid	1	\$41.78
4a	000923	Camber Mount Tower Short Black Anodized Rigid	1	\$27.31
4b	000923_ _ _	Color Anodized Camber Mount Tower Short Rigid	1	\$41.78
5a	000925	Camber Mount Tower Long Black Anodized Rigid	1	\$28.44
5b	000925_ _ _	Color Anodized Camber Mount Tower Long Rigid	1	\$42.92
6a	000926	Camber Mount Tower Extra Long Black Anodized Rigid	1	\$29.01
6b	000926_ _ _	Color Anodized Camber Mount Tower Extra Long Rigid	1	\$43.48
7a	001347	Camber Tower Mounting Clamp Rigid	1	\$63.25
7b	001347_ _ _	Color Anodized Camber Tower Mounting Clamp Rigid	1	\$72.18
8	000920	Camber Mount Cap Rigid	1	\$2.50
9	101717	M5 x 25 SHCS BLK ZC	2	\$0.53
10	101734	M5 x 35 SHCS BLK ZC	1	\$1.05
11a	101186	M5 X 45 CLS12.9 DIN912 SHCS P/THD BLZ <i>Used only on Rogue with positive CG or when a Wheelchair Drive Ready System is not present</i>	2	\$3.15
11b	003232	M6 x 55 BHCS Blk Zc <i>Used only on Rogue with negative CG or when a Wheelchair Drive Ready System is present</i>	2	\$8.94
12	100657	M5 Nylock Nut Blk Zn	5	\$0.53
13	105015	M5 X 6 DIN914 SSS CONE PT PLN <i>Used only on Little Wave or Rogue XP with 5th Wheel</i>	2	\$2.63

Color Anodizing Samples

