

Little Wave XP Offset Backrest

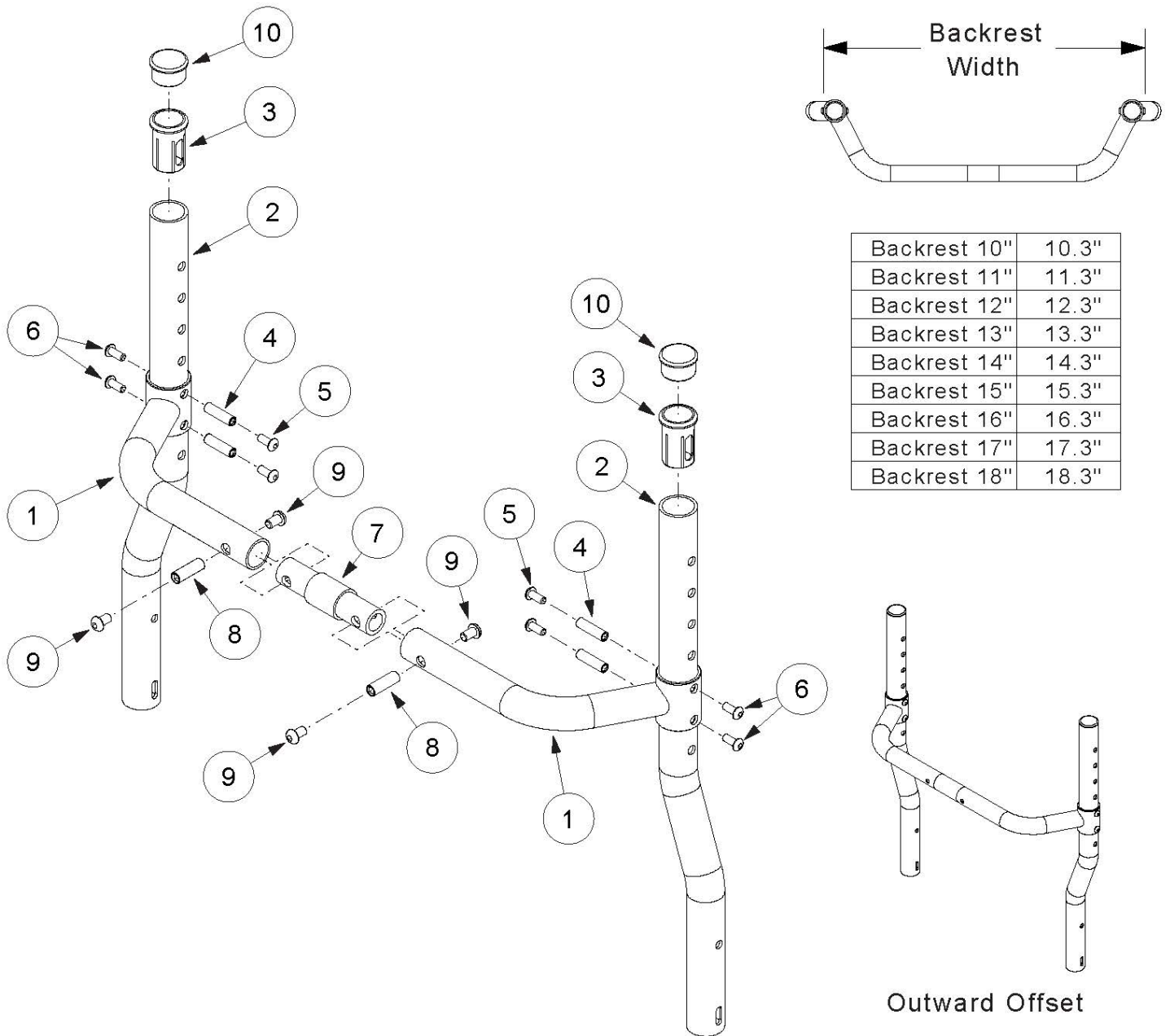

Backrest 10"	10.3"
Backrest 11"	11.3"
Backrest 12"	12.3"
Backrest 13"	13.3"
Backrest 14"	14.3"
Backrest 15"	15.3"
Backrest 16"	16.3"
Backrest 17"	17.3"
Backrest 18"	18.3"

Item Number	Part Number	Description	Quantity	Retail
7b, 8, 9	502318	Backrest Connector Assembly 1" w/ Hardware, Rigid	1	\$47.61
7c, 8, 9	502319	Backrest Connector Assembly 2" w/ Hardware, Rigid	1	\$47.61
7d, 8, 9	502320	Backrest Connector Assembly 3" w/ Hardware, Rigid	1	\$47.61
1a, 7a, 8, 9	109150	Adjustable Height Rigidizer Bar 10", 0" Connector and Hardware <i>Used with 12" seat width and Inward Offset</i>	1	\$130.28
1b, 7a, 8, 9	109154	Adjustable Height Rigidizer Bar 11", 0" Connector and Hardware	1	\$130.28

Item Number	Part Number	Description	Quantity	Retail
		<i>Used with 13" seat width and Inward Offset</i>		
1c, 7a, 8, 9	109158	Adjustable Height Rigidizer Bar 12", 0" Connector and Hardware <i>Used with 14" seat width and Inward Offset or 10" seat width and Outward Offset</i>	1	\$130.28
1d, 7a, 8, 9	109162	Adjustable Height Rigidizer Bar 13", 0" Connector and Hardware <i>Used with 15" seat width and Inward Offset or 11" seat width and Outward Offset</i>	1	\$130.28
1e, 7a, 8, 9	109166	Adjustable Height Rigidizer Bar 14", 0" Connector and Hardware <i>Used with 16" seat width and Inward Offset or 12" seat width and Outward Offset</i>	1	\$130.28
1f, 7a, 8, 9	109170	Adjustable Height Rigidizer Bar 15", 0" Connector and Hardware <i>Used with 17" seat width and Inward Offset or 13" seat width and Outward Offset</i>	1	\$130.28
1g, 7a, 8, 9	109174	Adjustable Height Rigidizer Bar 16", 0" Connector and Hardware <i>Used with 18" seat width and Inward Offset or 14" seat width and Outward Offset</i>	1	\$130.28
1h, 7a, 8, 9	109422	Adjustable Height Rigidizer Bar 17", 0" Connector and Hardware <i>Used with 19" seat width and Inward Offset or 15" seat width and Outward Offset</i>	1	\$130.28
1i, 7a, 8, 9	109426	Adjustable Height Rigidizer Bar 18", 0" Connector and Hardware <i>Used with 16" seat width and Outward Offset</i>	1	\$130.28
1i, 7b, 8, 9	109427	Adjustable Height Rigidizer Bar 18", 1" Connector and Hardware <i>Used with 17" seat width and Outward Offset</i>	1	\$130.28
1i, 7c, 8, 9	109428	Adjustable Height Rigidizer Bar 18", 2" Connector and Hardware <i>Used with 18" seat width and Outward Offset</i>	1	\$130.28
1i, 7d, 8, 9	109429	Adjustable Height Rigidizer Bar 18", 3" Connector and Hardware <i>Used with 19" seat width and Outward Offset</i>	1	\$130.28
2a	109120	1" Offset Backtube, 10" <i>Used with 11" back height with omit push handles</i>	2	\$66.91
2b	109119	1" Offset Backtube, 11" <i>Used with 12" back height with omit push handles and 15" back height with fold down push handles</i>	2	\$66.91
2c	109118	1" Offset Backtube, 12" <i>Used with 13" back height with omit push handles, 16" back height with fold down push handles and 15" back height with standard or low profile push handles</i>	2	\$66.91
2d	109117	1" Offset Backtube, 13" <i>Used with 14" back height with omit push handles, 17" back height with fold down push handle and 16" back height with standard or low profile push handles</i>	2	\$66.91
2e	109116	1" Offset Backtube, 14" <i>Used with 15" back height with omit push handles and 17" back height with standard or low profile push handles</i>	2	\$66.91

Item Number	Part Number	Description	Quantity	Retail
2f	109115	1" Offset Backtube, 15" <i>Used with 16" back height with omit push handles</i>	2	\$66.91
2g	001312	1" Offset Backtube, 16" <i>Used with 17" back height with omit push handles</i>	2	\$66.91
3	000034	Sleeve 3/4" x 1 1/2" <i>Used with standard push handles, low profile push handles and fold down push handles</i>	2	\$3.66
4	000073	M5 x 24 Threaded Barrel	4	\$3.78
5	100669	M5 x 10 BTN SHCS BLKZC w/Patch	4	\$1.58
6	103524	M5 x 10 BTN SHCS BLK ZN	4	\$0.53
7a	000589	Backrest Connector 0" LW/RG	1	\$33.05
7b	000590	Backrest Connector 1" LW/RG	1	\$33.05
7c	000591	Backrest Connector 2" LW/RG	1	\$33.05
7d	000592	Backrest Connector 3" LW/RG	1	\$33.05
8	000669	M6 x 20.5 Threaded Barrel	2	\$4.88
9	101184	M6 x 10 BTN SHCS BLKZC w/Patch	4	\$1.58
10	100804	Tube End Plug 1" <i>Used with omit push handles</i>	4	\$1.58