

Teach-in of your remote control to the e-motion wheels

- ▶ First insert the battery packs in the e-motion wheels before beginning with the teach-in of the remote control.

1. Switch off both wheels with the help of the On/Off switch on the wheel hub.

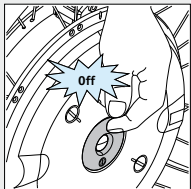

2. Switch on the remote control by pressing the Info button; all display elements will come on at this time for approx. 1 second.



3. At the same time, press the buttons [0] and [2] for approx. 5 seconds. A countdown running from 5 to 0 is then shown in the display.

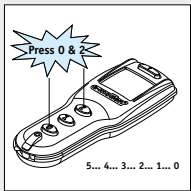

4. As soon as the countdown has reached 0, release the two buttons [0] and [2] only briefly and push them again for approximately 5 seconds. A countdown running from 4 to 0 is now shown in the display.

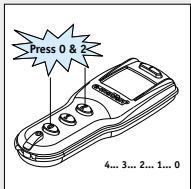

Teach-in of your remote control to the e-motion wheels

5. You can release the buttons as soon as the count-down has reached 0 and 5 flashing battery bars are shown at the right side of the display – the teach-in of the right drive wheel can now be performed.

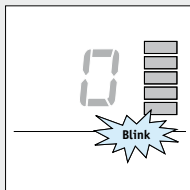

6. Switch on the right e-motion wheel – seen in the direction of travel – using the On/Off switch on the wheel hub.

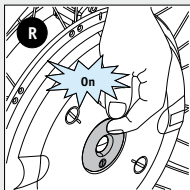

7. Now push button [1] on the remote control: The teach-in of the right wheel is now completed...



8. ...the left battery display now flashes – the teach-in of the left drive wheel can now be performed.

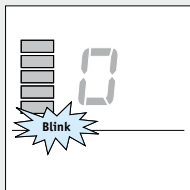

Teach-in of your remote control to the e-motion wheels

9. Now switch on the left **e-motion** wheel...

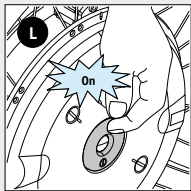

10. and then push button [1] again to complete the teach-in process.



11. **Done:** You can now use all functions of the ECS and your specialist dealer/therapist can program the drive characteristics to your needs.